

REVISIONS					
P	LTN	DESCRIPTION	DATE	DWN	APVD
D15		REVISED PER ECO-20-004256	25MAR2020	JM	DS
D16		REVISED PER PCN E-20-016603	24NOV2020	PN	DS
E		REVISED PER ECN-21-123056	08NOV2021	DK	CB
E1		REVISED PER ECR-24-216938	13SEP2024	DK	CB

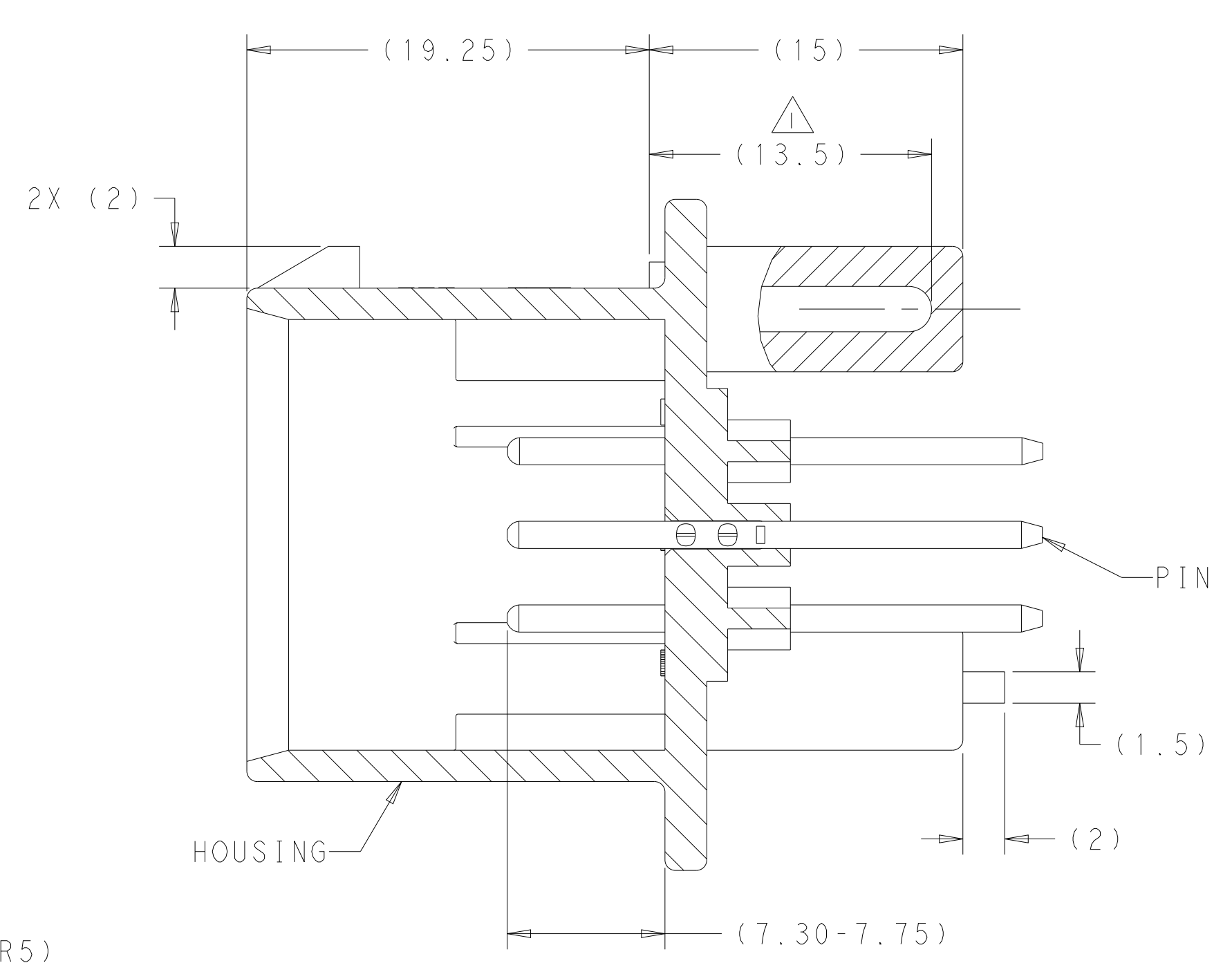
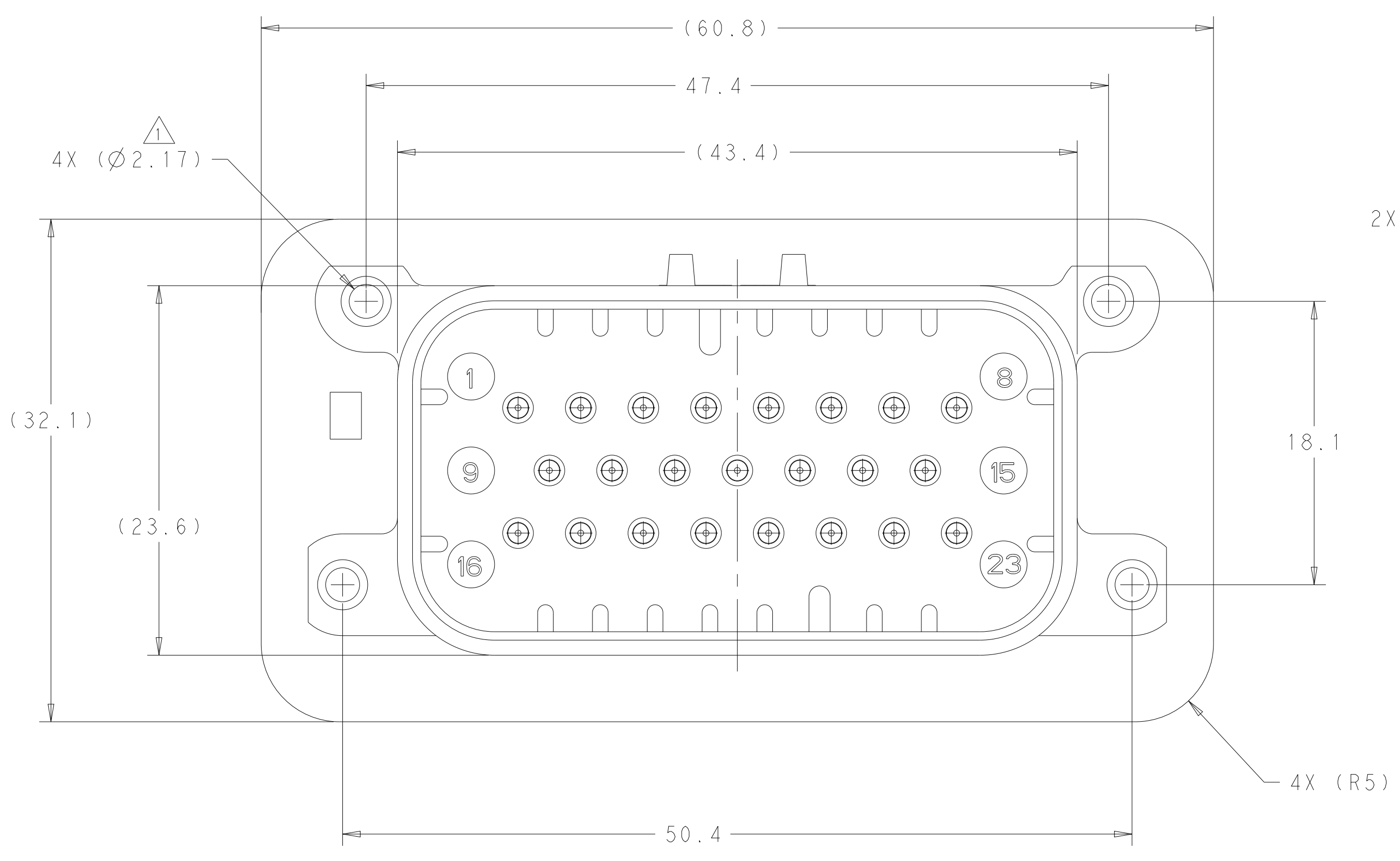

SECTION A-A

1 SUGGESTED MOUNTING SCREW SIZE IS  $\varnothing 2.50\text{mm}$  [APPROX. 0.099 INCH] SELF TAPPING THREAD FORMING SCREW, SUCH AS DELTA PT, TO BE DRIVEN AT 0.6-0.8 N-m. THE CUSTOMER MUST TEST THE SCREW SIZE AND TYPE IN ORDER TO VERIFY THEIR SELECTION BEFORE USE IN APPLICATION

TO VALIDATE HEADER MOUNTING PERFORMANCE, TE CONNECTIVITY WILL CONTINUE TO UTILIZE THE FOLLOWING TORQUE VALIDATION PROCESS ACCORDING TO APPLICATION SPEC 114-16016: MOUNTING PANEL THICKNESS - 4.75 +/- 0.15mm SCREW - 2.5X12mm DELTA PT

CUSTOMERS MAY VALIDATE OTHER SCREW SIZES AND TYPES AT THEIR OWN DISCRETION

2 DATE CODE IN THIS LOCATION USING 5 DIGIT CODE FIRST 2 DIGITS = YEAR, SECOND 2 DIGITS = WEEK LAST DIGIT = DAY.

3 MATERIALS: HEADER HOUSING - GLASS FILLED PBT PINS - TIN OR GOLD PLATED BRASS

4 HOUSING COLORS ARE MECHANICALLY KEYPED TO MATE ONLY WITH IDENTICALLY COLORED PLUG ASSEMBLIES.

5. HEADER MATES TO PLUG ASSEMBLY 770680 WHICH USES REELED TERMINAL 770520 OR LOOSE PIECE TERMINAL 770854

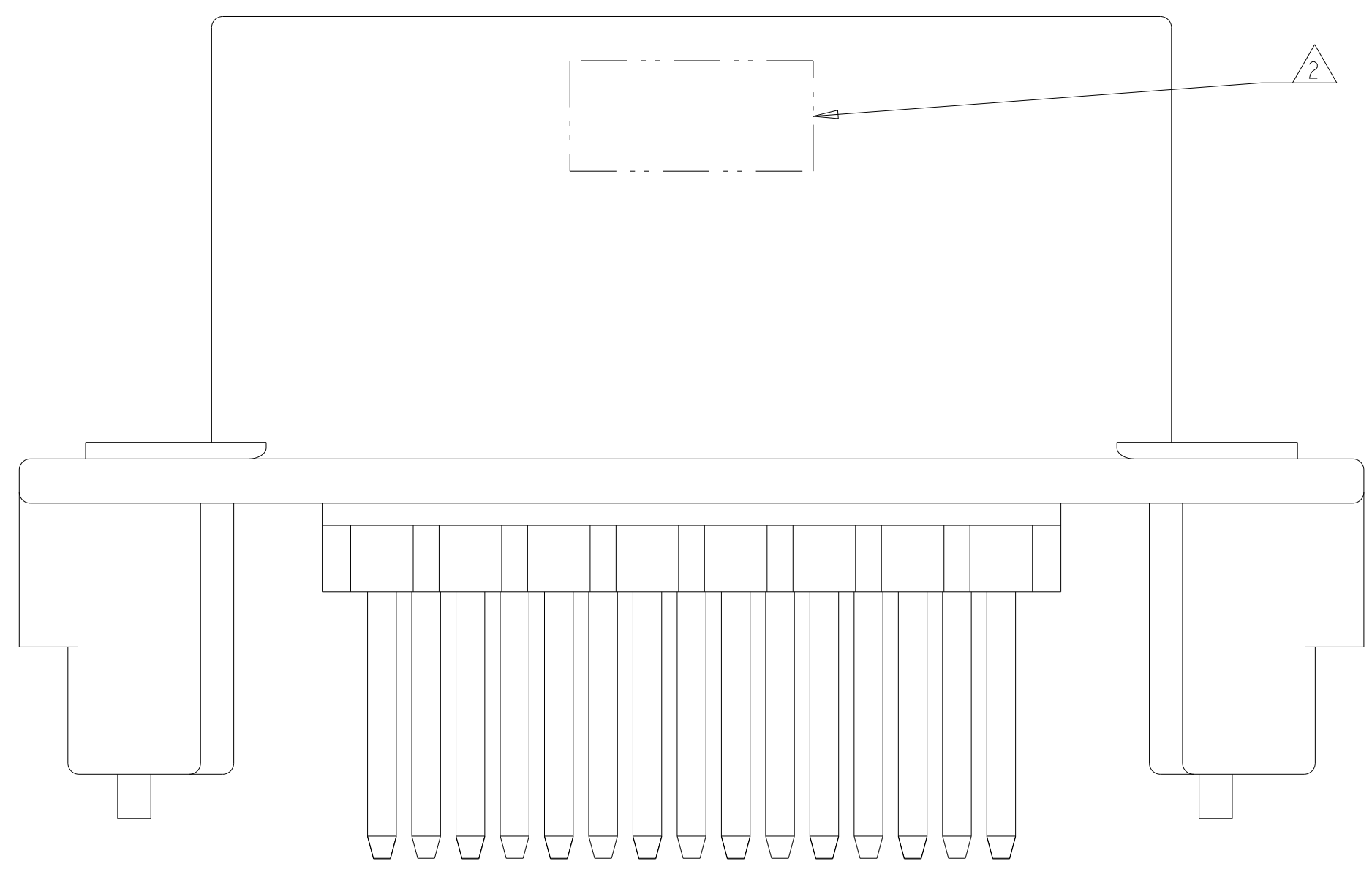

776200-1 & 1-776200-1 SHOWN

HEADER COLOR	PLATING	PART NUMBER
BLUE	GOLD	1-776200-5
GRAY	GOLD	1-776200-4
NATURAL	GOLD	1-776200-2
BLACK	GOLD	1-776200-1
BLUE	TIN	776200-5
GRAY	TIN	776200-4
NATURAL	TIN	776200-2
BLACK	TIN	776200-1

THIS DRAWING IS A CONTROLLED DOCUMENT.

OWN: D. STRAUSSER 04FEB2010  
 CHK: D. STRAUSSER 22MAR2010  
 APVD: D. STRAUSSER 27APR2010

DIMENSIONS: mm  
 TOLERANCES UNLESS OTHERWISE SPECIFIED:  
 0 PLC ±  
 1 PLC ±0.2  
 2 PLC ±  
 3 PLC ±  
 4 PLC ±  
 ANGLES ±  
 FINISH ±

MATERIAL: 3

PRODUCT SPEC: 108-1329  
 APPLICATION SPEC: 114-16016  
 WEIGHT: 22.48g

NAME: HEADER ASSEMBLY, 23 POSITION, VERTICAL, AMPSEAL  
 SIZE: A1  
 CAGE CODE: 00779  
 DRAWING NO: 776200  
 RESTRICTED TO: -

CUSTOMER DRAWING SCALE: 4:1 SHEET 1 OF 2 REV: E1

REVISIONS				
P	LTN	DESCRIPTION	DATE	APVD
-	SEE SHEET 1			

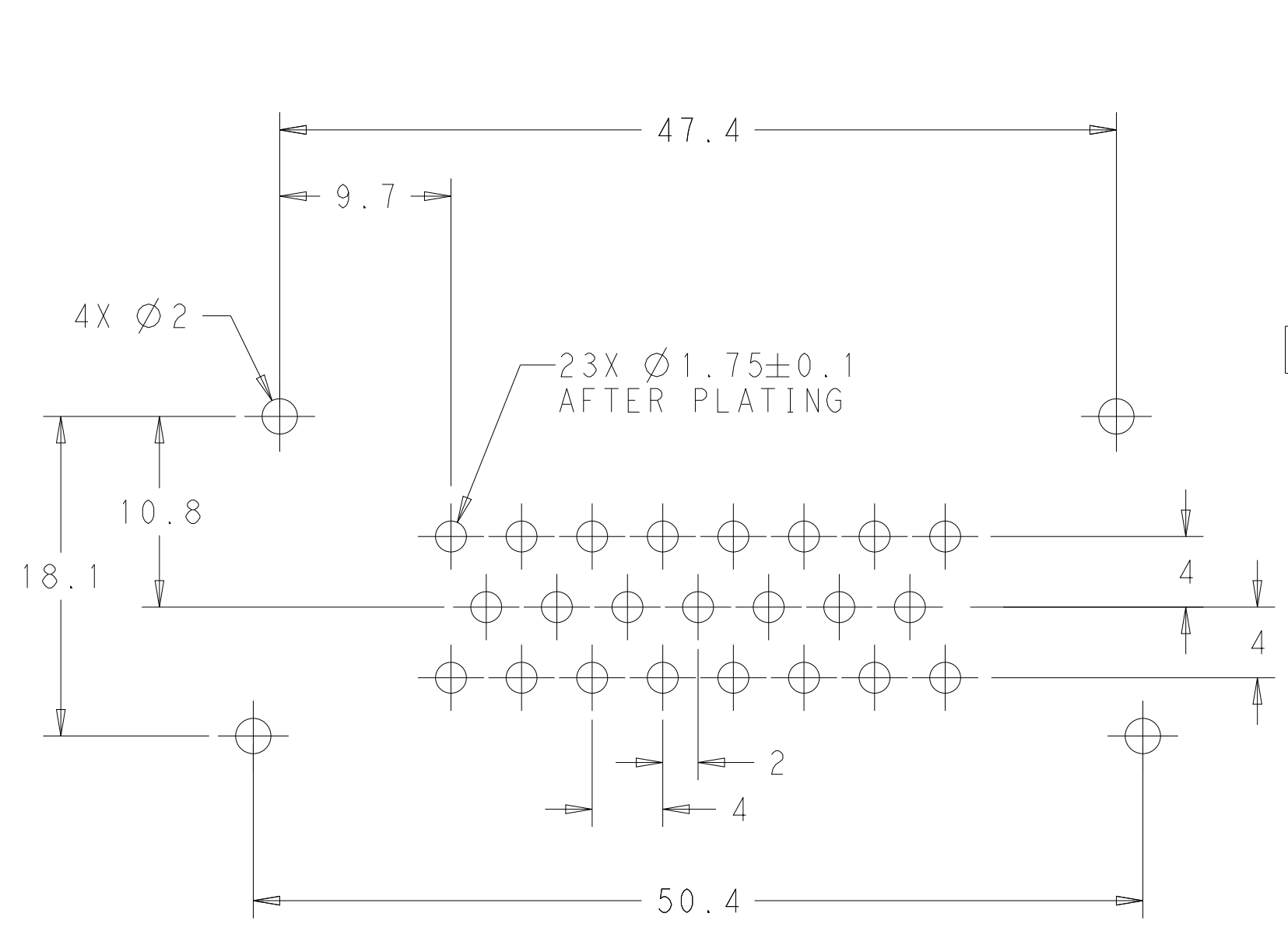

RECOMMENDED P.C. BOARD LAYOUT FOR 1.57 THICK P.C. BOARD

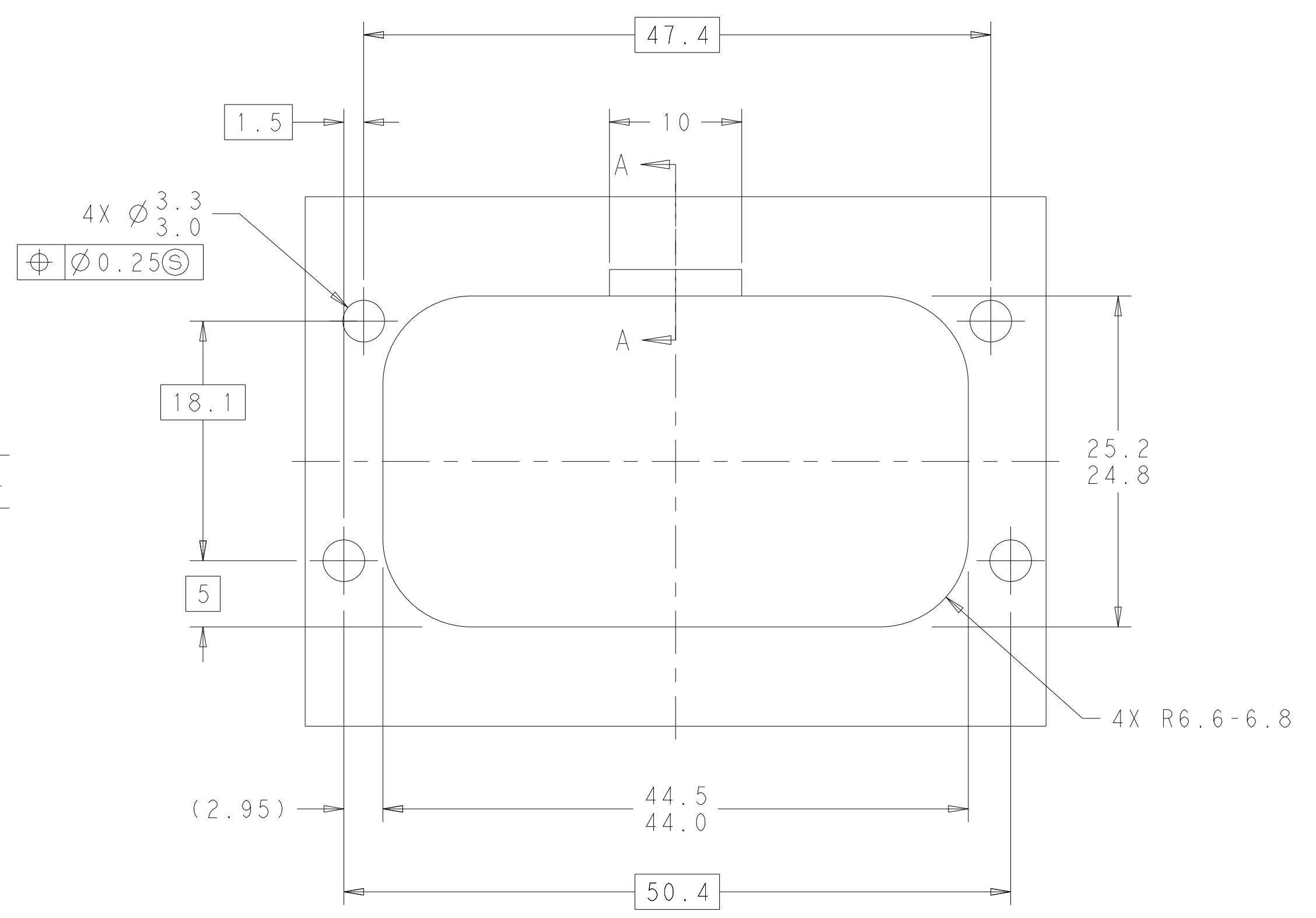

RECOMMENDED MOUNTING HOLE LAYOUT FOR 5.0 MAX THICK PANEL

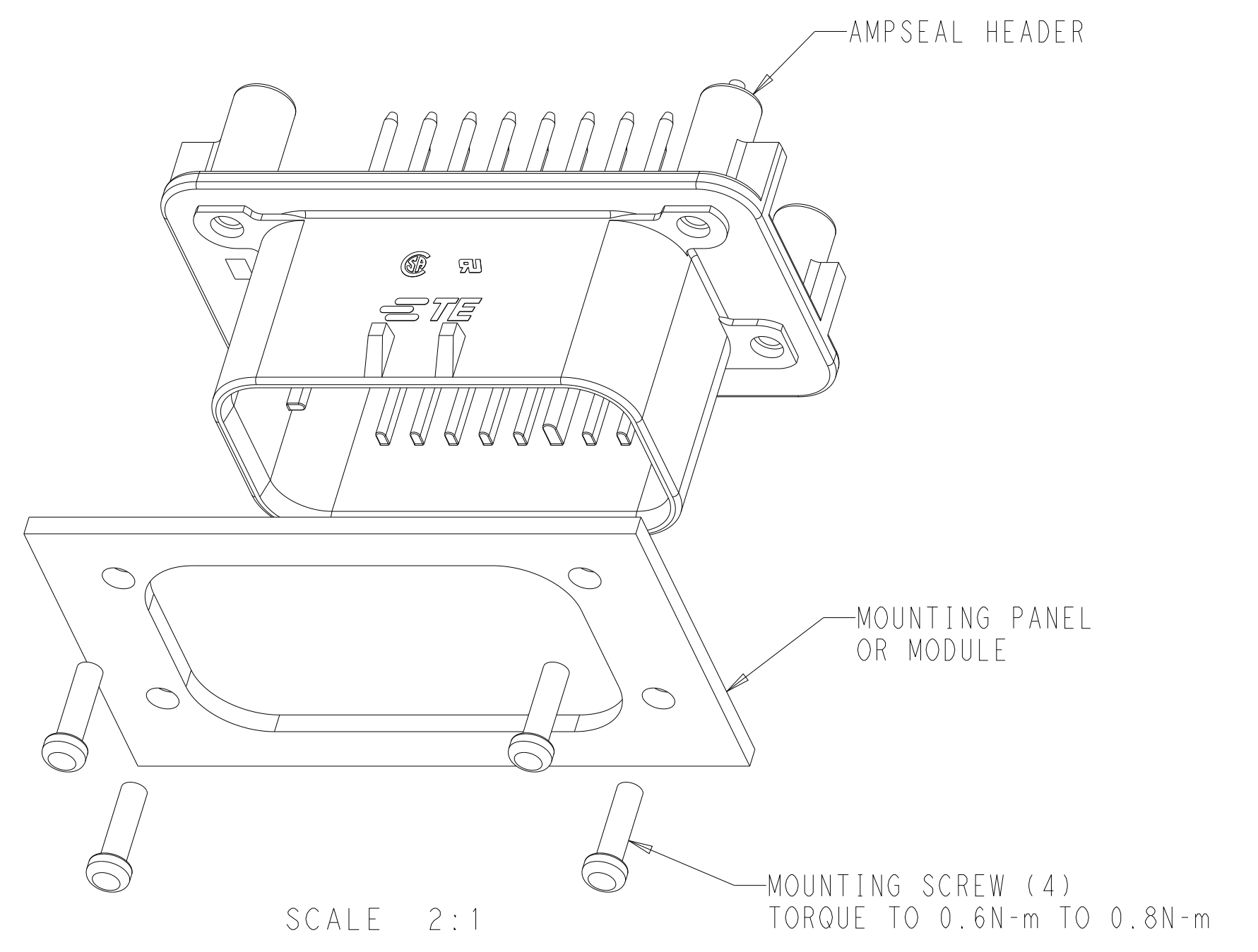

SCALE 2:1

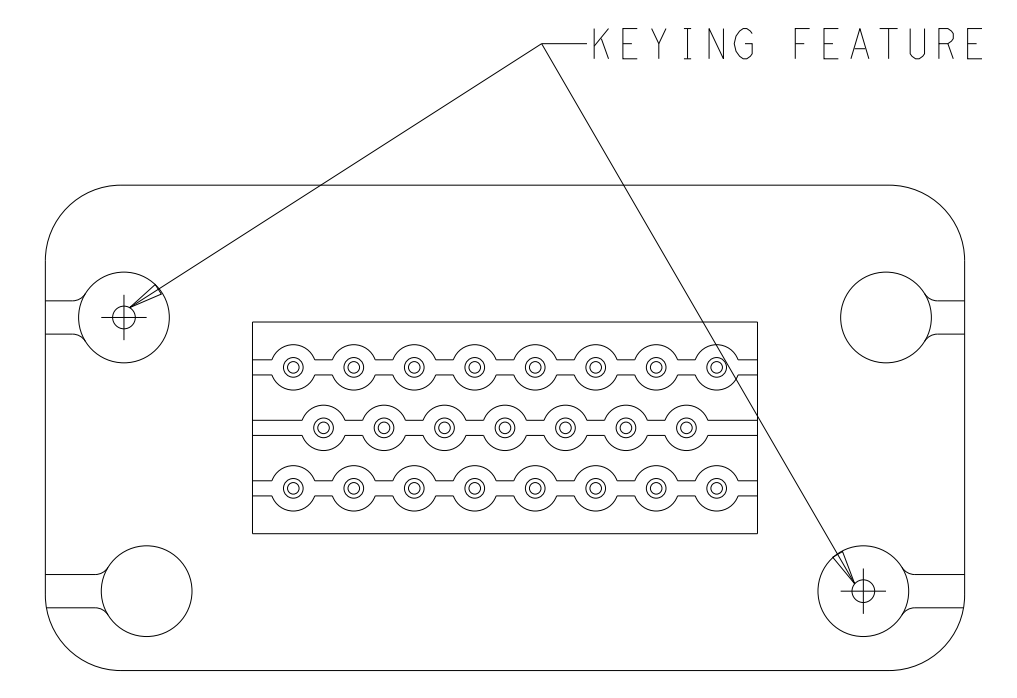

KEYING FOR 776200-1 AND 776200-5 SCALE 2:1

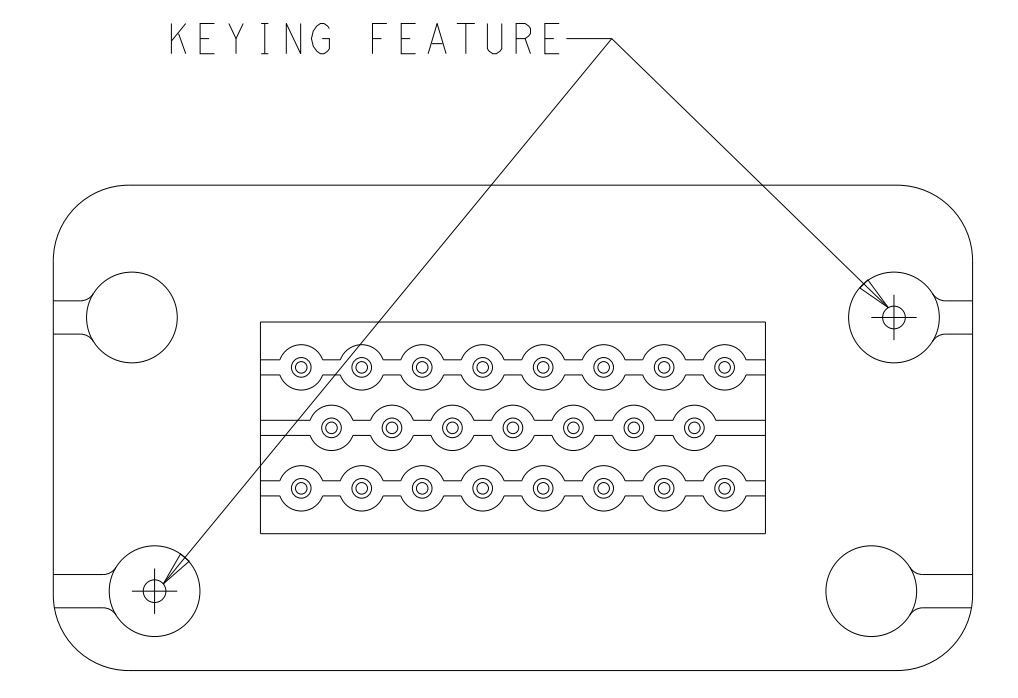

KEYING FOR 776200-2 AND 776200-4 SCALE 2:1

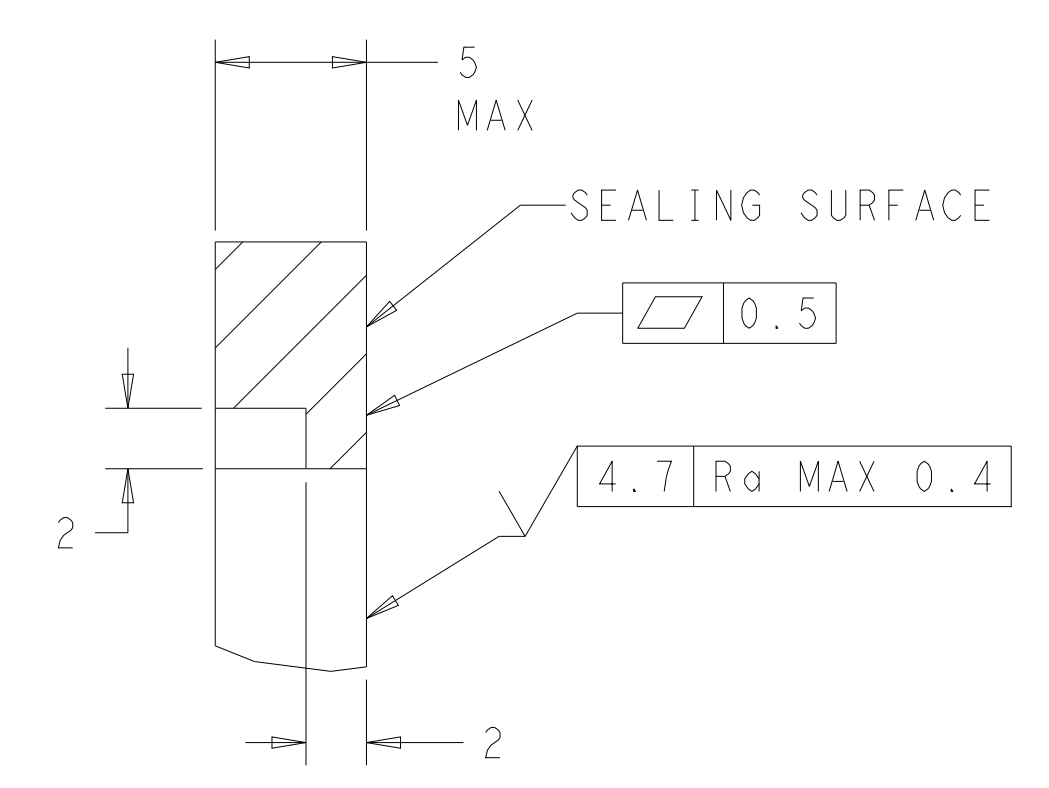
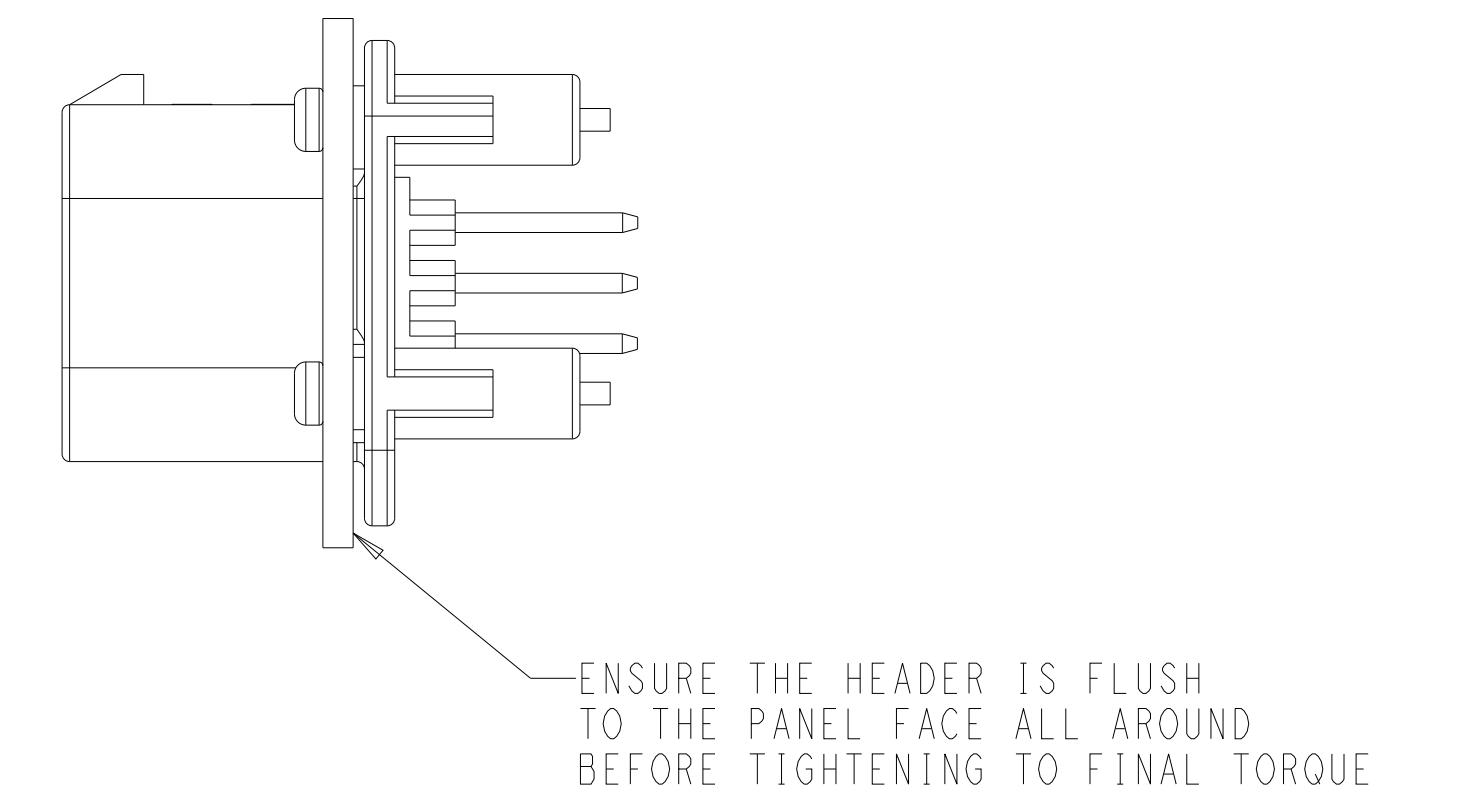

SECTION A-A  
 OPTIONAL CONSTRUCTION IF PANEL THICKNESS IS GREATER THAN 2.0  
 SCALE 4:1

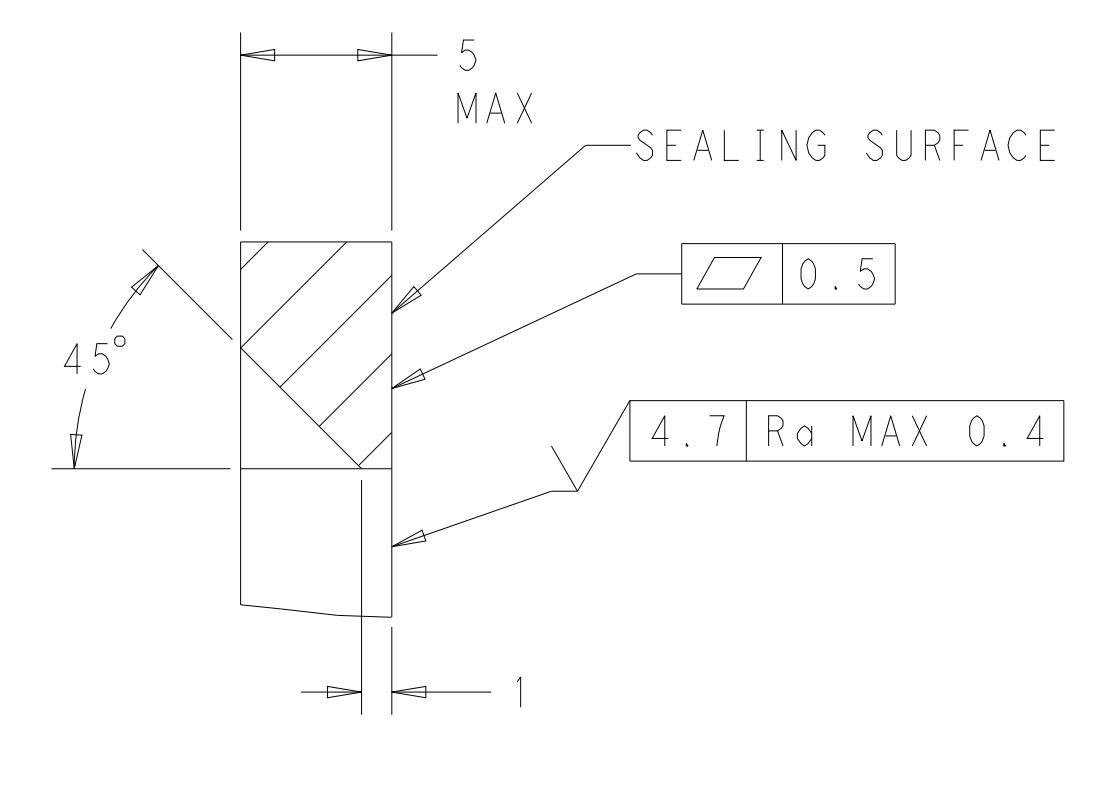

SECTION A-A  
 OPTIONAL CONSTRUCTION IF PANEL THICKNESS IS GREATER THAN 2.0  
 SCALE 4:1

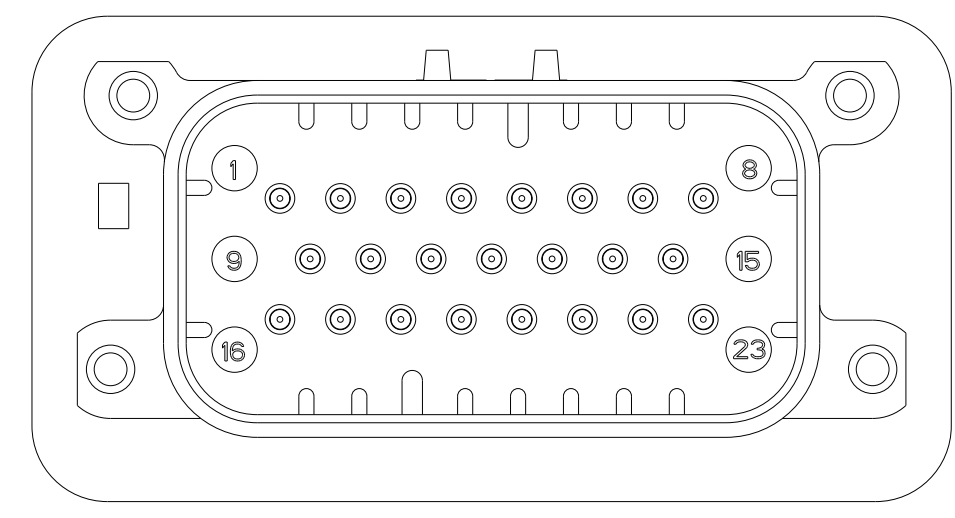

776200-2 & 1-776200-2  
 KEY LOCATION  
 SCALE 2:1

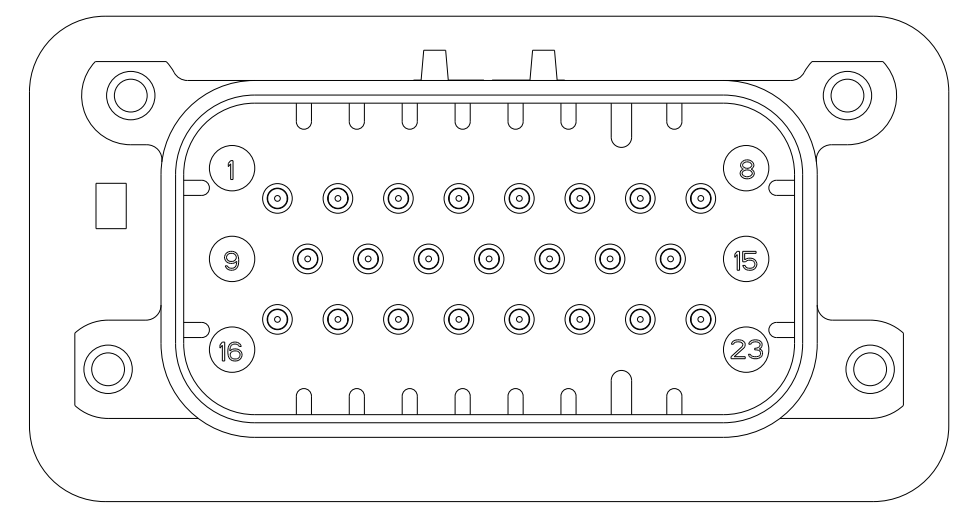

776200-4 & 1-776200-4  
 KEY LOCATION  
 SCALE 2:1

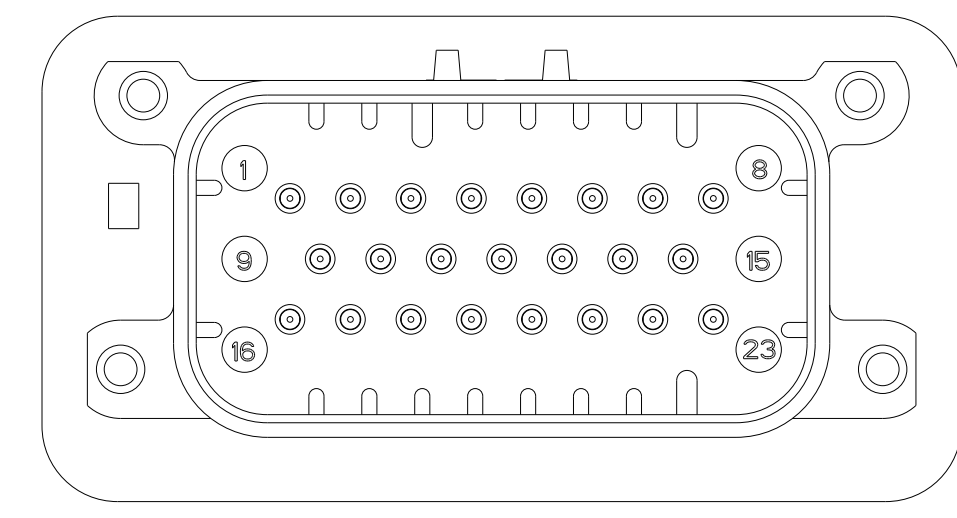

776200-5 & 1-776200-5  
 KEY LOCATION  
 SCALE 2:1

THIS DRAWING IS A CONTROLLED DOCUMENT.		OWN D. STRAUSSER 04FEB2010	TE Connectivity	
DIMENSIONS: mm		CHK D. STRAUSSER 22MAR2010		
TOLERANCES UNLESS OTHERWISE SPECIFIED:		APVD D. STRAUSSER 27APR2010	NAME	
0 PLC ±0.2		PRODUCT SPEC	HEADER ASSEMBLY, 23 POSITION, VERTICAL, AMPSEAL	
1 PLC ±0.2		108-1329	SIZE CAGE CODE DRAWING NO RESTRICTED TO	
2 PLC ±0.2		APPLICATION SPEC	A100779C=776200	
3 PLC ±0.2		114-16016	WEIGHT 22.48g	
4 PLC ±0.2		WEIGHT	CUSTOMER DRAWING	
ANGLES FINISH		SCALE 4:1	SHEET 2 OF 2 REV E1	