

REVISIONS

P	LTR	DESCRIPTION	DATE	DWN	APVD
	A	INITIAL RELEASE	06MAY2021	SM	NA

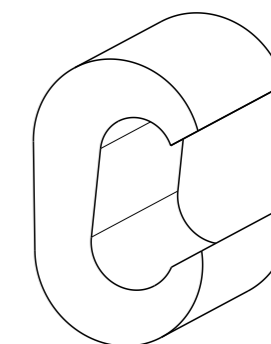
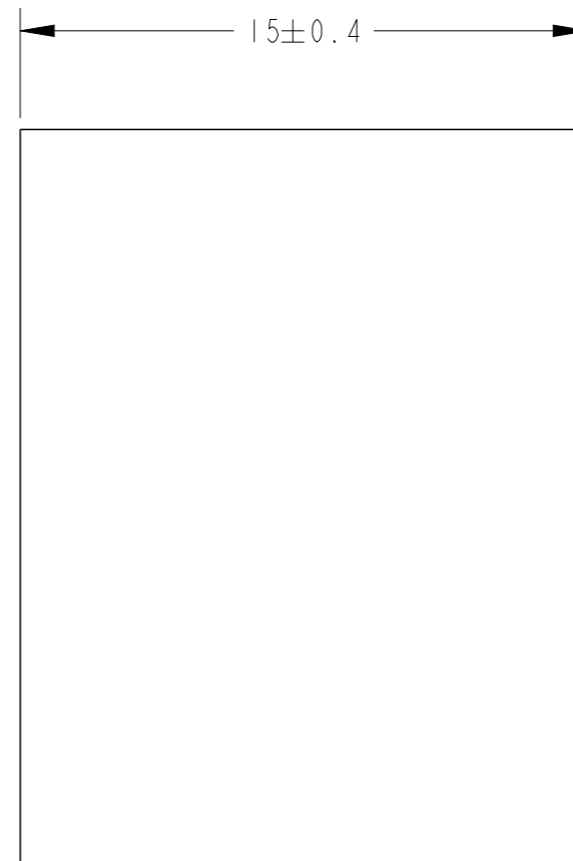
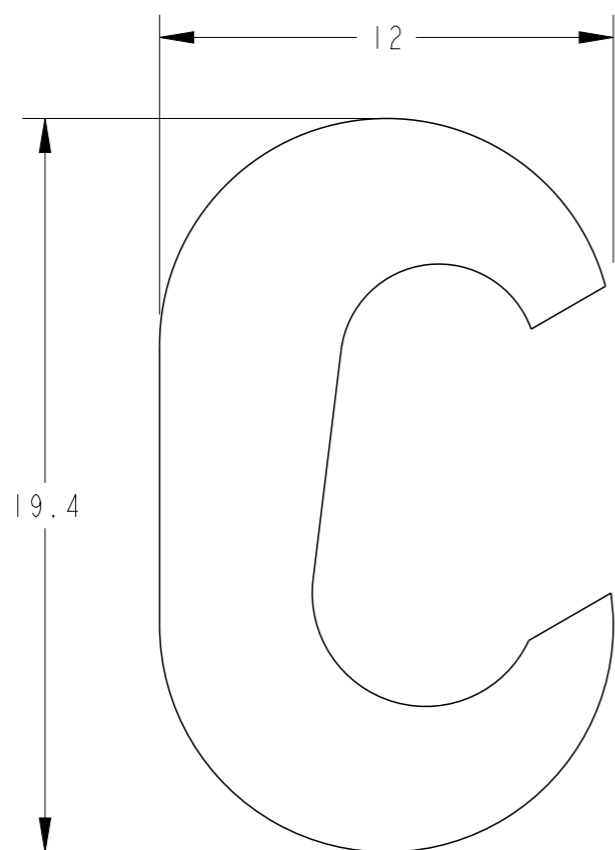

ECHELLE 2:1

Notes:

1. Cumulative capacities (Main & Tap): 19 mm<sup>2</sup> minimum to 32 mm<sup>2</sup> maximum
2. Marking: Product reference, E70Cu (die), Logo, batch
3. Weight = 17 gr
4. Raw material: Pure electrolytic Copper (>99%)

C16 E	709638-1	TINNED
REFERENCE	PART NUMBER	PROTECTION

THIS DRAWING IS A CONTROLLED DOCUMENT.		DWN SATYA.M 06MAY2021
DIMENSIONS: mm		CHK L. JONATHAN 06MAY2021
TOLERANCES UNLESS OTHERWISE SPECIFIED:		APVD N. ALMEDIA 06MAY2021
0 PLC ±-	1 PLC ±-	PRODUCT SPEC -
2 PLC ±-	3 PLC ±-	APPLICATION SPEC -
4 PLC ±-	ANGLES ±-	WEIGHT -
MATERIAL -	FINISH -	CUSTOMER DRAWING

		TE Connectivity	
		NAME CONNECTEUR C16	
SIZE A3	CAGE CODE 00779	DRAWING NO C-709638	RESTRICTED TO -
SCALE 5:1		SHEET 1 OF 1	REV A