

4 3 2 1

THIS DRAWING IS UNPUBLISHED. RELEASED FOR PUBLICATION  
 © COPYRIGHT - BY TYCO ELECTRONICS CORPORATION. ALL RIGHTS RESERVED.

LOC	DIST	REVISIONS			
P	LTR	DESCRIPTION	DATE	DWN	APVD
GA	1	P			
		P	LC20-0063-10 / ECO-10-008209	13APR2010	DM BJ

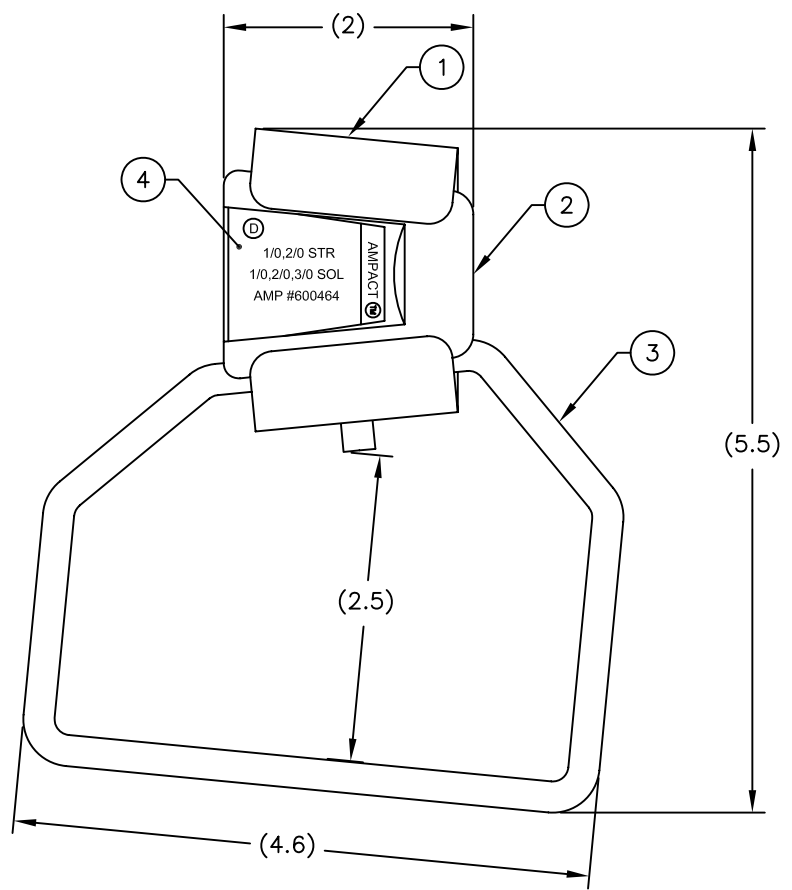

1. DIMENSIONS ARE FOR REFERENCE ONLY
2. INHIBITOR IS APPLIED AT FACTORY TO GROOVES OF 'C' BODY AND WEDGE
3. WIRE SIZES ARE MARKED ON WEDGE
4. USE BLUE SHELLS PART NO. 69338-1

#2 AWG	1/0, 2/0 ACSR/AAC	600464
BAIL SIZE	RUN CONDUCTOR RANGE	PART NO.

QTY	DESCRIPTION	ITEM NO
1	LABEL	4
1	BAIL, COPPER, TIN PLATED	3
1	WEDGE, ALUMINUM ALLOY	2
1	C BODY, ALUM ALLOY	1

THIS DRAWING IS A CONTROLLED DOCUMENT.		DWN M. CHOW 27JUL98	Tyco Electronics Corporation Markham, ON L3R-1E1	
DIMENSIONS: MM [INCHES]		CHK H. HENRY 28JUL98	NAME STIRRUP ASSEMBLY, AMPACT, BLUE CODED, 1/0, 2/0 STR TO #2 BAIL	
TOLERANCES UNLESS OTHERWISE SPECIFIED: 0 PLC ± 1 PLC ± 2 PLC ± 3 PLC ± 4 PLC ± ANGLES ±		APVD J. HANNA 28JUL98	RESTRICTED TO	
MATERIAL REFER TABLE		FINISH REFER TABLE	SIZE A3	CAGE CODE 00779
		WEIGHT -	DRAWING NO C=600464	
		CUSTOMER DRAWING		SCALE NTS
		SHEET 1 OF 1		REV P