

REVISIONS				
P.	LTN.	DESCRIPTION	DATE	APPROV.
A		RELEASED PER ECO-17-002820	01MAR2017	VP MDB

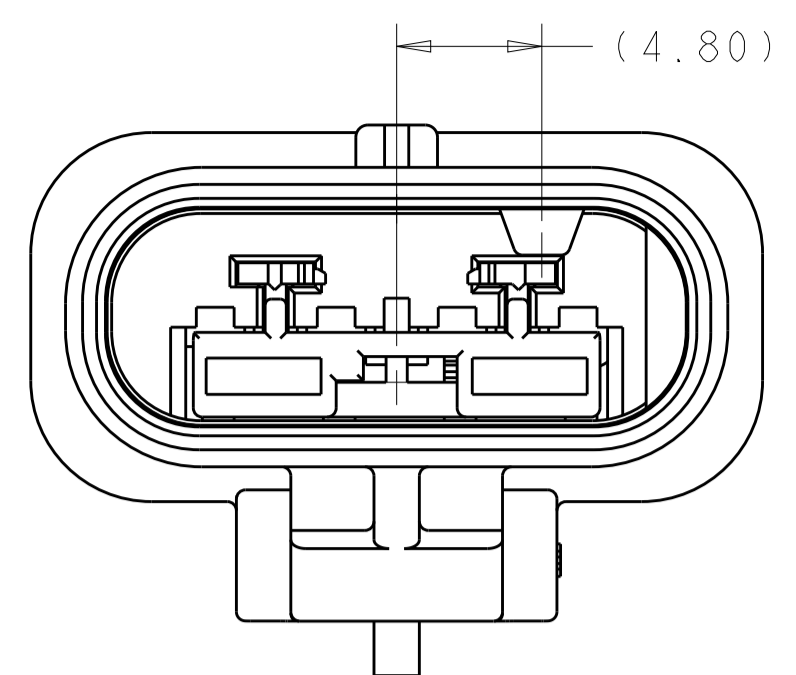

KEY CODE A
SCALE 4:1

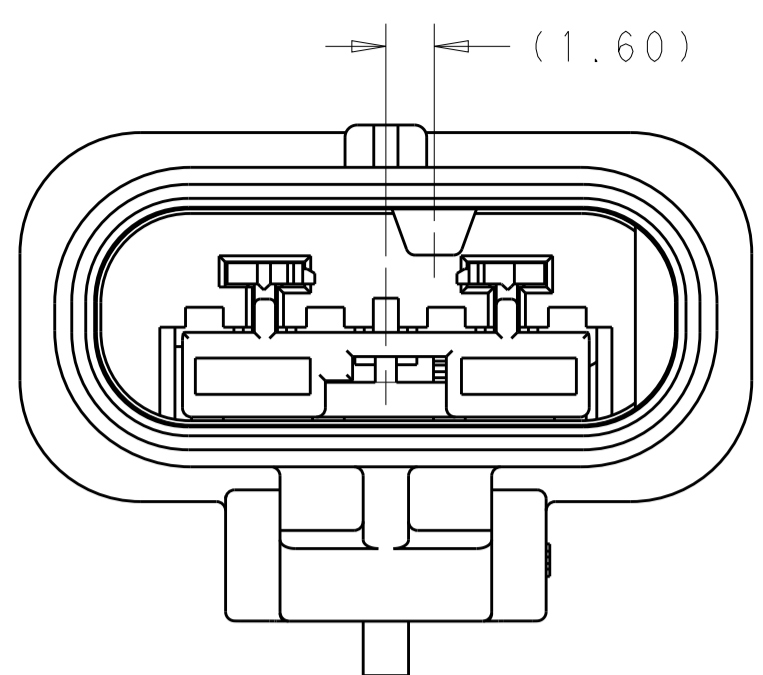

KEY CODE B
SCALE 4:1

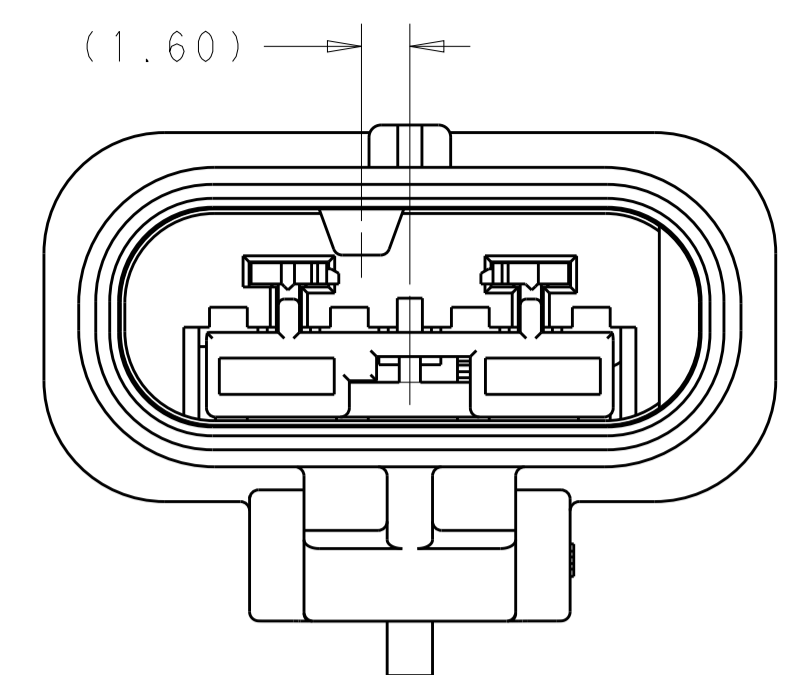

KEY CODE C
SCALE 4:1

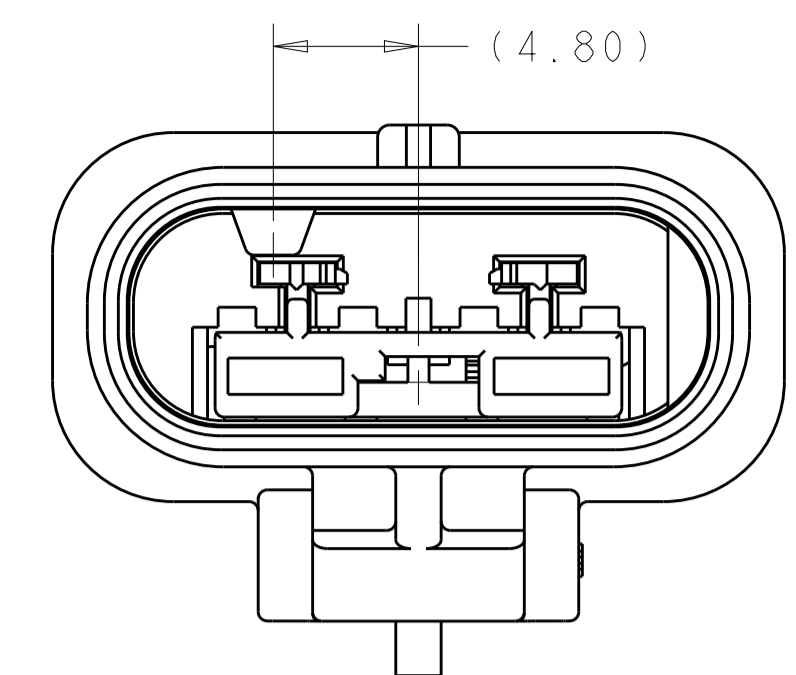

KEY CODE D
SCALE 4:1

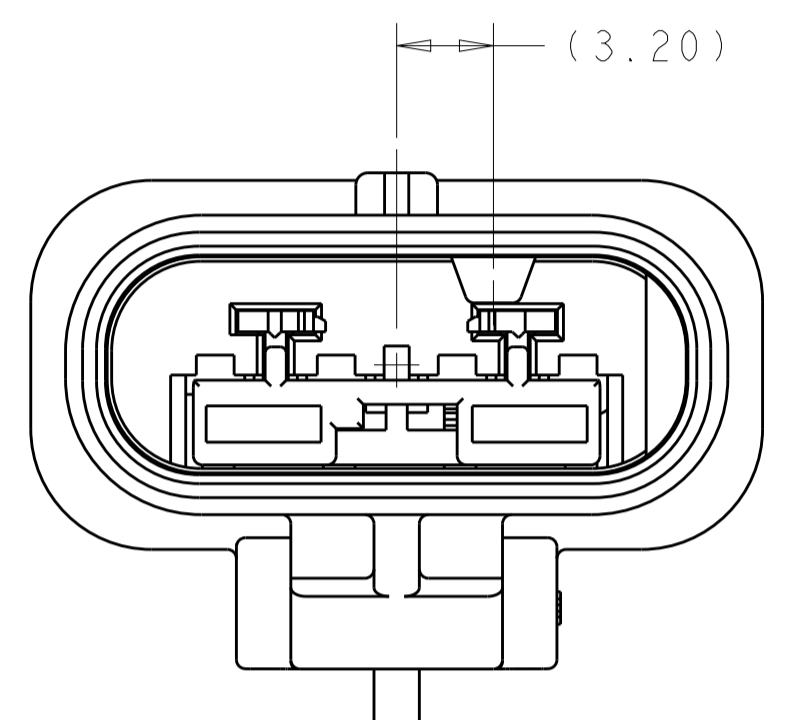

KEY CODE E
SCALE 4:1

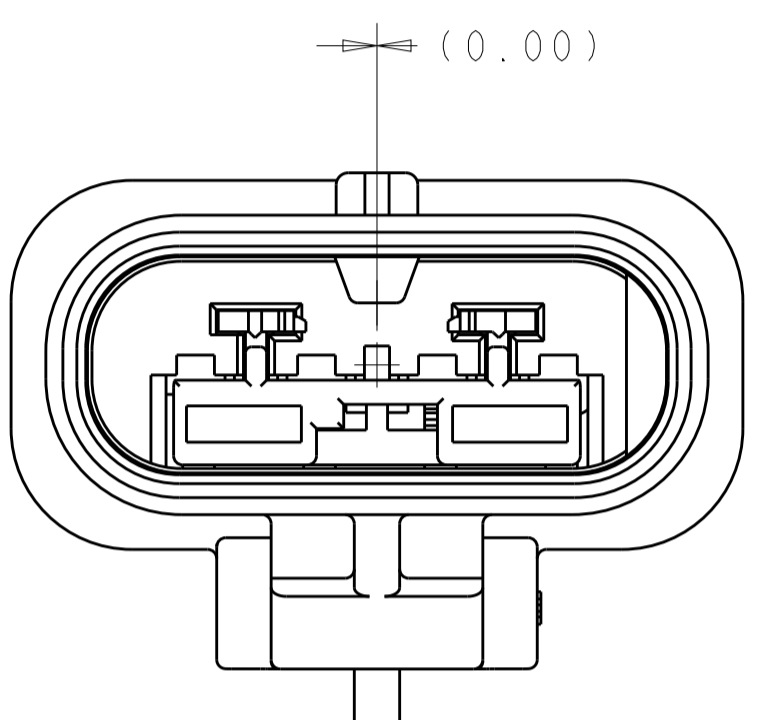

KEY CODE F
SCALE 4:1

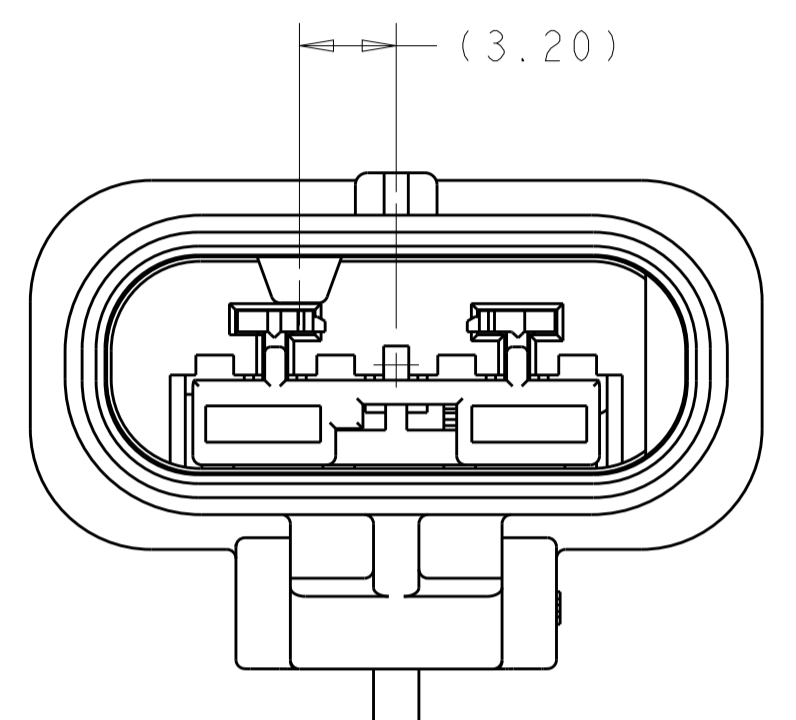

KEY CODE G
SCALE 4:1

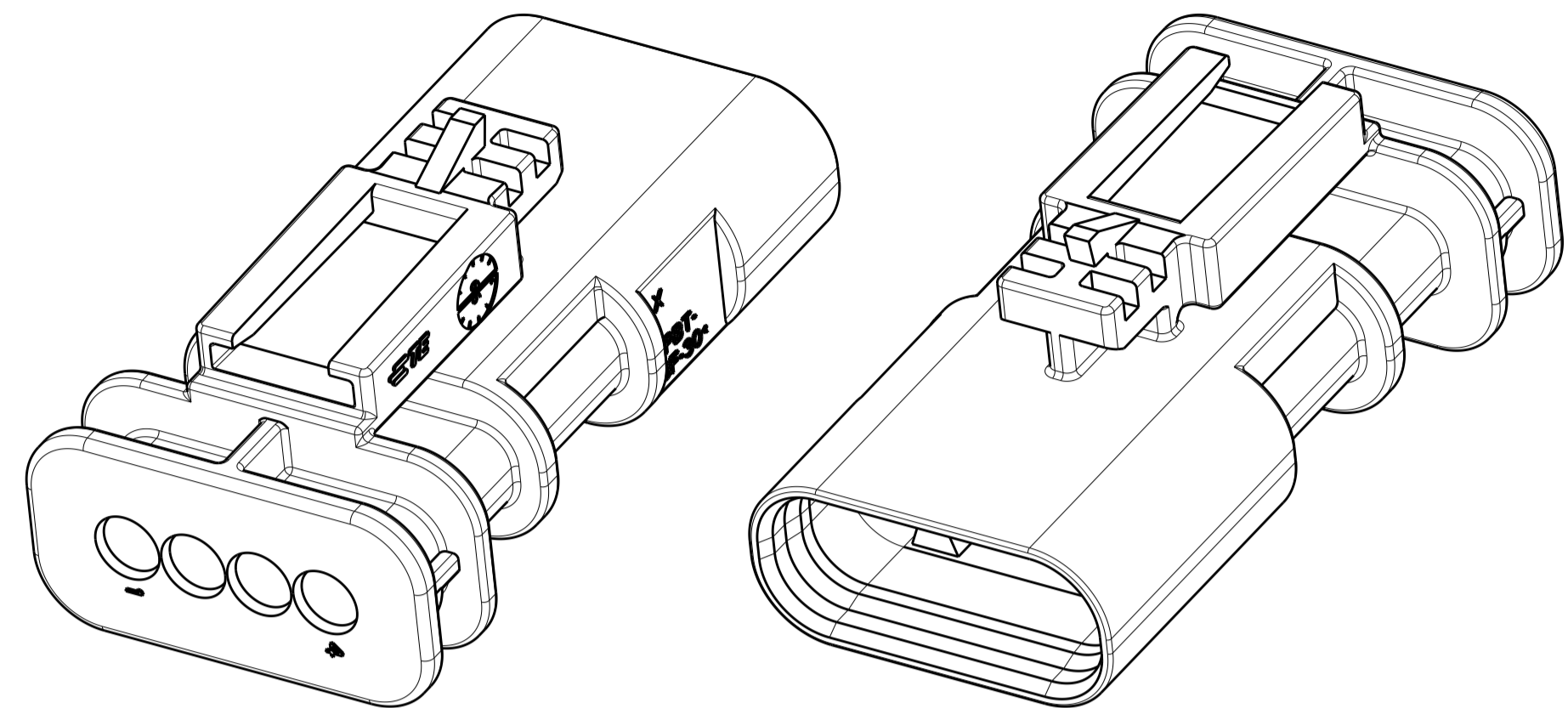

ISOMETRIC VIEWS
SCALE 3:1

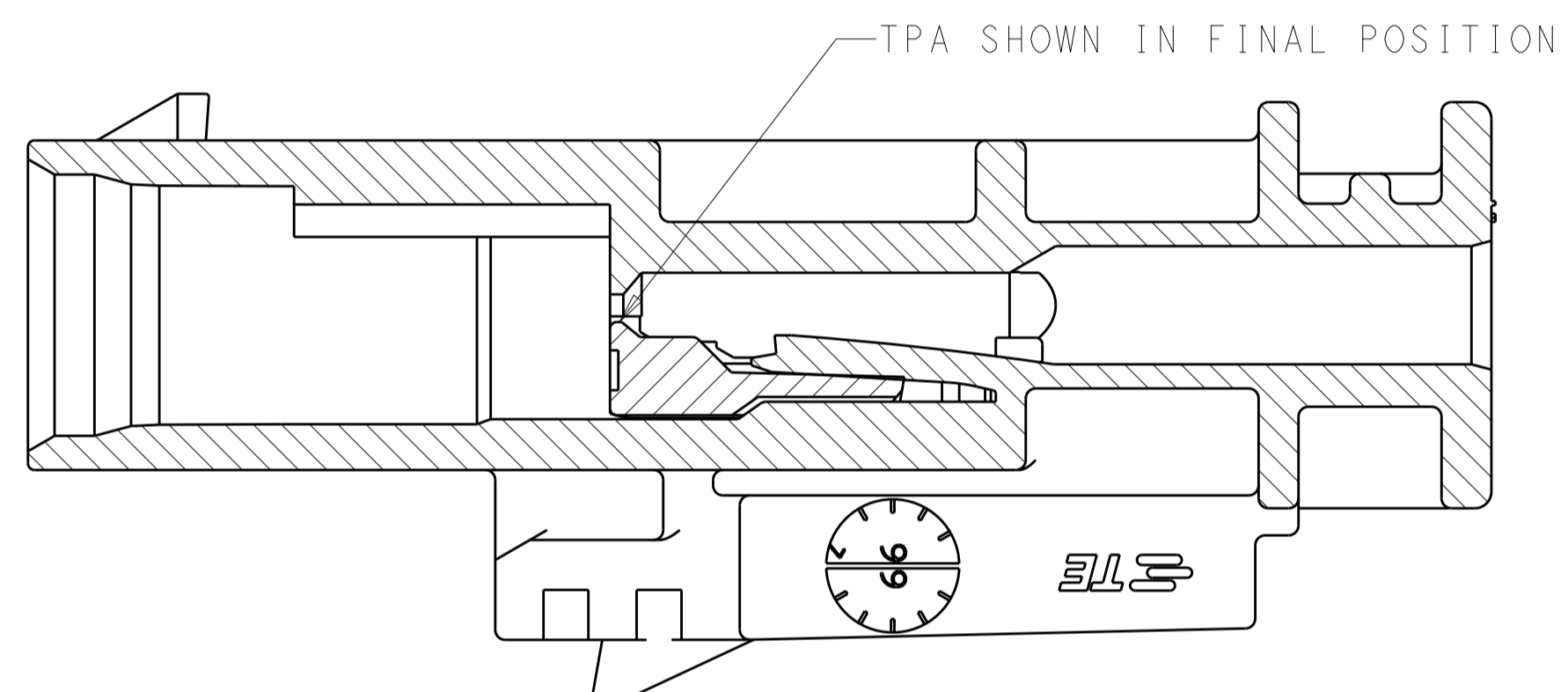

SECTION D-D
SCALE 5:1

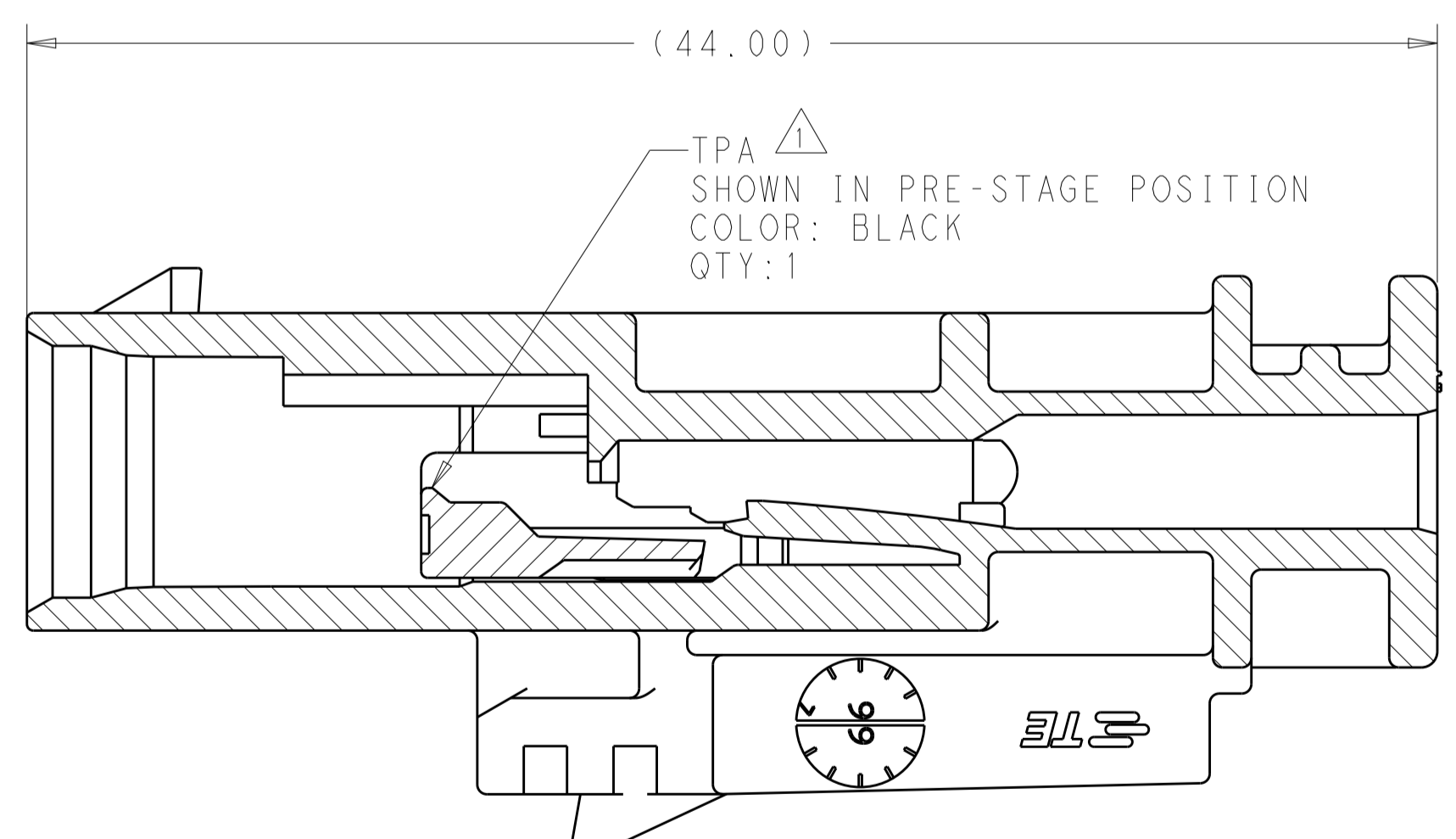

SECTION D-D

- △ CAP ASSEMBLY IS SHIPPED WITH TPA IN PRE-STAGED POSITION. SEE INSTRUCTION SHEET 408-32094 FOR CONNECTOR SERVICE AND TPA OPERATION.
- 2. TERMINALS SOLD SEPARATELY. FOR USE WITH TE MCON 1.2mm CLEAN BODY TAB CONTACT WITH WIRE SEAL. SEE TABLE.
- 3. FOR OPTIONAL TERMINAL CAVITY BLOCKING, CONTACT TE SALES REPRESENTATIVE OR CUSTOMER SERVICE.
- △ CONTACT PLATING AND APPLICABLE INDIVIDUAL WIRE SEAL ARE APPLICATION DEPENDENT. CONTACT TE SALES REPRESENTATIVE OR CUSTOMER SERVICE FOR DETAILS.
- △ FOR WIRE CRIMP DETAILS, SEE TE APPLICATION SPECIFICATION 114-18464.
- △ DOCUMENTED I.C.D. IS SPECIFIED TO MEET MOST WIRE SEAL APPLICATIONS. HOWEVER, I.C.D. IS HIGHLY DEPENDENT ON INSULATION TYPE AND OD. SUFFICIENT GRIP OF THE WIRE SEAL MUST BE OBTAINED SUCH THAT WIRE SEAL DOES NOT DISPLACE FROM INSULATION GRIP DURING CONTACT INSERTION INTO CONNECTOR HOUSING. THE WIRE SEAL SHALL NOT BE CRIMPED TOO TIGHTLY THAT THE WIRE SEAL TEARS DURING THE CRIMPING OPERATION.
- 7. CAP ASSEMBLY ACCEPTS ACCESSORY CLIPS DESIGNED TO FUNCTION IN CLIP SLOT DEFINED BY EWCAP-005-7, REVISION A.
- 8. NOTE REMOVED
- 9. TRACEABILITY CODE (YY = TWO DIGIT YEAR, JJJ = 3 DIGIT JULIAN DAY, S = 1 DIGIT SHIFT).
- △ KEY CODE NOT TOOLED
- 11. MATES WITH STRAIGHT EXIT WIRE DRESS, TE PN 2272162-1 AND RIGHT ANGLE EXIT WIRE DRESS, TE PN 2272163-1

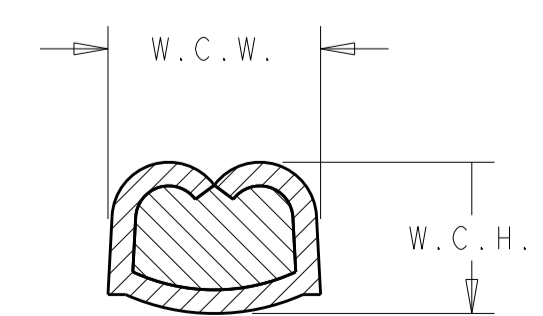
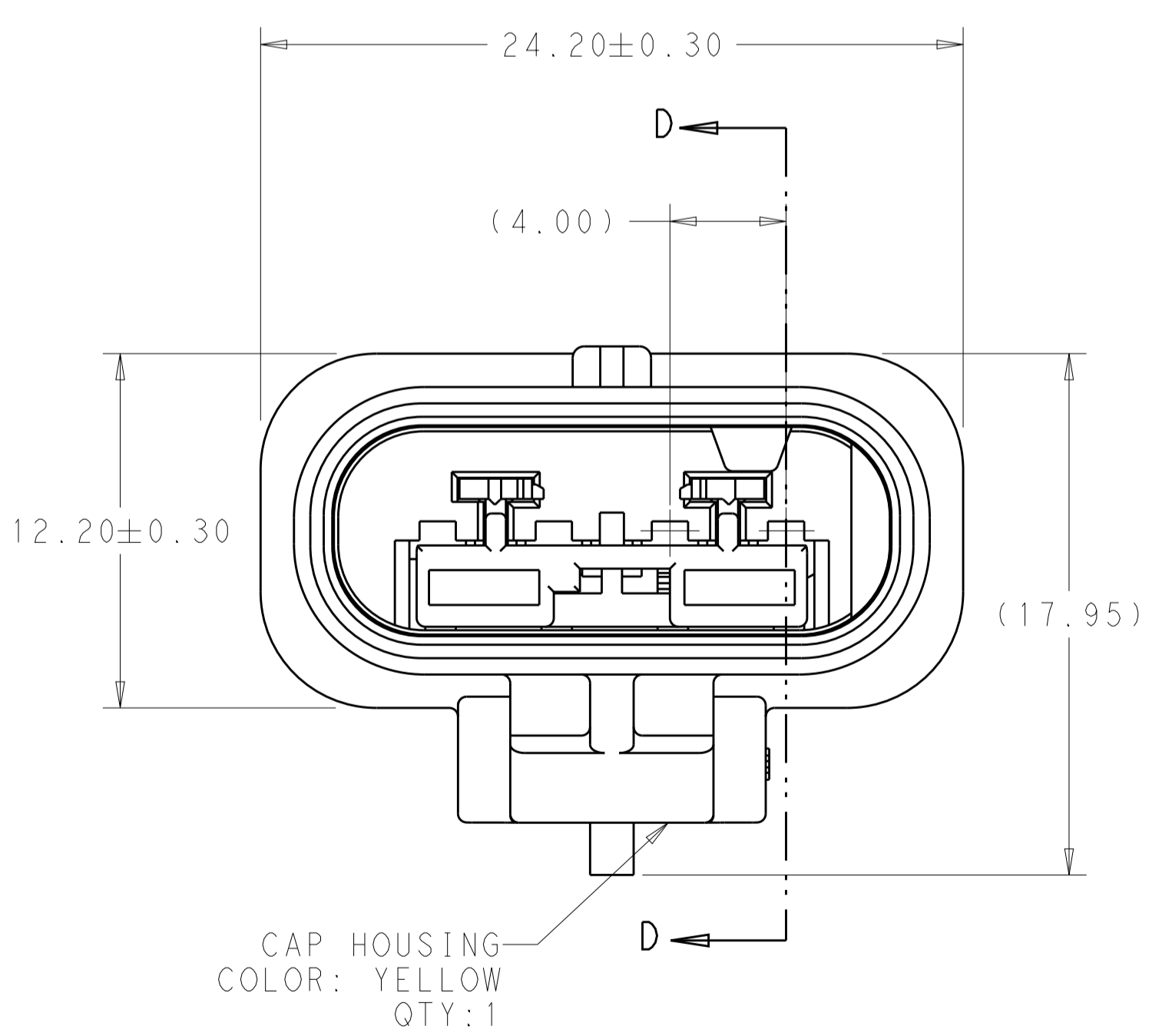

WIRE CRIMP DIMENSIONS

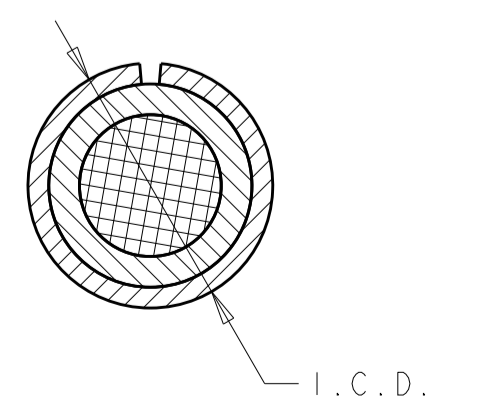

INSULATION CRIMP DIMENSIONS

KEYING CODE	PART NUMBER
G	2203809-7
F	2203809-6
E	2203809-5
D	2203809-4
C	2203809-3
B	2203809-2
A	2203809-1

125°C	2141114	1.40-1.90mm	△	△	△	△	967067-1	THIS DRAWING IS A CONTROLLED DOCUMENT. DIMENSIONS: mm. TOLERANCES UNLESS OTHERWISE SPECIFIED: 0 PLC ±, 1 PLC ±, 2 PLC ±, 3 PLC ±, 4 PLC ±, ANGLES ±.	DMN M. HITCHCOCK 12AUG2010	TE Connectivity CAP ASSEMBLY, 4 POSITION, MCON SIR
	2141116	1.40-1.90mm							CHK B. BUCHTER 12AUG2010	
	2177610	1.90-2.40mm							APVD B. BUCHTER 12AUG2010	
MAX TEMP △	MALE TERMINAL P/N	APPLICABLE WIRE FINISHED O.D.	W.C.H.	W.C.W.	I.C.D.	WIRE SEAL PART NUMBER △	MATERIAL	FINISH	SIZE: A1 CAGE CODE: 00779 DRAWING NO: 2203809 CUSTOMER DRAWING	RESTRICTED TO