

**1. INTRODUCTION**

This specification covers the requirements for application of Tyco Electronics DIN 1.6 / 5.6 mS (75Ω) 90° cable jack and plug connectors. The cable braid is connected to the plug or jack body with a screw connection, the inner conductor is soldered.

The component drawings in the specification may differ from the parts supplied.

**2. DRAWINGS**

PART NUMBER	CABLE	TOOLS: OPEN-AND WRENCH
2-1393682-3	RG 179	10
4-1393682-2	RG 179	10
5-1393682-3	RG 179	10

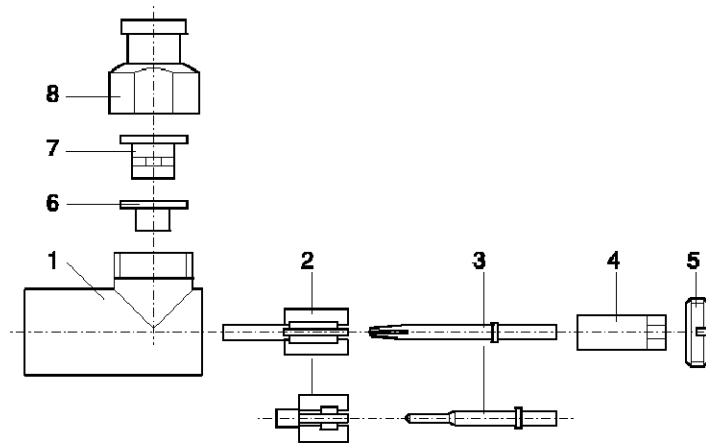

- |                   |                |
|-------------------|----------------|
| 1 Body            | 5 Threaded cap |
| 2 Insulator       | 6 Ferrule      |
| 3 Inner conductor | 7 Ferrule      |
| 4 Insulator       | 8 Ring nut     |

**3. INSTRUCTIONS**

3.1 Prepare cable. Screen braiding must not be taken apart

3.2 Push on ring nut

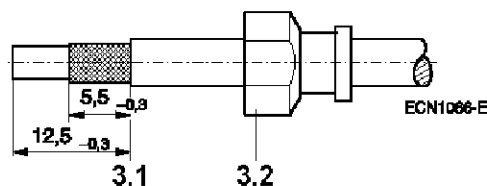

3.3 Push ferrule (7) onto cable – flush with the screen braiding

3.4 Tin solder screen braiding and ferrule (7) (solder must be applied around the whole circumference of the screen braiding)

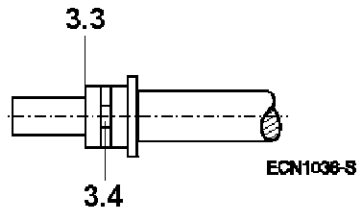

3.5 Push on ferrule (6)

3.6 Shorten cable dielectric

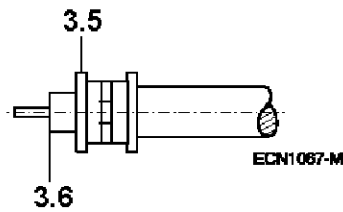

3.7 Insert insulator (2) and inner conductor in body

3.8 Insert prepared cable in body up to face contact

3.9 For cable clamping and face contacting: tightly screw on nut with wrench 10

3.10 Refer to soldering specification 114-71028

3.11 Insert insulator (4)

3.12 Screw in threaded cap and secure with lacquer

