

ANSI SERIES COMPOSITE DEADEND INSULATOR

OVERHEAD LINE APPLICATIONS UP TO 485 kV BIL

KEY FEATURES

- 15,000 lb. tension rating (SML)
- Wide selection of metal end fittings selection
- Reliable tensile performance
- Light-weight for easier installation
- Shed design to minimize insulator length per kV rating
- Shock and vibration resistant
- Good tracking and erosion resistance performance
- Quality design and manufactured in accordance with ISO9001 and ANSI C29.13

TE Connectivity (TE) offers a complete range of silicone suspension / tension insulators for overhead line applications up to 485 kV BIL.

Our complete portfolio of insulators is designed to fit a wide selection of metal end fittings. The portfolio includes numerous lengths and creepage configurations to fit the requirements of your application. TE's compact insulator profile has the same shed diameter to maximize flashover performance in polluted environments over a minimum insulator length.

Our suspension / tension insulators are made of silicone, a hydrophobic material with proven tracking and erosion resistance and high technical performance in a wide range of climatic and pollution conditions.

Customers can count on consistent, high quality products, driven by TE's proven innovation and backed by our extraordinary customer support.

ANSI Series Composite Deadend Insulator

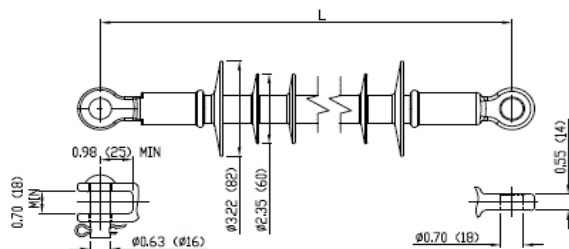

End Fitting - Clevis per ANSI C29.13 (Forged*)
Tongue per ANSI C29.13 (Forged*)

Round Head Pin - Galvanized Pin

Split Pin - Stainless Steel

SML - 15000 Lbs

Routine Test - 7,850 Lbs

**Additional end fittings are available upon request*

Part description key

TE- Company Designation
XXXX- ANSI Class
XX - End fts.
XX Fitting Type/specials

PRODUCT SPECIFICATION

TCPN	DESCRIPTION	ANSI CLASS	CREEP-AGE DISTANCE INCHES (MM)	DRY ARC DISTANCE INCHES (MM)	LOW FREQUENCY FLASH-OVER DRY (KV)	LOW FREQUENCY FLASH-OVER WET (KV)	POSITIVE CRITICAL IMPULSE FLASH-OVER (KV)	RADIO INFLUENCE TEST VOLTAGE (KV)	MAX RIV (MV)	SPECIFIED MECHANICAL LOAD LB (KN)	MINIMUM TORSIONAL LOAD FT.LB (N.M)	SECTION LENGTH L INCHES (MM)	AP-PROX. WEIGHT (KG)	STD PACK QTY
EP0241-000	TE-DS15-CT-11	DS-15	15.3 (390)	7.8 (200)	100	85	150	15	<10	15,730 (70)	35 (48)	13 (330)	0.93	36
EP0242-000	TE-DS28-CT-11	DS-28	25 (635)	12.2 (310)	130	100	190	20	<10	15,730 (70)	35 (48)	17.6 (447)	1.05	18
EP0243-000	TE-DS35-CT-11	DS-35	32.2 (820)	15.7 (400)	175	155	250	30	<10	15,730 (70)	35 (48)	21 (534)	1.14	18
EP0244-000	TE-DS46-CT-11	DS-46	37.2 (945)	18.11 (460)	200	185	280	30	<10	15,730 (70)	35 (48)	23.30 (592)	1.2	18
EP0245-000	TE-DS69-CT-11	DS-69	49.2 (1250)	23.81 (605)	245	225	360	45	<10	15,730 (70)	35 (48)	29 (737)	1.35	18

te.com/energy

©2020 TE Connectivity Ltd. All Rights Reserved. EPP-3474-DDS-1/2020

Raychem, TE Connectivity and TE Connectivity (logo) are trademarks. Other logos, product and/or company names might be trademarks of their respective owners. While TE has made every reasonable effort to ensure the accuracy of the information in this brochure, TE does not guarantee that it is error-free, nor does TE make any other representation, warranty or guarantee that the information is accurate, correct, reliable or current. TE expressly disclaims all implied warranties regarding the information contained herein, including, but not limited to, any implied warranties of merchantability or fitness for a particular purpose. The dimensions in this catalog are for reference purposes only and are subject to change without notice. Specifications are subject to change without notice. Consult TE for the latest dimensions and design specifications.

FOR MORE INFORMATION: TE Technical Support Centers

USA: +1 800 327 6996
France: +33 380 583 200
UK: +44 0870 870 7500
Germany: +49 896 089 903
Spain: +34 916 630 400
Italy: +39 333 250 0915
Benelux: +32 16 351 731
Canada: +1 (905) 475-6222
Mexico: +52 (0) 55-1106-0800
Latin/S. America: +54 (0) 11-4733-2200
China: +86 (0) 400-820-6015