

RAYCHEM DEADBREAK CONNECTING PLUG

600/900 Amp 15/28-35 kV CLASS

KEY FEATURES

- 15/28 kV or 35 kV, 600 or 900A ratings available
- Available in 150 kV or 200 kV BIL-rated designs
- Fully submersible
- Industry standard 5/8"-11 threaded stud used for electrical connection
- Available in either aluminum or copper
- Conforms to ANSI/IEEE standard 386
- 35 kV 200 BIL available upon request

TE Connectivity's (TE's) Raychem 600/900A deadbreak connecting plug is available in both 15/28 kV and 35 kV class versions.

The connecting plug is meant to connect two or more 600/900A deadbreak elbows. Typical applications are as a separable cable splice, circuit reconfiguration, or as an expandable, submersible junction.

900A ratings are achieved by ordering the copper version, but require copper cable and other copper constructed components.

A fully shielded, submersible connection is offered with conformance to IEEE standard 386. These standoff plugs are therefore interchangeable with other manufacturer's product that also comply with this standard.

Customers can count on consistent, high quality products, driven by TE's proven innovation and backed by our extraordinary customer support.

Raychem Deadbreak Connecting Plug



Ratings
Voltage Class 15/28 kV
Max Rating Phase-to-Ground 16.2 kV
Max Rating Phase-to-Phase 28 kV
AC 1 Minute Withstand 45 kV
DC 15 Minute Withstand 88 kV
BIL and Full Wave Crest 140 kV
Minimum Corona Level 21.5 kV (3pC)
Continuous 600/900A rms
24 Hour Overload 1,000A rms
Momentary: 600A 25,000 A symmetrical 10 cycles 600A 10,000 A symmetrical 3.00 sec 900A 40,000 A symmetrical 10 cycles 900A 10,000 A symmetrical 3.00 sec
100% Production Test
Minimum Corona Level 21.5 kV (3pC)
AC 1 Minute Withstand 45 kV

15/28 kV Deadbreak Connecting Plug

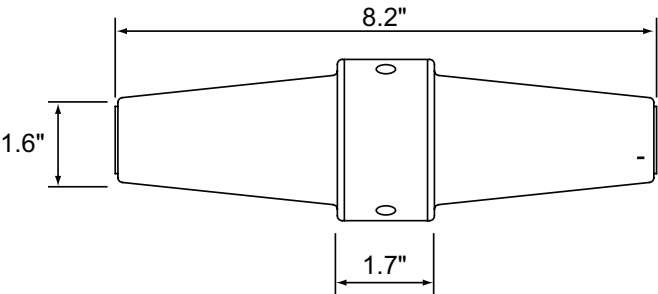

Ratings
Voltage Class 35 kV
Max Rating Phase-to-Ground 21.1 kV
Max Rating Phase-to-Phase 36.6 kV
AC 1 Minute Withstand 50 kV
DC 15 Minute Withstand 103 kV
BIL and Full Wave Crest 150 kV or 200 kV*
Minimum Corona Level 26 kV (3pC)
Continuous 600/900A rms
24 Hour Overload 1,000A rms
Momentary: 600A 25,000 A symmetrical 10 cycles 600A 10,000 A symmetrical 3.00 sec 900A 40,000 A symmetrical 10 cycles 900A 10,000 A symmetrical 3.00 sec
100% Production Test
Minimum Corona Level 26 kV (3pC)
AC 1 Minute Withstand 50 kV

35 kV Deadbreak Connecting Plug

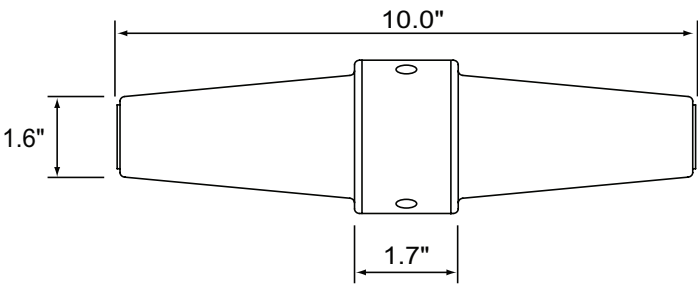

Product Selection Information			
Description	Voltage Class	Current Rating	Product Name
ELB-15/28-600-CP-AL	15/28 kV	600	Aluminum Deadbreak Connecting Plug
ELB-35-600-CP-AL*	35 kV	600	Aluminum Deadbreak Connecting Plug
ELB-15/28-900-CP-CU	15/28 kV	900	Copper Deadbreak Connecting Plug
ELB-35-900-CP-CU*	35 kV	900	Copper Deadbreak Connecting Plug

*Ordering Note: Add “-200” to the end of the part description to order 200 kV BIL-rated 35 kV connecting plug

Related Test Reports:
EDR-5511

te.com/energy

©2021 TE Connectivity. All Rights Reserved. EPP-2669-DDS-03/21-EN-AMS-Deadbreak-Plug-Raychem E372

TE Connectivity, TE connectivity (logo), EVERY CONNECTION COUNTS, AMP, AMPACT, Bowthorpe EMP, Crompton Instruments, Raychem, SIMEL, UTILUX are trademarks. Other logos, product and Company names mentioned herein may be trademarks of their respective owners. While TE has made every reasonable effort to ensure the accuracy of the information in this brochure, TE does not guarantee that it is error-free, nor does TE make any other representation, warranty or guarantee that the information is accurate, correct, reliable or current. TE reserves the right to make any adjustments to the information contained herein at any time without notice. TE expressly disclaims all implied warranties regarding the information contained herein, including, but not limited to, any implied warranties of merchantability or fitness for a particular purpose. The dimensions in this brochure are for reference purposes only and are subject to change without notice. Specifications are subject to change without notice. Consult TE for the latest dimensions and design specifications.

FOR MORE INFORMATION:
TE Technical Support Centers

USA/Canada:	+1 800-327-6996
Brazil:	+55 11-2103-6023
Mexico:	+52 55-1106-0800
South America:	+57 1-319-8962
Benelux:	+32 16-508-695
France:	+33 (0) 38-058-3210
Germany/Switzerland:	+49 (0) 89-608-9903
Italy:	+39 335-834-3453
Middle East/Africa:	+971 4-211-7020
Russia:	+7 495-790-790-2-200
Spain/Portugal:	+34 912-681-885
UK:	+44 08708-707-500
China:	+86 400-820-6015