

UTILUX BI-METAL ROTATING LUGS & LINKS BGS4HR & BKS4HR TYPE

KEY FEATURES

- The lug can be rotated to any desired position
- No voids when crimped
- No need to twist conductor to correct orientation
- Takes two crimps on the barrel without overlapping
- Minimum effort required to correctly orientate lug
- Palm will fit into most receptacles found in URD system
- Reduces total connection time
- Pre-filled with jointing compound

Utilux is a brand that has built an enviable reputation for high quality, reliable electrical connectors. For over 90 years, this dynamic Australian brand has been a leader in the field of interconnection systems.

Our aim is to provide the best possible products and services to keep our customers at the cutting edge of industry standards - internationally.

You can be sure that Utilux branded products are fabricated from the finest materials and produced to exacting tolerances. They represent the latest technology and the best design for the tasks they are required to perform.

Utilux is a leading brand of electrical connectors sold to original equipment manufacturers and electrical distribution companies throughout Australia, New Zealand and Asia. A comprehensive range, the most up to date production technology and the highest quality control standards ensure that there are Utilux connectors, of optimum reliability and durability, for all major power distribution applications.

As part of the worlds largest electrical connector company, TE Connectivity, the development of products is an ongoing commitment. It is done on a global basis, utilising the talents of many people throughout the organisation to ensure a global product for a local market.

Customers can count on consistent, high quality products, driven by TE's proven innovation and backed by our extraordinary customer support.

UTILUX BI-METAL ROTATING LUGS & LINKS



This range of connectors for aluminium 4 core sector cable features a unique concept enabling the lug to be rotated to any desired position on the conductor, without the need to round the conductor first. The design embodies the tried and proven round barrel/hex compression die combination, giving superior connection reliability.

LUG PRODUCT SELECTION INFORMATION

Catalogue Number	Conductor Area (mm ²)	Stud Size	Dimensions (mm)				
			A	B	C	D	F
BGS4HR240MB	240	MB	126	42	7	42	50
BGS4HR240M12	240	M12	126	42	7	42	50
BGS4HR240M16	240	M16	126	42	7	42	50

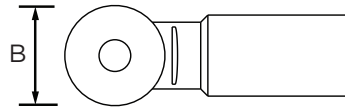
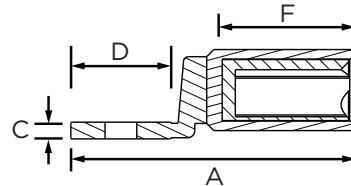

LINK PRODUCT SELECTION INFORMATION

Catalogue Number	Dimensions (mm)	Aluminium		Copper		
		A	Conductor Area (mm ²)	B	Conductor Area (mm ²)	C
BKS4HR240-150	110		240	60	150	50

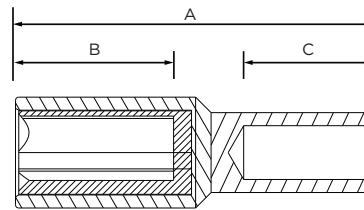

te.com/energy

©2016 TE Connectivity Ltd. family of companies. All Rights Reserved. EPP-2487-DDS28-AU-2/16

Utilux, TE Connectivity and TE Connectivity (logo) are trademarks. Other logos, product and/or company names might be trademarks of their respective owners. While TE has made every reasonable effort to ensure the accuracy of the information in this brochure, TE does not guarantee that it is error-free, nor does TE make any other representation, warranty or guarantee that the information is accurate, correct, reliable or current. TE reserves the right to make any adjustments to the information contained herein at any time without notice. TE expressly disclaims all implied warranties regarding the information contained herein, including, but not limited to, any implied warranties of merchantability or fitness for a particular purpose. The dimensions in this catalog are for reference purposes only and are subject to change without notice. Specifications are subject to change without notice. Consult TE for the latest dimensions and design specifications.

FOR MORE INFORMATION:

TE Customer Support Centers

NSW/QLD/NT/ACT:	+61 (2) 9554 2695
VIC/TAS/SA:	+61 (3) 9271 5243
WA:	+61 (8) 9358 7806
New Zealand:	+64 (9) 634 4580