



LIGHT-N-LOK STANDARD CONNECTORS

Compact Connector with Reliable Poke-in Wiring Technology

TE Connectivity (TE)'s 2 position LIGHT-N-LOK Standard connector provides a space-saving solution for indoor downlighting, connecting power to luminaire. Designed with limited space in mind, the low profile, UL/CSA 2459 compliant connector helps eliminate the hazard of electric shock and accepts 18 AWG – 22 AWG solid or tin-dipped stranded wires. It is designed for easy, tool-free installation and reduces mis-mating through its bump feature. The poke-in technology helps to allow for easy repair and is supported by dual contact surfaces and a metal stopper for reliability. Contacts are fully fixed in the housing and feature an additional lock bar for added dependability.

Specifications & Product Performance

Rate current (max):	18 AWG:	3A Max 3A certified by UL2459
	22 AWG:	4A Max
Rate voltage (max):		600 V AC Max
Dielectric strength:		2200 V AC
Operating Ambient Temperature Range:		-40°C to 105°C
Durability:		Upto 10 cycles
Housing:		P, UL 94 V-0
Contact:		Copper alloy with tin plating
Application Specification:		114-137020
Product Specification:		108-137020
UL2459 Approval:		308110
Part Numbers:	Plug:	2271180-1
	Receptacle:	2271183-1
	Mated Connector:	2271203-1

BENEFITS

- 2 position, poke-in wiring
- Compact design
- Tool-free installation
- Fits 18-22 AWG solid or tin- dipped stranded wires
- UL/CSA 2459 compliant
- EU RoHS/ELV compliant
- Bump feature helps to allow for easy mating/unmating
- Slim design for maximum Z direction space saving
- Dual contact surface design increases contact reliability
- Contacts are fully fixed in housing for high reliability
- Additional lock bar designed for enhanced retention

APPLICATIONS

- Indoor lighting, especially downlights
- Commercial lighting

LEARN MORE

- [View Products](#)
- [Landing Page](#)

LIGHT-N-LOK STANDARD CONNECTORS

DIMENSIONS

Plug (2271180-1):

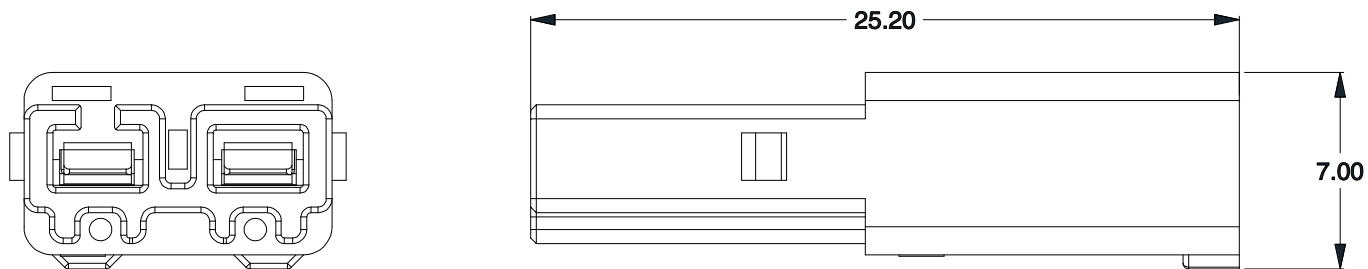

Receptable (2271183-1):

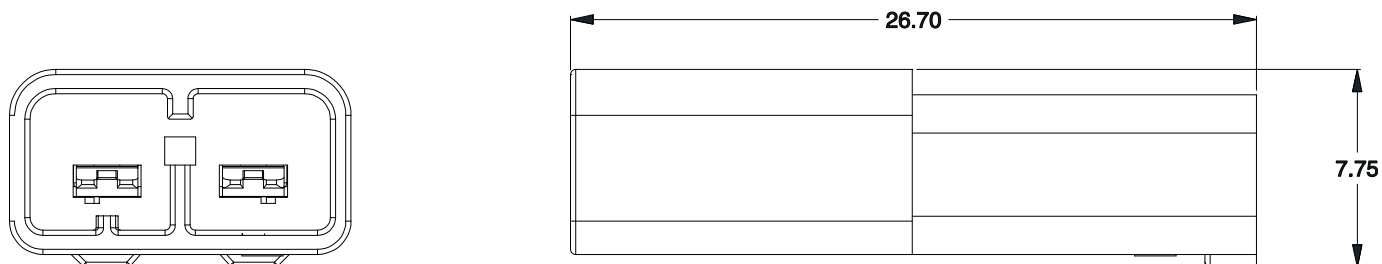

Mated Connector (2271203-1):

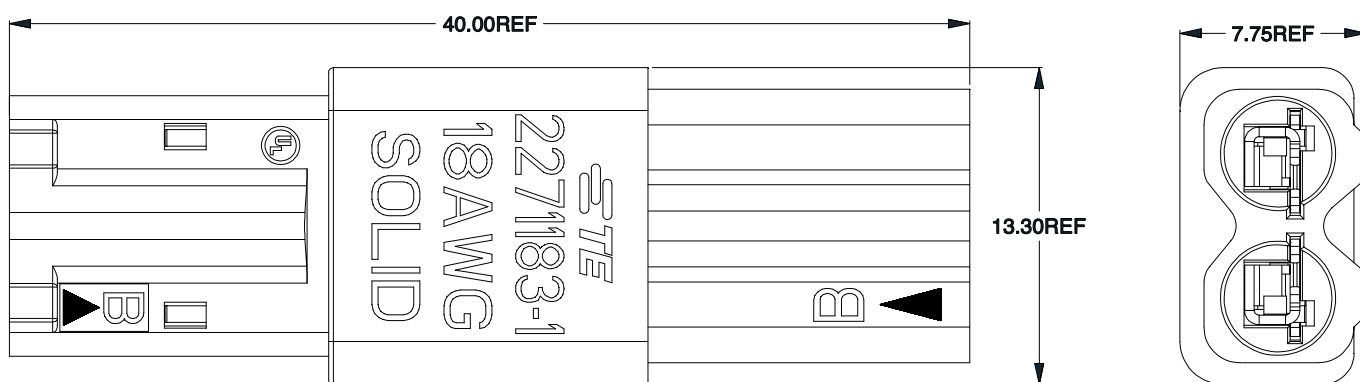

Connect With Us

We make it easy to connect with our experts and are ready to provide all the support you need.

Visit te.com/support to chat with a Product Information Specialist.

te.com/light-n-lok

LIGHT-N-LOK, TE, TE Connectivity, TE connectivity (logo), and EVERY CONNECTION COUNTS are trademarks owned or licensed by the TE Connectivity plc family of companies. Other product names, logos, and company names mentioned herein may be trademarks of their respective owners.

While TE has made every reasonable effort to ensure the accuracy of the information in this document, TE does not guarantee that it is error-free, nor does TE make any other representation, warranty or guarantee that the information is accurate, correct, reliable or current. TE reserves the right to make any changes to the information contained herein without prior notice. TE Connectivity's obligations shall only be as set forth in TE Connectivity's Standard Terms and Conditions of Sale for this product and in no case will TE Connectivity be liable for any incidental, indirect, or consequential damages arising out of the sale, resale, use, or misapplication of the product. TE expressly disclaims any implied warranties with respect to the information contained herein, including, but not limited to, implied warranties of merchantability or fitness for a particular purpose. Dimensions, specifications and/or information contained herein are for reference purposes only and are subject to change without notice. Consult TE for the latest dimensions, specifications and/or information. Users of TE Connectivity products must make their own assessment as to whether the respective product is suitable for the respective desired application.

©2025 TE Connectivity. All Rights Reserved.

05-25