

BLADE TERMINALS DIN 46 244-A6,3-0,8
 TERMINALS 30, 87, 87a COPPER TIN PLATED
 TERMINALS 85 AND 86 BRASS TIN PLATED
 CUT EDGES WITHOUT TIN PLATING ALLOWED.

DEGREE OF PROTECTION ACC. TO IEC529 = DIN 40 050 Teil 9

TERMINALS IP 20
 HOUSING IP 54
 IN CONNECTION WITH A CONNECTOR HOUSING
 MOUNTING POSITION: TERMINALS SHALL POINT DOWNWARDS
 FOR ALL OTHER POSITIONS PROTECTION GROUP IP 20 IS VALID

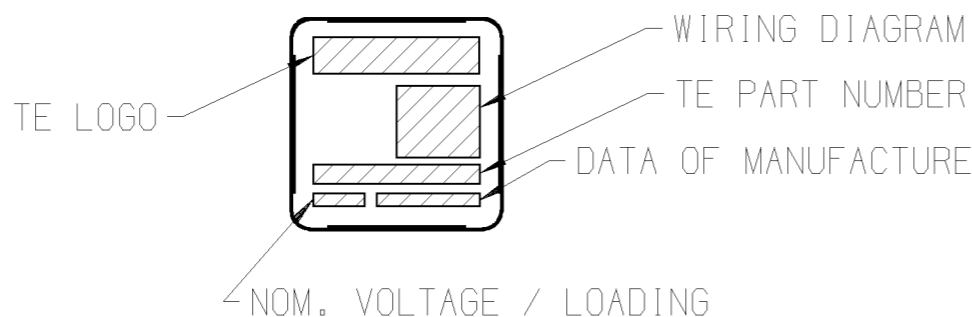
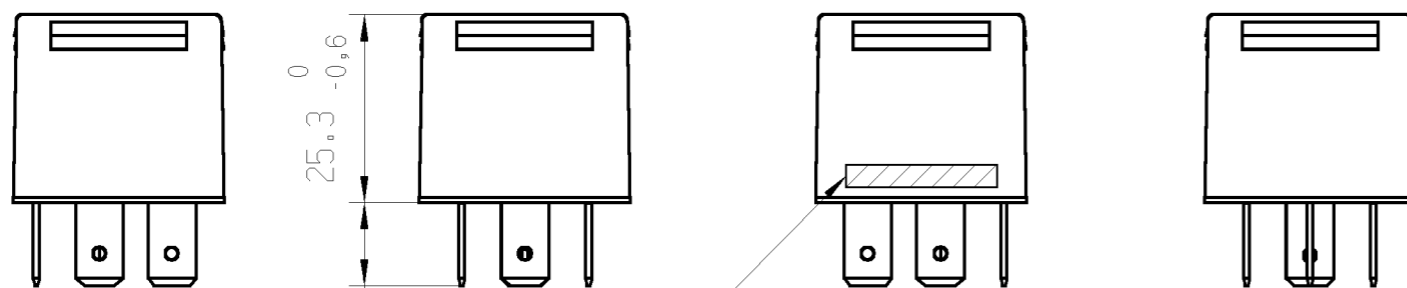
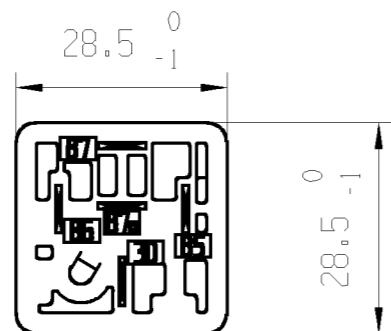

TERMINAL CONFIGURATION

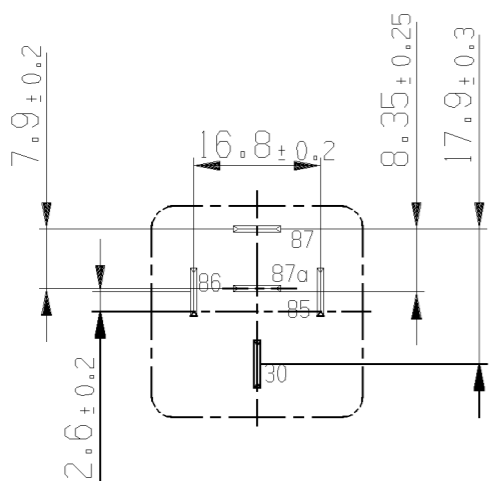

WIRING DIAGRAM

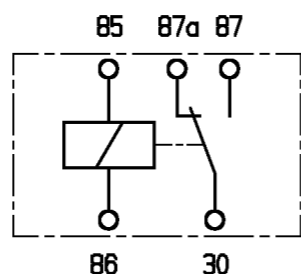

PART	MATERIAL	COLOUR
HOUSING	PA 66 GF 30± 10 [%]	BLACK
BASE PLATE	PA 66 GF 30± 10 [%]	BLACK

OBSOLETE BOSCH P/N	TE P/N	REV	PART NUMBER	CUSTOMER P/N
0 332 209 156	0-1904020-7		V23234-A0001-X040	12033862
	1-1904020-7			
	2-1904020-7			
	3-1904020-7			
	4-1904020-7			
	5-1904020-7			
	6-1904020-7			
	7-1904020-7			
	8-1904020-7			

PROPRIETARY THE REPRODUCTION, TRANSMISSION OR USE OF THIS DOCUMENT OR IT'S CONTENTS IS NOT PERMITTED WITHOUT EXPRESSED WRITTEN AUTHORITY. OFFENDERS WILL BE LIABLE FOR ALL DAMAGES. ALL RIGHTS, INCLUDING RIGHTS CREATED BY REGISTERED PATENT(S) GRANTED FOR A UTILITY MODEL OR DESIGN, ARE RESERVED.			CHANGES TO THIS DRAWING MUST BE DONE ONLY IN CAD	PAPER SIZE A3
APPLICABLE SPEC.:			FINISH	
TOLERANCE UNLESS SPECIFIED OTHERWISE			DIMENSIONS APPLY	PLATING
DIMENSIONS IN MM			SCALE 1:1	WEIGHT Ca. 34g
DATE NAME DWN. 2006-06-05 P. Tomas			PART NAME MINI RELAY B CHANGEOVER 12V 20/30A	
DATE NAME A1 -- 2006-11-13 --			PART NO. V23234-A0001-X040	
DATE NAME A -- 2006-09-11 --			SHT. 1	
REV. CHANGE ORDER DATE APP.			CUSTOMER DRAWING V23234-A0001-X040	
			OF 2	



Nominal voltage (load and excitation circuit) 12 V
 Permissible operating voltage 8...16 V
 Permissible ambient temperature -40...100 ° C
 Response voltage (at 20 ° C) ≤ 8 V
 Release voltage (at 20 ° C) 1.2...5.0 V
 Response time ≤ 10 ms
 Release time ≤ 10 ms
 Contact material Silver based
 Equivalent coil resistance at terminal 85-86 85± 5Ω
 Voltage drop at blade terminals at a measuring current of 10± 0.5A
 Normally Open Contact, Terminal 30-87
 In new condition Typically ≤ 80mV, Max. 300mV
 After life test Typically ≤ 150mV, Max. 300mV
 Normally Closed Contact, Terminal 30-87a
 In new condition Typically ≤ 100mV, Max. 300mV
 After life test Typically ≤ 150mV, Max. 300mV

12 V
 8...16 V
 -40...100 ° C
 ≤ 8 V
 1.2...5.0 V
 ≤ 10 ms
 ≤ 10 ms
 Silver based
 85± 5Ω

Typically ≤ 80mV, Max. 300mV
 Typically ≤ 150mV, Max. 300mV
 Typically ≤ 100mV, Max. 300mV
 Typically ≤ 150mV, Max. 300mV

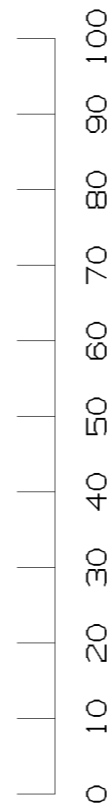

PROPRIETARY THE REPRODUCTION, TRANSMISSION OR USE OF THIS DOCUMENT OR IT'S CONTENTS IS NOT PERMITTED WITHOUT EXPRESSED WRITTEN AUTHORITY. OFFENDERS WILL BE LIABLE FOR ALL DAMAGES. ALL RIGHTS, INCLUDING RIGHTS CREATED BY REGISTERED PATENT(S) GRANTED FOR A UTILITY MODEL OR DESIGN, ARE RESERVED.				CHANGES TO THIS DRAWING MUST BE DONE ONLY IN CAD		PAPER SIZE A3	
APPLICABLE SPEC. #				FINISH			
				DIMENSIONS APPLY		PLATING	
				TOLERANCE UNLESS SPECIFIED OTHERWISE		DIMENSIONS IN MM	
				SCALE 1:1		WEIGHT Ca. 34g	
				MATERIAL			
				PART NAME			
				MINI RELAY B CHANGEOVER 12V 20/30A			
				PART NO.			
				V23234-A0001-X040			
				SHT. 2 OF 2			
REV. CHANGE ORDER				DATE		APP.	
CUSTOMER DRAWING							

