

All terminals tinned. Tin height from stand-off 0.3mm max. (except for coil terminals, already pre-tinned)

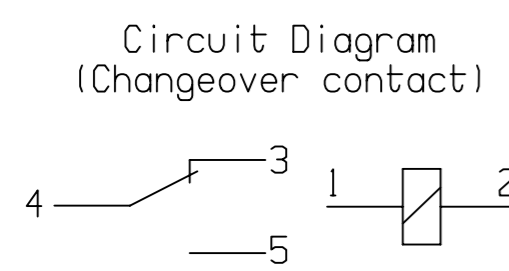

Mounting Hole Layout (Bottom view on solder pins)

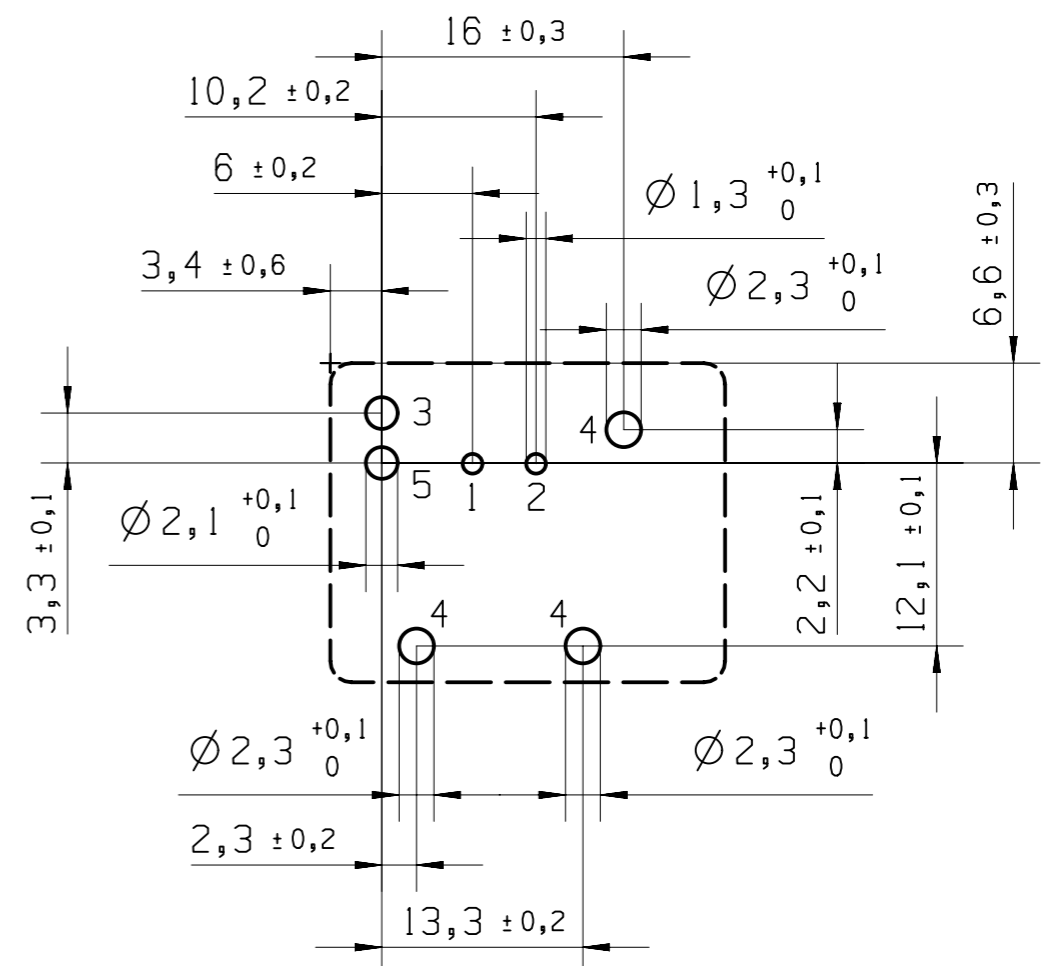

- 1) Stand-off
- 2) Assembly and positioning aid
- 3) Area free of components or pcb tracks
- 4) Length of terminals without tin. With tin max. 5mm.

Pin layout compatible with V23133-A...

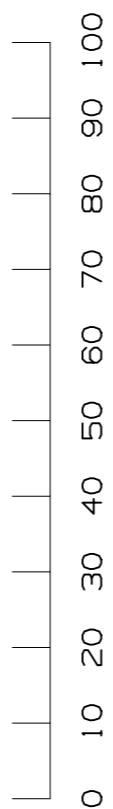

PROPRIETARY THE REPRODUCTION, TRANSMISSION OR USE OF THIS DOCUMENT OR IT'S CONTENTS IS NOT PERMITTED WITHOUT EXPRESSED WRITTEN AUTHORITY. OFFENDERS WILL BE LIABLE FOR ALL DAMAGES. ALL RIGHTS, INCLUDING RIGHTS CREATED BY REGISTERED PATENT(S) GRANTED FOR A UTILITY MODEL OR DESIGN, ARE RESERVED.			CHANGES TO THIS DRAWING MUST BE DONE ONLY IN CAD	PAPER SIZE A3	
APPLICABLE SPEC.:			FINISH		
TOLERANCE UNLESS SPECIFIED OTHERWISE		DIMENSIONS IN MM	DIMENSIONS APPLY	PLATING	
SCALE		2:1	WEIGHT		
MATERIAL					
PART NAME					
Power Relay K Sealed Dimension drawing CO					
DWG NO. C23303-A0076-A021-CD			SHT. 1 OF 1		
REV. CHANGE ORDER	DATE	APP.			

REV.	CHANGE ORDER	DATE	APP.	DATE	NAME
A1	ECO-18-001561	30JAN2018	JFai	90-11-15	J.Dias
A	ECO-16-016933	2016-11-23	JFai		
05	WE01/A001	2000-10-27	Fai		
04	WE97/A004	1997-06-11	Fai		
03	WR95/A136	1995-05-15	Fai		
02	WR92/A054	1992-01-06	JD		