

DRAWING MADE IN AMERICAN PROJECTION

©1969 BY AMP INCORPORATED. ALL RIGHTS RESERVED. AMP PRODUCTS COVERED BY PATENTS AND/OR PATENTS PENDING.

THIS PRODUCT DESIGNED AND BUILT BY AMP INCORPORATED. NO LICENSE TO USE THAT DESIGN IN MANUFACTURE, OR TO USE ANY ISSUED OR PENDING PATENTS WHICH ARE INVOLVED, IS IMPLIED.

REVISIONS				
ZONE	LTR	DESCRIPTION	DATE	APPROVED
A		REV PER ECN 2425	6-16-70	Ken K.
B		REVISED NOTE 1	10-17-73	JPA
C		UP-DATED ECN 8354	8-11-78	Y.M.S.
D		REV PER ECN S-3960	4-13-87	R.B.
E		OBS-2 ECN OF 0376	2-89	T.W.

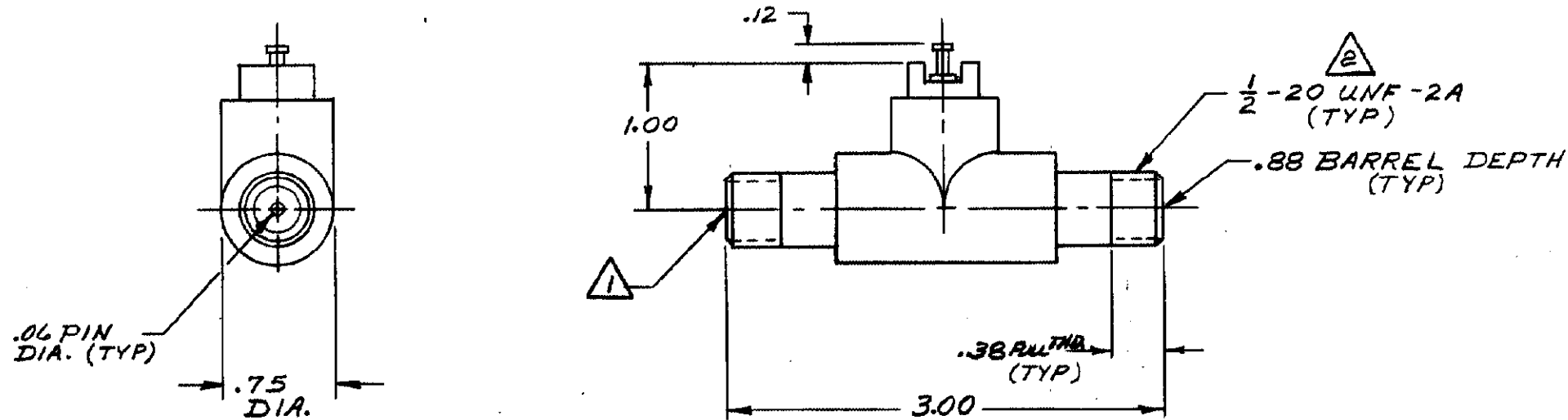

1. RECEPTACLE TO MATE WITH AMP LGH - 1 LEAD ASSEMBLY, AVAILABLE SEPARATELY.

2. PER FEDERAL STANDARD H-28 3 WIRE METHOD. DIMENSION OVER WIRES TO BE 1.497-.510.

OBS	849682-2	AS SHOWN WITH GOLD PLATED PIN
	849682-1	AS SHOWN WITH TIN PLATED PIN

QTY REQD	QTY REQD	ITEM NO.	DWG SIZE	PART OR IDENTIFYING NO.	NOMENCLATURE OR DESCRIPTION	SYMBOL
-2	-1					

**AMPS** AMP INCORPORATED  
CAPITRON DIVISION  
ELIZABETHTOWN, PENNSYLVANIA

NAME: "T" RECEPTACLE LGH-1

SIZE: B CODE IDENT NO.: 89110 NUMBER: 849682

SCALE: 1-1 WT SHEET: 1 OF 1

UNLESS OTHERWISE SPECIFIED: DIMENSIONS ARE IN INCHES TOLERANCES .00 ± .04 ANGLES .000 ± .015				CONTRACT NO. DR 5-6-69 CHK
MATERIAL: MOLDED GLASS EPOXY				APPD Ken K 5-16-69 APPD
FINISH: BLACK				DSGN APPD OTHER APPD
NEXT ASSY	FINAL ASSY	NEXT ASSY	USED ON	
QTY REQD		APPLICATION		