

LOC	DIST	REVISIONS					
		P	LTR	DESCRIPTION	DATE	DWN	APVD
—	—		2	CAD-NEUERSTELLUNG	14.05.90	A.HO	—
			3	REV PER ECO-10-002990	13FEB10	KK	HMR
			4	ECR-10-025774	18JAN11	KK	HMR

POLZ.	L±0.5	BESTELL-NR.
1	3.3	826 540 -1
2	7.3	—
3	11.3	—
4	15.2	—
5	19.2	—
6	23.1	—
7	27.1	—
8	31.1	—
9	35.1	—
10	39.0	—
11	43.0	—
12	46.9	—
13	50.9	—
14	54.8	—
15	58.8	—
16	62.8	—
17	66.7	—
18	70.7	—
19	74.7	—
20	78.6	—
21	82.6	—
22	86.5	—
23	90.5	—
24	94.4	—
25	98.4	—
26	102.4	—
27	106.3	—
28	110.3	—
29	114.2	—
30	118.2	—
31	122.2	—
32	126.1	—
33	130.1	—
34	134.0	—
35	138.0	—
36	141.6	826 540 -6

ZEICHNUNG GÜLTIG AB 20/90

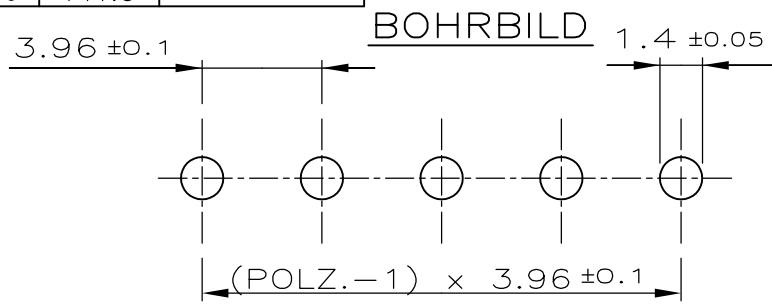
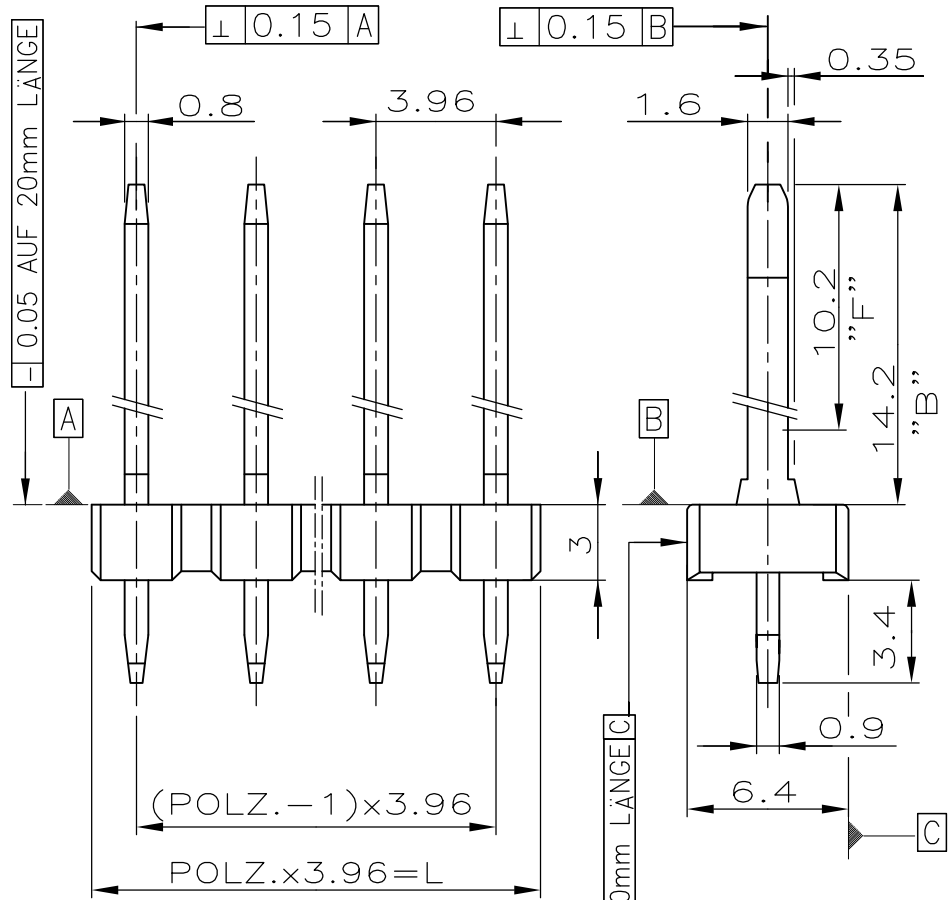

- 1 STECKSEITE: IM BEREICH "F" 0.8µm GOLD ÜBER 1.27 µm NICKEL IM BEREICH "B"
- 2 LÖTSEITE: MIN. 2.5 µm ZINN ÜBER 1.27 µm NICKEL
- 3 OBSOLETE PARTS: OBSOLETE CIS STREAMLINING PER D.RENAUD/D.SINISI
- 4 OBSOLETE

KONTAKTSTIFT	Cu Sn	1
STIFTGEHÄUSE	PBT-GV	GRÜN
BENENNUNG	WERKSTOFF	OBERFLÄCHE FARBE

THIS DRAWING IS UNPUBLISHED. ALL RIGHTS RESERVED. RELEASED FOR PUBLICATION BY -

DIMENSIONS: mm	DWN	23.11.84	MATERIAL	—	FINISH	—				
	CHK	24.01.85	TE Connectivity							
TOLERANCES UNLESS OTHERWISE SPECIFIED: ±0.3mm	APVD	—								
0 PLC ± - 1 PLC ± - 2 PLC ± - 3 PLC ± - 4 PLC ± - ANGLES ± -	PRODUCT SPEC	—	NAME AMPMODU I STIFTL. RASTER 3.96 EINREIHIG							
	APPLICATION SPEC	—								
	WEIGHT	—	SIZE	A4	CAGE CODE	00779	DRAWING NO	C-826540	RESTRICTED TO	—
	CUSTOMER DRAWING			SCALE	4:1	SHEET	1 OF 1	REV	4	