

LOC
FH

DIST
2

REVISIONS					
P	LTR REV	DESCRIPTION MODIFICATIONS	DATE	DWN DESS.	APVD APP.
	I	CREATION	27MAR2007	FB	AG
	A	TIGHTENING TORQUE MODIFICATION	03FEB2009	LP	GS

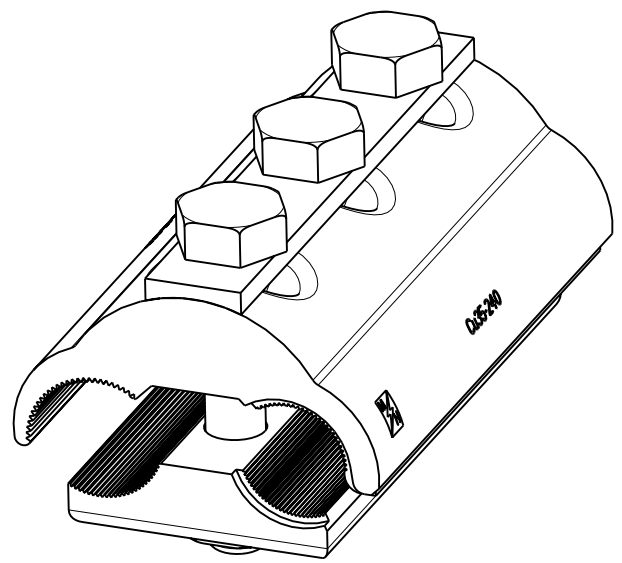
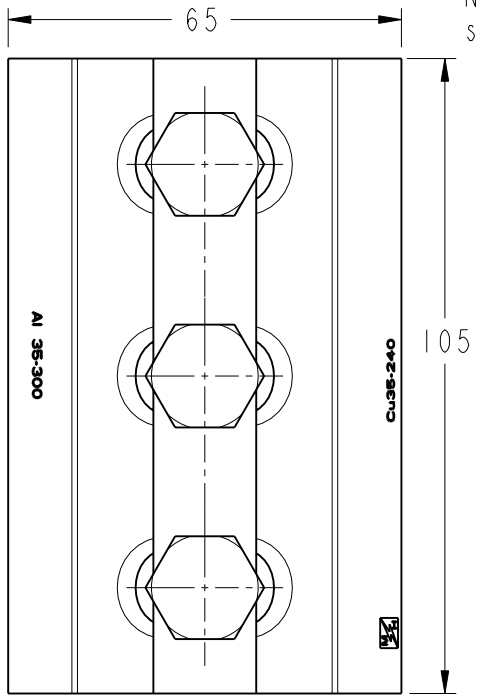
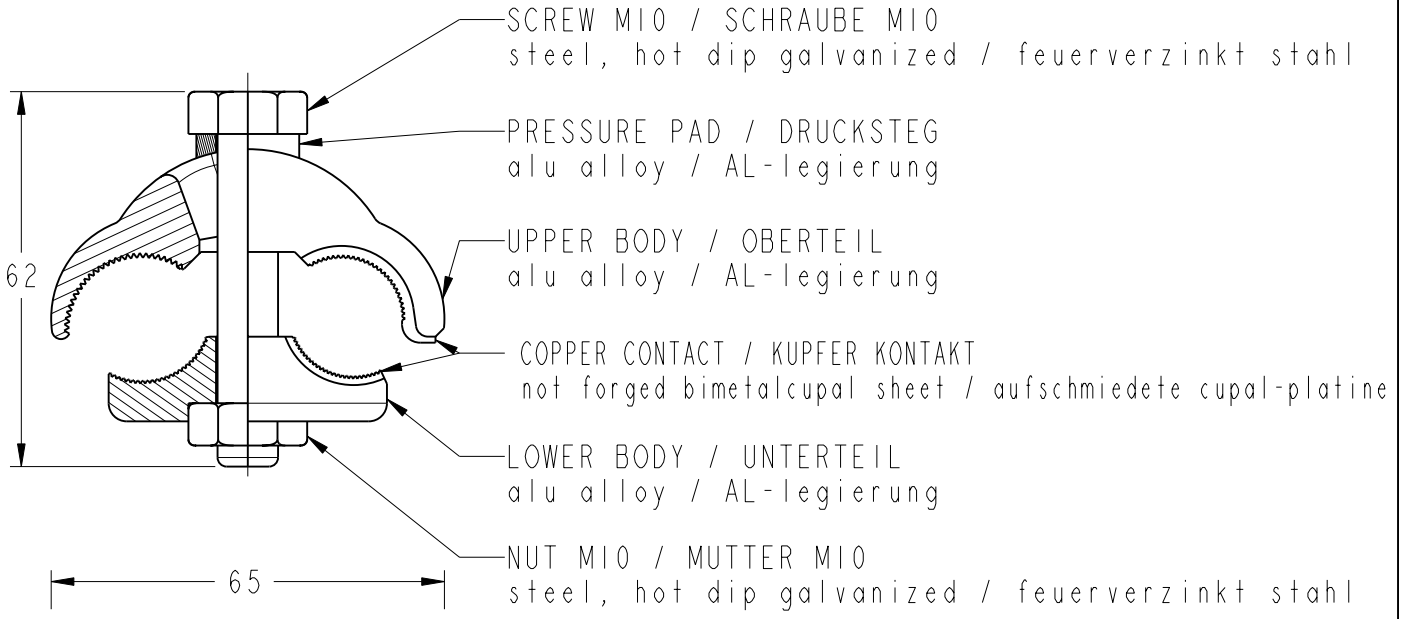

Capacity / Klemmbereich : 35-300 mm² AL
 35-240 mm² CU
 35/6-265/35 mm² AL/St
 Tightening torque / Anzugsmoment : 44 N.m

TOLERANCES UNLESS OTHERWISE SPECIFIED:	-
TOLERANCES NON SPECIFIEES:	-
FINISH FINITION	-

DIMENSIONS:	mm
TOLERANCES UNLESS OTHERWISE SPECIFIED: TOLERANCES NON SPECIFIEES (SUIVANT DE DECIMALES):	
0 PLC / DEC:	±0
1 PLC / DEC:	±0.1
2 PLC / DEC:	±0.2
3 PLC / DEC:	±0.3
4 PLC / DEC:	±0.4
ANGLES	±

DWN / DESSINE	03FEB2009
L. PETRIGNET	
CHK / VERIFIE	-
M. DOLLING	
APVD / APPROUVE	-
G. SCHWEIZER	
PRODUCT SPEC	-
SPEC. PRODUIT	
APPLICATION SPEC	-
SPEC. APPLICATION	
WEIGHT	- g
MASSE APPROX.	

MATERIAL MATIERE	-
Tyco Electronics SIMEL PRODUCTS	
NAME TITRE	HEL-3915
SIZE FORMAT	A4
CAGE CODE	-
DRAWING NO No PLAN	C-8-1198992-8
RESTRICTED TO RESERVE A	-

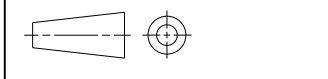

CUSTOMER DRAWING / PLAN CLIENT	UNIQUEMENT POUR REFERENCE	SCALE ECHELLE 1:2	SHEET FEUILLE 1	OF DE 1	REV A
--------------------------------	---------------------------	-------------------	-----------------	---------	-------

20
 RELEASED FOR PUBLICATION
 LIBRE A LA DIFFUSION

THIS DRAWING IS UNPUBLISHED.
 DIFFUSION RESTREINTE
 BY TYCO ELECTRONICS CORPORATION ALL RIGHTS RESERVED.
 © COPYRIGHT 2009 BY TYCO ELECTRONICS CORPORATION. TOUS DROITS RESERVES.