

4

3

2

1

THIS DRAWING IS UNPUBLISHED.

RELEASED FOR PUBLICATION

© COPYRIGHT - TE Connectivity Ltd.

ALL RIGHTS RESERVED.

REVISIONS

| P | LTR | DESCRIPTION               | DATE      | DWN | APVD |
|---|-----|---------------------------|-----------|-----|------|
| D |     | REVISED PER ECR-17-018325 | 03JAN2018 | BDA | SG   |

D

D

C

C

B

B

A

A

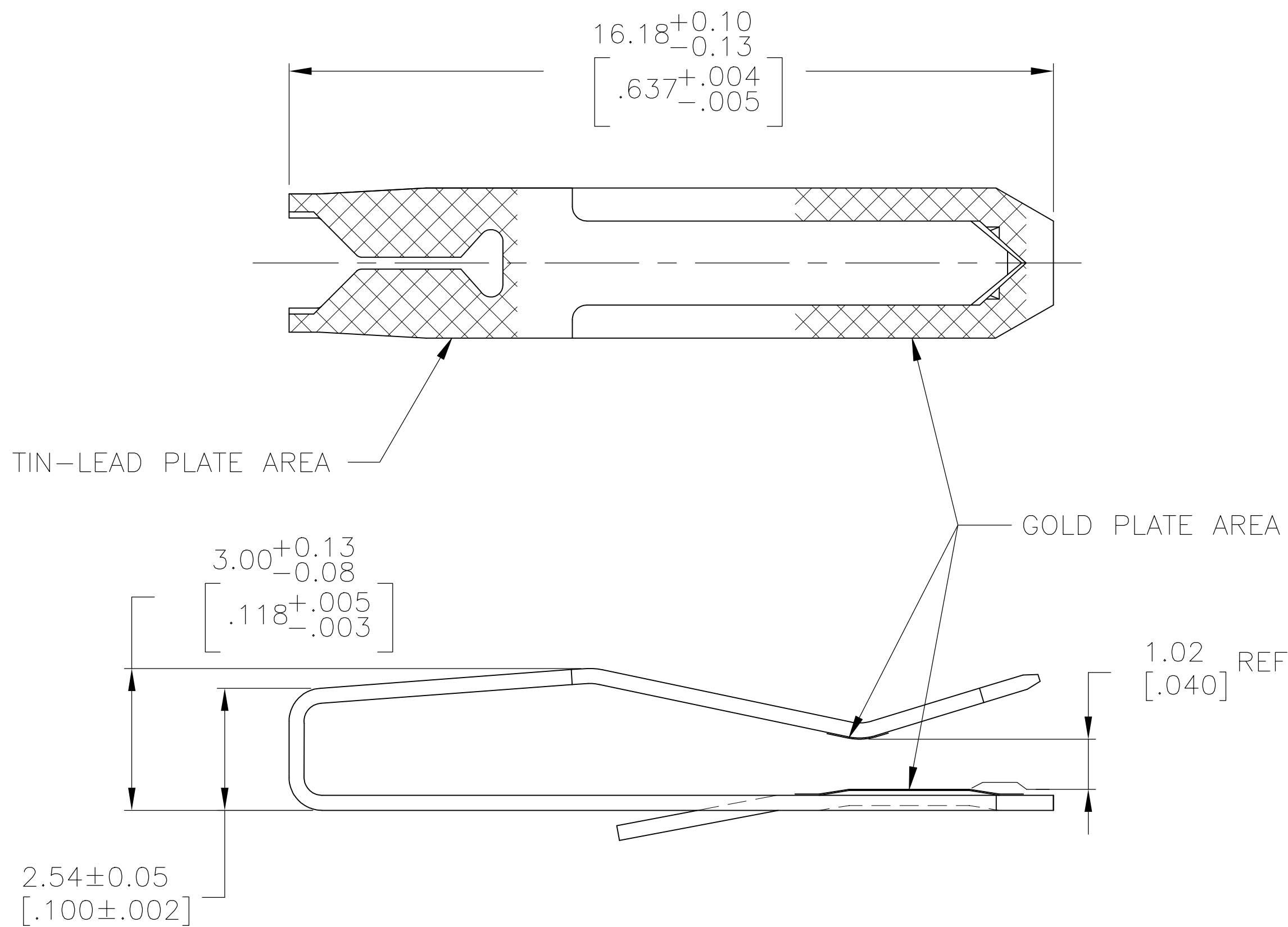

- DIMENSIONS IN BRACKETS ARE IN INCHES.
- 0.00038 [.000015] MIN THICK GOLD IN THE GOLD PLATE AREA OVER 0.00127 [.000050] MIN THICK NICKEL.
- 0.00076 [.000030] MIN THICK GOLD IN THE GOLD PLATE AREA OVER 0.00127 [.000050] MIN THICK NICKEL.
- 0.00203 [.000080] MIN THICK TIN-LEAD IN THE TIN-LEAD PLATE AREA OVER 0.00127 [.000050] MIN THICK NICKEL.
- MATTE TIN 0.00203(.000080) MIN THICK IN TIN PLATED AREA
- OBSOLETED

|        |    |          |          |
|--------|----|----------|----------|
| △3     | △5 | 641147-4 |          |
| △2     | △5 | 641147-3 |          |
| △6     | △3 | △4       | 641147-2 |
| △6     | △2 | △4       | 641147-1 |
| FINISH |    | PART NO  |          |

|  |  |                         |  |                     |
|--|--|-------------------------|--|---------------------|
| THIS DRAWING IS A CONTROLLED DOCUMENT. |  | DWN BSV 25OCT2005       | <b>TE</b> TE Connectivity                                    |                     |
| DIMENSIONS: mm [INCHES]                |  | CHK D. BOSSI 25OCT2005  |  |                     |
| TOLERANCES UNLESS OTHERWISE SPECIFIED: |  | APVD D. BOSSI 25OCT2005 | NAME CONTACT, GOLD STRIPE, 26 AWG WIRE, LOOSE PIECE, MTA 156 |                     |
| 0 PLC ± -                              |  | PRODUCT SPEC            | SIZE A3  |                     |
| 1 PLC ± -                              |  | APPLICATION SPEC        | CAGE CODE 00779  | DRAWING NO C=641147 |
| 2 PLC ± -                              |  | WEIGHT                  | RESTRICTED TO  |                     |
| 3 PLC ± 0.13 [.005]                    |  | CUSTOMER DRAWING        | SCALE 8:1  | SHEET 1 OF 1        |
| 4 PLC ± -                              |  |                         | REV D  |                     |
| ANGLES ± -                             |  |                         |  |                     |
| MATERIAL 0.30 [.012] THK COPPER ALLOY  |  |                         |  |                     |
| FINISH SEE TABLE                       |  |                         |  |                     |