

PROPERTY OF DEUTSCH E.C.D.

This drawing contains proprietary information that shall not be disclosed, duplicated, nor used in whole or in part for any purpose other than to evaluate this drawing.

N/C 6162-353-1231

REVISIONS		DATE	APPROVED
REV	DESCRIPTION		
N/C	NEW RELEASE PER E.O. C6392	05/08	A.R.

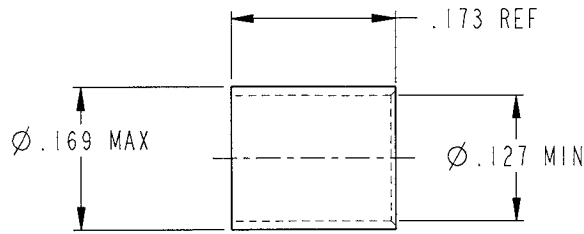

CRIMP FERRULE

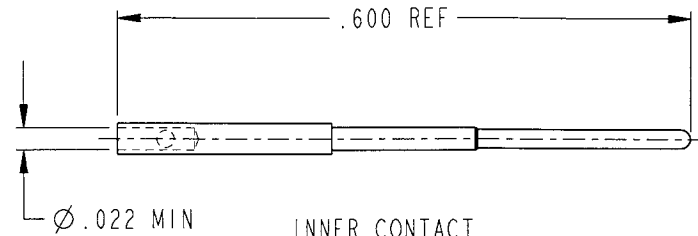

INNER CONTACT

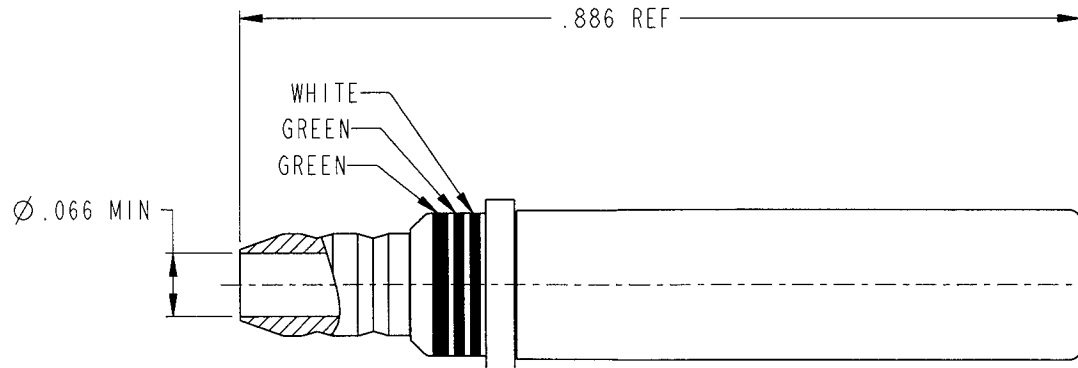

OUTER CONTACT

5. THIS PART NUMBER WILL SHIP (50) 6162-325-1231 CONTACTS BULK AND 5 INSTRUCTION FORMS.
4. THIS COAXIAL CONTACT WILL MEET THE CABLE SIZES IN MIL-C-39029/102 AND /103.
3. FINISH - CONTACT BODIES & FERRULE: GOLD PLATED
SLEEVE: PASSIVATED
2. MATERIAL - CONTACT BODIES & FERRULE: COPPER ALLOY
SLEEVE: STAINLESS STEEL
1. DIMENSIONS ARE IN INCHES UNLESS OTHERWISE SPECIFIED.

**FOR SALE ONLY
TO WOVEN**

SIGNATURE & DATE		CONTACT SOCKET ASSEMBLY SIZE 12 COAX 38999 TYPE MIL-C-39029/103-559 ENVELOPE	CP	MATL CODE
DR	D.WHITACRE 11/2/2005		DEUTSCH ENGINEERED CONNECTING DEVICES	
CHK	A.R. 05/08		5733 W. Whittier Ave. Hemet, California	
PE	D.WHITACRE 11/2/2005		A	6162-353-1231
APPD	11/6/05			CODE 11139
SCALE	1:000			