

© - TE Connectivity. All Rights Reserved.

REVISIONS				
P	LTR	DESCRIPTION	DATE	APVD
	A	INITIAL RELEASE	22DEC2023	G.C H.L

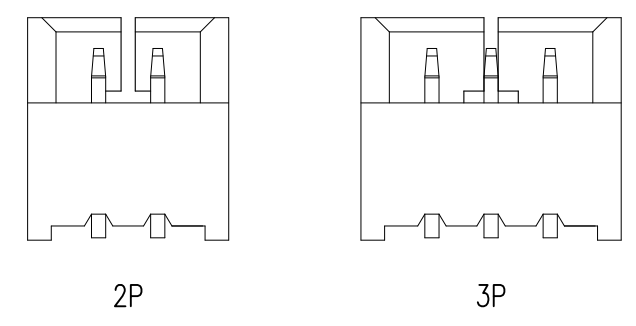

- NOTES:
- 1,Current Rating: 1.0A
 - 2,Contact Resistance: 20mΩ Max
 - 3,Withstand Voltage: 500V AC
 - 4,Insulation Resistance: 100MΩ Min
 - 5,Operation Temperature: -25°C to +85°C
 - 6,Housing: High temperature thermoplastic, UL94V-0, Natural
 - 7,Contact: Brass
100u" Matte tin over 50u" nickel

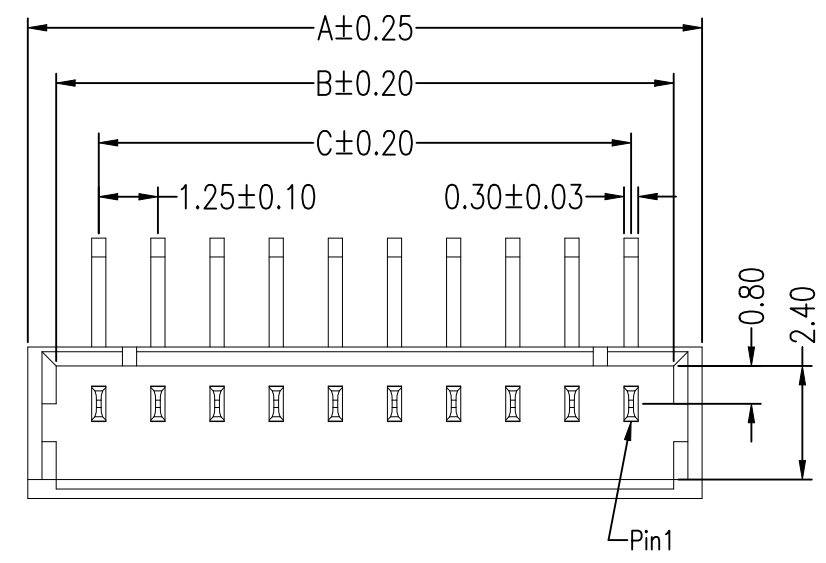
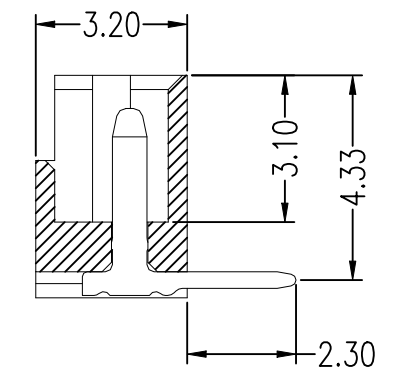
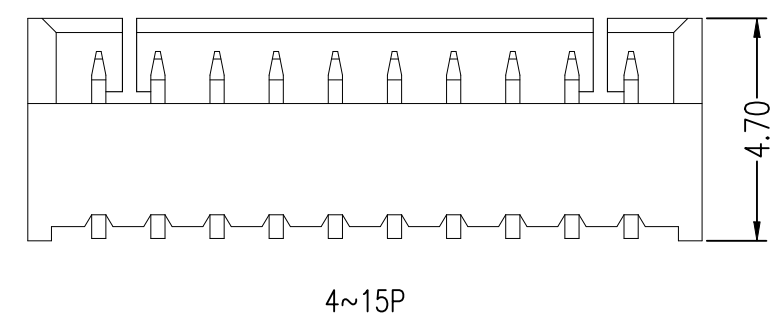

15	20.50	19.30	17.50	1-2473249-5
14	19.25	18.05	16.25	1-2473249-4
13	18.00	16.80	15.00	1-2473249-3
12	16.75	15.55	13.75	1-2473249-2
11	15.50	14.30	12.50	1-2473249-1
10	14.25	13.05	11.25	1-2473249-0
9	13.00	11.80	10.00	2473249-9
8	11.75	10.55	8.75	2473249-8
7	10.50	9.30	7.50	2473249-7
6	9.25	8.05	6.25	2473249-6
5	8.00	6.80	5.00	2473249-5
4	6.75	5.55	3.75	2473249-4
3	5.50	4.30	2.50	2473249-3
2	4.25	3.05	1.25	2473249-2
PINS	DIM A	DIM B	DIM C	PN

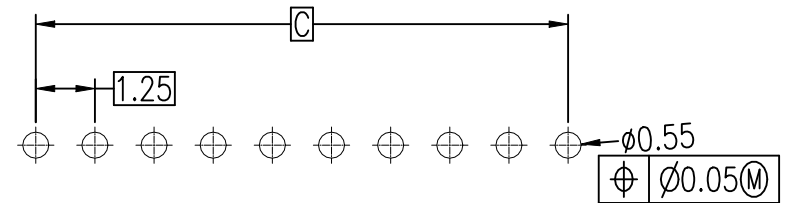

RECOMMENDED P.C.B LAYOUT
(COMPONENT SIDE)(TOLERANCE:±0.05)

THIS DRAWING IS A CONTROLLED DOCUMENT.		DWN GOWTHAM 22DEC23	TE Connectivity	
DIMENSIONS: mm		CHK CONNOR KANG		
TOLERANCES UNLESS OTHERWISE SPECIFIED:		APVD HOPE LU 22DEC23	NAME 1.25MM PITCH,WIRE TO BOARD CONNECTOR HEADER, R/A, DIP TYPE	
0 PLC ± - 1 PLC ± - 2 PLC ± 0.25 3 PLC ± - 4 PLC ± - ANGLES ± -		PRODUCT SPEC 108-161193	RESTRICTED TO	
MATERIAL		APPLICATION SPEC 114-160812	SIZE A3	CAGE CODE 00779
FINISH		WEIGHT 0	DRAWING NO C-2473249	SCALE 1:1
CUSTOMER DRAWING			SHEET 1 of 2	REV A

REVISIONS					
P	LTR	DESCRIPTION	DATE	DWN	APVD
-	-	SEE SHEET 1	-	-	-



Product placement diagram

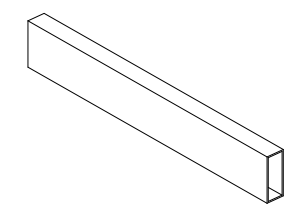

No: 1

Put the product into the vacuum tube
SG-C72(600*9.5*5.5mm)

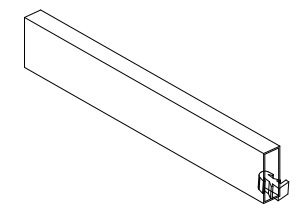

No: 2

Place the plastic plug

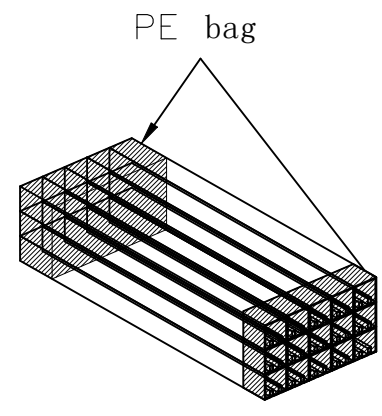

PE bag

No: 3

20 tubes for a tie,
use PE film to fix the two ends of
each tie vacuum tube and the middle,

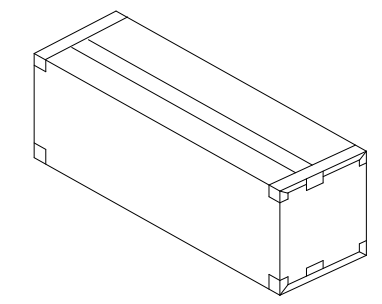

No: 5

Put the vacuumed products into the inner box.
(12 ties/box) and seal the box.
box specification: CTN-10ATE(63*15*17CM)

Instructions:

1. Place the product into the vacuum tube as per the product placement diagram;
2. Pay attention to the style of each label. Position and direction of consistency;
3. When playing the outer box packing tape need to pay attention to, play for the cross type.

Large transparent adhesive

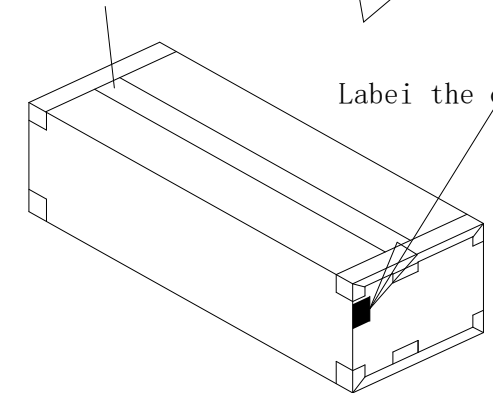

Label the outer box

No: 7

Seal the box and stick the
label on the top left corner
of the side of the outer box

TE P/N	PCS/Tube	PCS/Box
2473249-2	136	32640
2473249-3	105	25200
2473249-4	85	20400
2473249-5	72	17280
2473249-6	62	14880
2473249-7	55	13200
2473249-8	49	11760
2473249-9	44	10560
1-2473249-0	40	9600
1-2473249-1	37	8880
1-2473249-2	34	8160
1-2473249-3	32	7680
1-2473249-4	30	7200
1-2473249-5	25	6000

THIS DRAWING IS A CONTROLLED DOCUMENT.		DWN GOWTHAM 22DEC23	TE Connectivity		
DIMENSIONS: mm		CHK CONNOR KANG			
TOLERANCES UNLESS OTHERWISE SPECIFIED:		PRODUCT SPEC		APPLICATION SPEC	RESTRICTED TO
0 PLC ± - 1 PLC ± - 2 PLC ± 0.25 3 PLC ± - 4 PLC ± - ANGLES ± -		WEIGHT 0		SIZE A3	CAGE CODE 00779
MATERIAL -		FINISH -		DRAWING NO C-2473249	
CUSTOMER DRAWING			SCALE 1:1	SHEET 2 OF 2	REV A