

THIS DRAWING IS UNPUBLISHED. RELEASED FOR PUBLICATION 20  
 © COPYRIGHT 20 BY - ALL RIGHTS RESERVED.

LOC	DIST	REVISIONS					
AD	00	P	LTR	DESCRIPTION	DATE	DWN	APVD
		A1		REVISED PER ECO-10-001873	19FEB2010	DH	JE
		B		REVISED PER ECO-12-005533	23MAR2012	JY	AC
		C		REVISED PER ECO-13-001969	31MAY2013	RG	AC

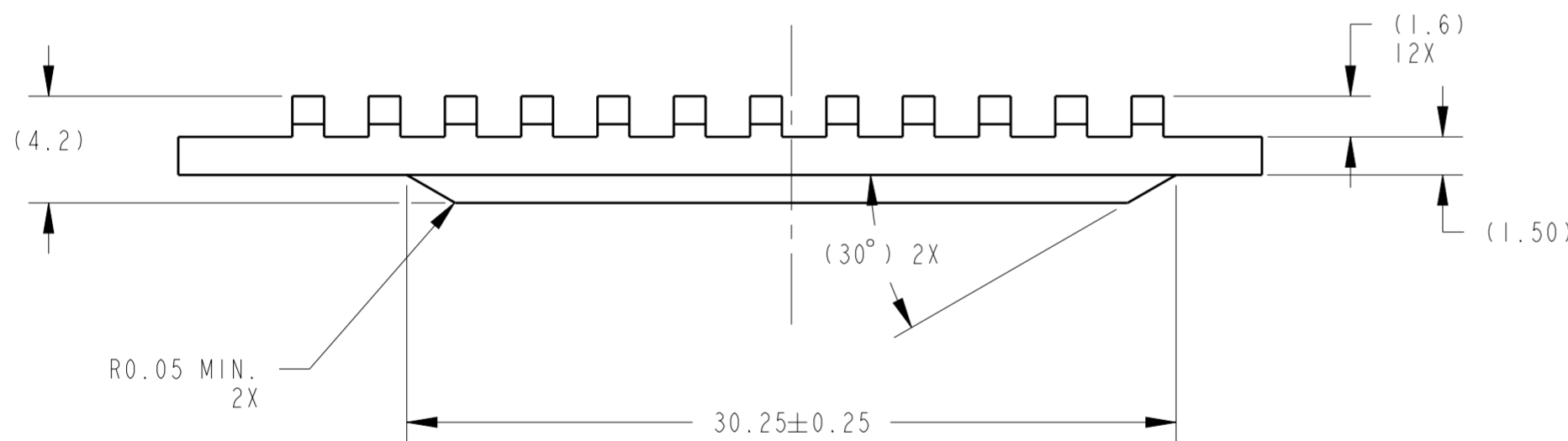
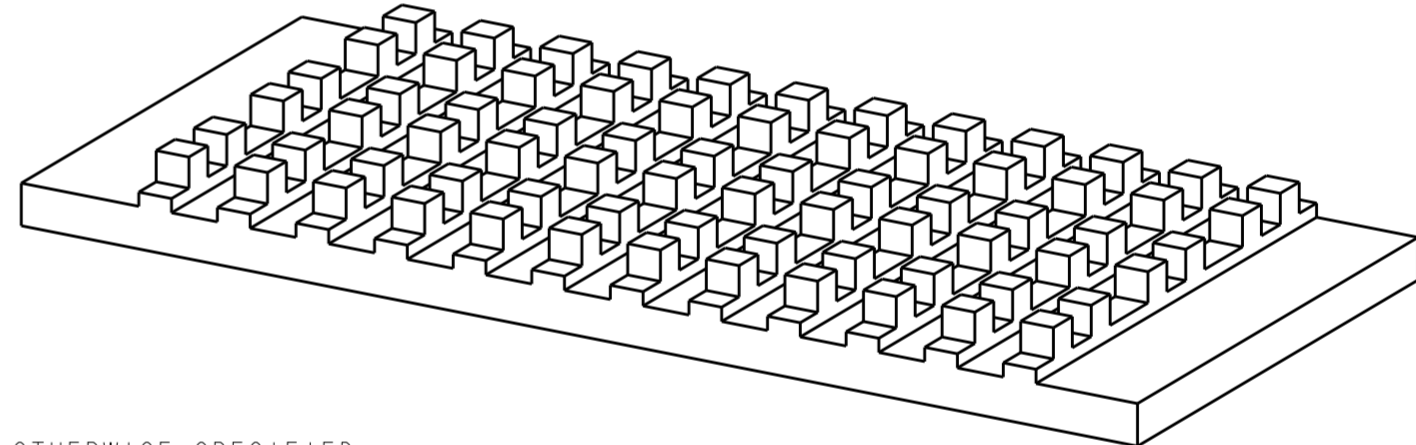
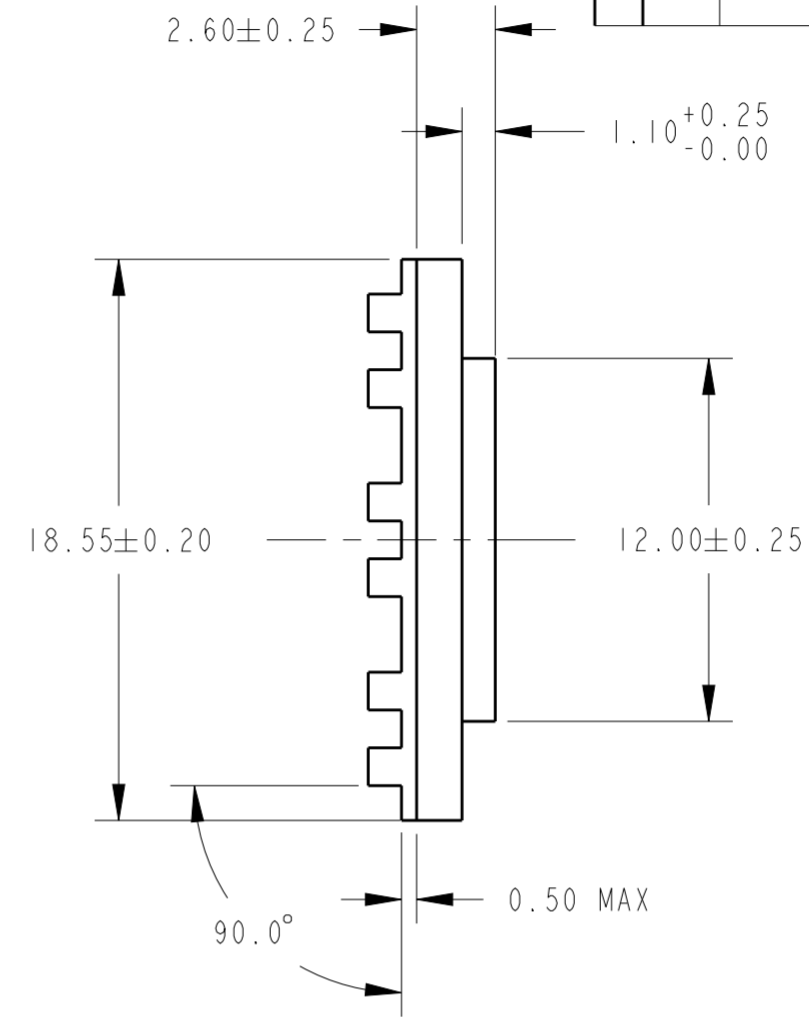
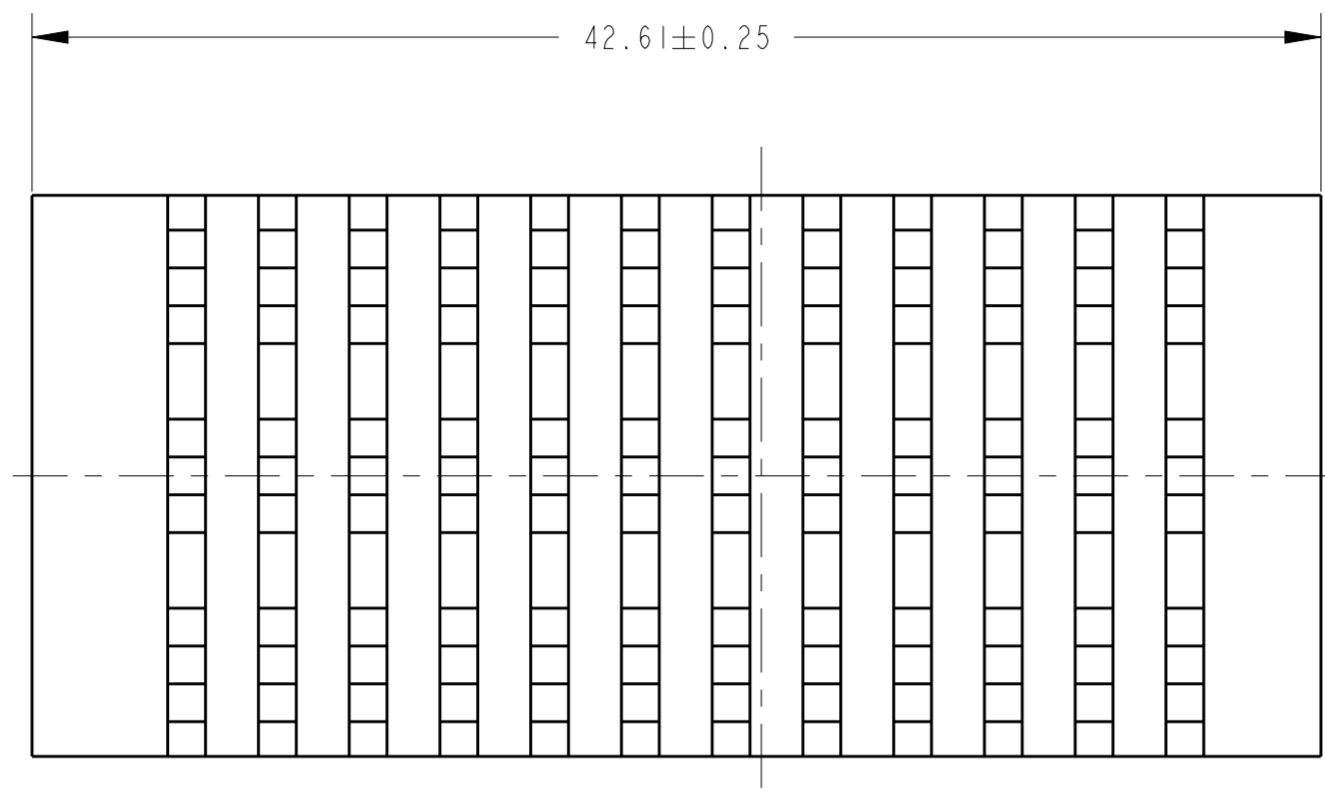

- NOTES:
- UNLESS OTHERWISE SPECIFIED
  - 1. INTERPRET DRAWING PER ASME Y14.5M - 1994.
  - 2. 0,2mm MAX BURR.
  - 3. VARIATION IN PLATING COLOR IS NORMAL AND ALLOWED.
  - 4. RoHS COMPLIANT AND CERTIFIED.

BLACK ANODIZED	ALUMIMUM	1963838-4
NICKEL PLATED	ALUMIMUM	1963838-2
FINISH	MATERIAL	PART NUMBER

THIS DRAWING IS A CONTROLLED DOCUMENT.		DWN E. TAO	6-17-08	<b>STE</b> TE Connectivity	
DIMENSIONS: mm		CHK -	APVD -		
TOLERANCES UNLESS OTHERWISE SPECIFIED:		PRODUCT SPEC -		RESTRICTED TO -	
0 PLC ±		APPLICATION SPEC -		SIZE A2	
1 PLC ±0.5		WEIGHT -		CAGE CODE 00779	
2 PLC ±0.25		Customer Drawing		DRAWING NO C-1963838	
3 PLC ±		SCALE 4:1		SHEET 1 OF 1	
4 PLC ±				REV C	
ANGLES ±8°					
FINISH					
SEE TABLE					