

REVISIONS					
P	LTR	DESCRIPTION	DATE	DWN	APVD
A3		REVISED PER ECR-23-184832	29AUG2023	PC	TD

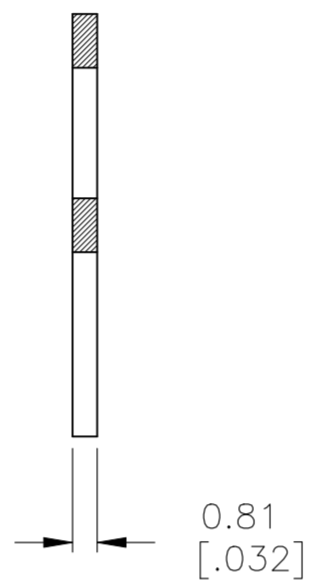

- 1 COPPER MAGNET WIRE: #12-#23 AWG, 2.06-0.56mm [.081-.022] DIA. COPPER.  
LEAD WIRE: #16-#20 AWG, [1.3-0.5mm<sup>2</sup>] STRANDED, BONDED OR SOLID WITH PVC INSULATION, MAX INSULATION OUTSIDE DIAMETER IS 4.00mm [.156], NO STRIPPING REQUIRED. OTHER INSULATION TYPES MAY BE ACCOMMODATED, CONSULT TYCO ELECTRONICS FOR APPROVAL.
- 2 POCKET RECOMMENDATION: 1601436.
- 3 TERMINAL APPLICATION TO COMPLY WITH TYCO ELECTRONICS SPEC 114-13210, FIGURE 3.
- 4 ALUMINUM MAGNET WIRE: #11-#18 AWG, 2.30-1.00mm [.090-.039] DIA. ALUMINUM.  
LEAD WIRE: #16-#20 AWG, [1.3-0.5mm<sup>2</sup>] STRANDED, BONDED OR SOLID WITH PVC INSULATION, MAX INSULATION OUTSIDE DIAMETER IS 4.00mm [.156], NO STRIPPING REQUIRED. OTHER INSULATION TYPES MAY BE ACCOMMODATED, CONSULT TYCO ELECTRONICS FOR APPROVAL.
- 5 PRELIMINARY NOT FOR PRODUCTION.

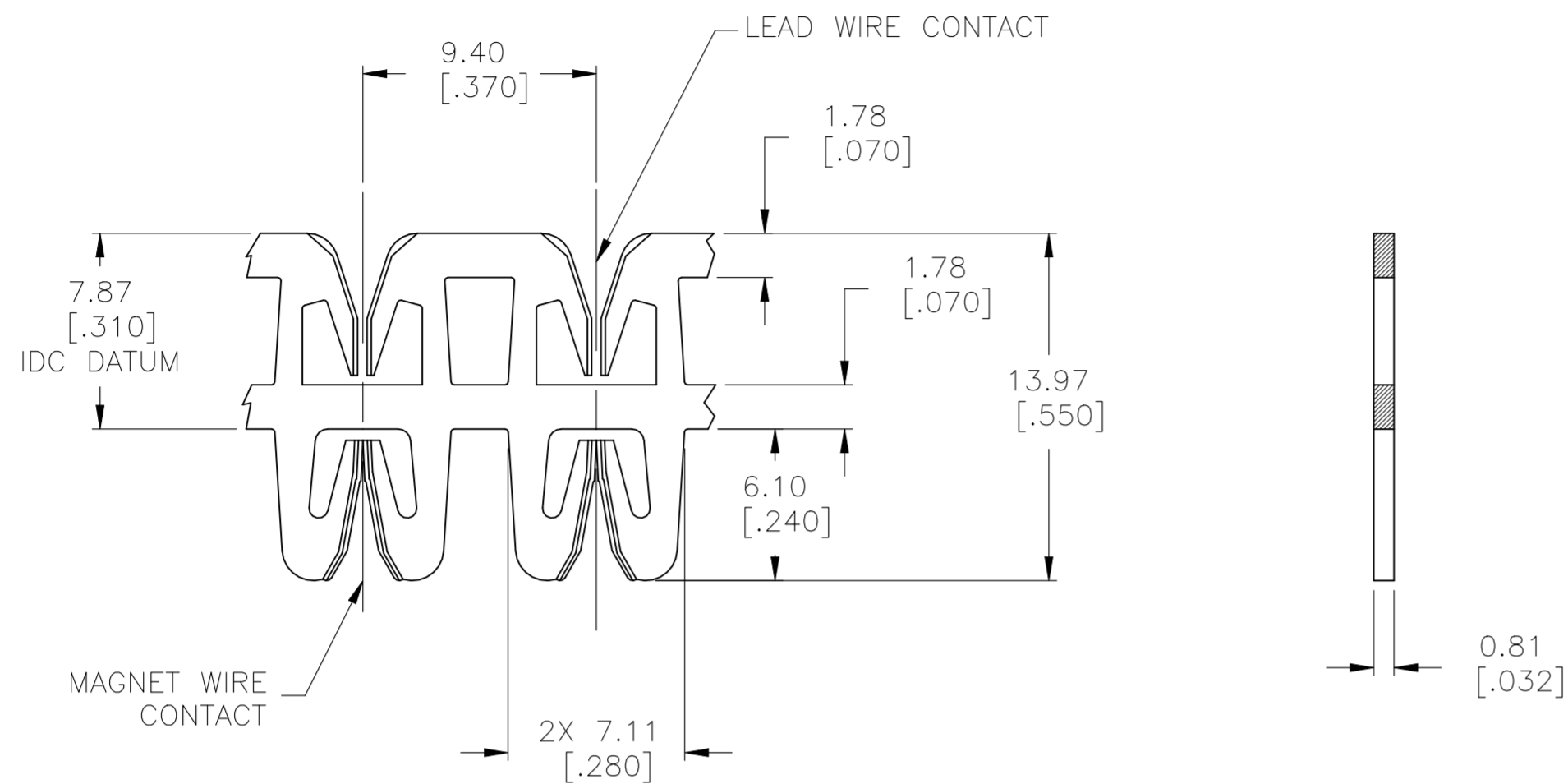
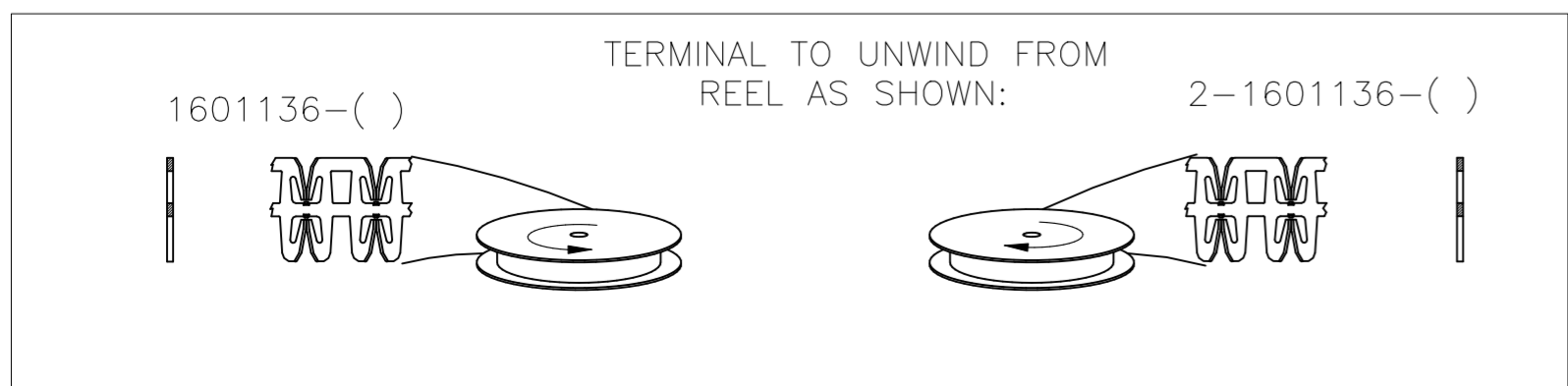
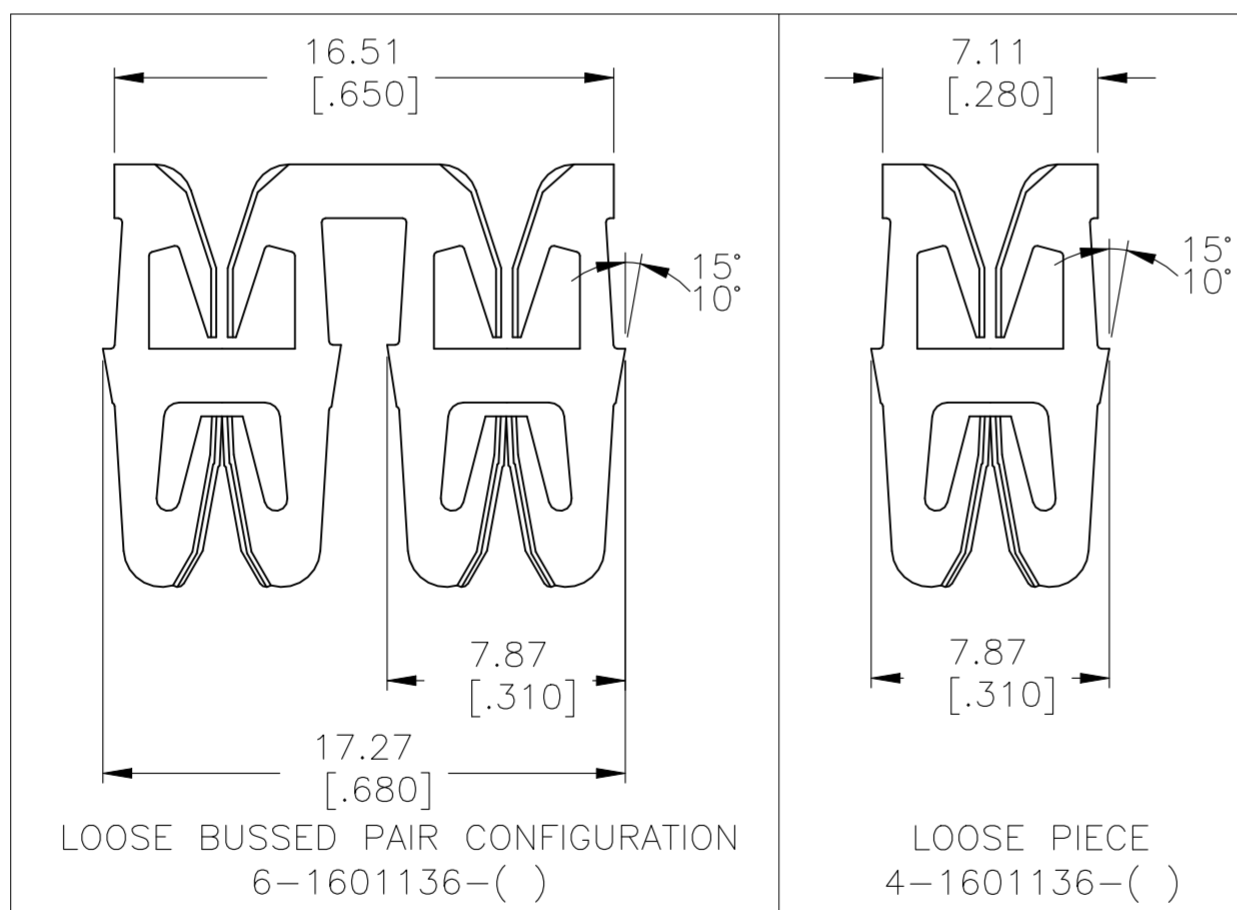

	-	-	-
	TIN	-	4 1601136-2
5	UNPLATED	-	1 6-1601136-1
	UNPLATED	051-001-000	1 4-1601136-1
	UNPLATED	151-002-000	1 2-1601136-1
	UNPLATED	151-001-000	1 1601136-1
	FINISH	REFERENCE PART NUMBER	PART NUMBER
THIS DRAWING IS A CONTROLLED DOCUMENT.		DWN MICHAEL S. FEHER 07MAR2002	TE Connectivity
DIMENSIONS: mm [INCHES]		CHK GENE JACONO 07MAR2002	
TOLERANCES UNLESS OTHERWISE SPECIFIED:		APVD GENE JACONO 07MAR2002	
0 PLC ± - 1 PLC ± 0.25 [.010] 2 PLC ± 0.13 [.005] 3 PLC ± - 4 PLC ± - ANGLES ± 2°		PRODUCT SPEC 108-2239 APPLICATION SPEC 3	
MATERIAL BRASS, SPRING HARD	FINISH SEE TABLE	WEIGHT 0.000000	NAME MEDIUM RANGE WIRE TO WIRE HIGH CARRIER SIAMEZE TERMINAL SIZE A2 CAGE CODE 00779 DRAWING NO C=1601136 RESTRICTED TO - SCALE 4:1 SHEET 1 OF 1 REV A3
CUSTOMER DRAWING			