

REVISIONS

P	LTR	DESCRIPTION	DATE	DWN	APVD
	A5	ECR-21-123577	09JUL2022	RK	JB

Notes

- 1 Material: zink diecast
- 2 Surface: - powder coated grey  
- varnish black
- 3 Varnish on the inside not necessarily
- 4 Special packing  
Packaging quantity 100 pieces
- 5 Packaging quantity 10 pieces

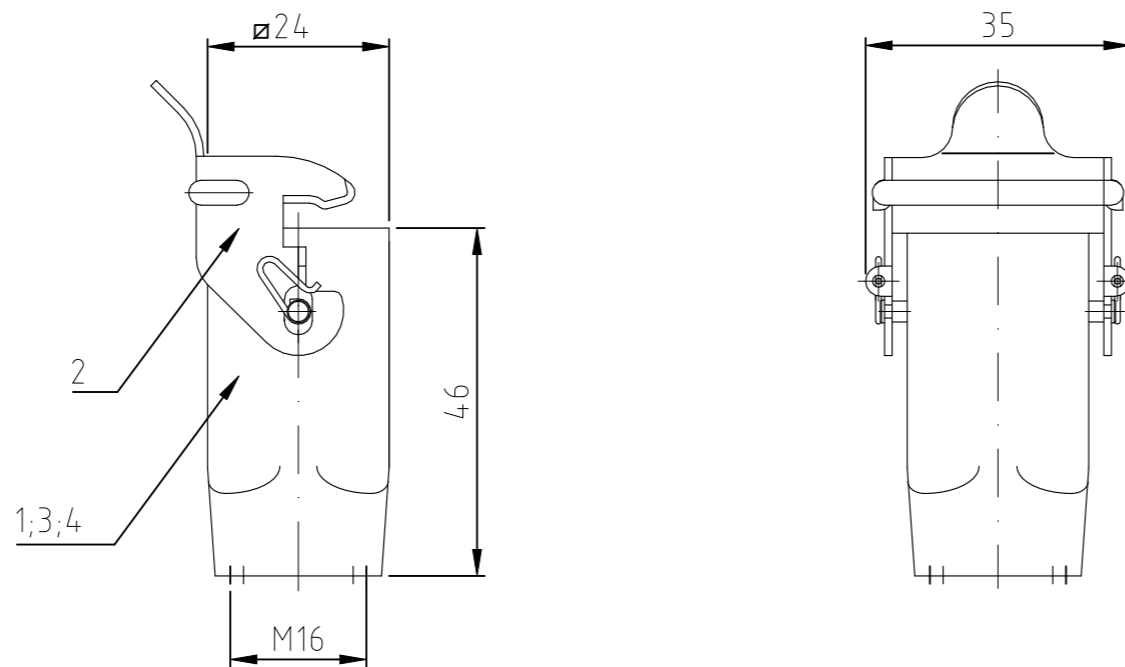

0-5	0-4	0-3	0-1	DESCRIPTION	MATERIAL	SURFACE	COLOR	ITEM NO. POS.	NOTES
				Cable-to-cable hood	zink diecast	blue passivation	black	4	
	1			Cable-to-cable hood	zink diecast	blue passivation	without varnish	3	
1	1	1	1	Side clip	steel	zinc plated	blue	2	
		1	1	Cable-to-cable hood	zink diecast		grey	1	

HA-EMV.3.KDO-LB.1.M16.Z	OBSOLETE	1							
HA-EMV.3.KDO-LB.1.M16.Z	OBSOLETE	1							
HA.3.KDO-LB.1.M16.Z.KM			1						
HA.3.KDO-LB.1.M16.Z	OBSOLETE		1						

THIS DRAWING IS A CONTROLLED DOCUMENT.		DWN	07.01.2003	
		CHK	07.01.2003	
		APVD	-	
		PRODUCT SPEC	-	
		APPLICATION SPEC	-	
		WEIGHT	-	
CUSTOMER DRAWING		SCALE	1:1	
		SHEET	1 OF 1	
		REV	A5	

DIMENSIONS: mm		TOLERANCES UNLESS OTHERWISE SPECIFIED:	
		<p>ISO 8015 p. ISO 2768 - M - E p. DIN 16901 - 140</p>	
MATERIAL		FINISH	

ORDERING TEXT / BESTELLTEXT		TE Connectivity Cable-to-cable hood Kupplungsgehäuse HA.3.KDO-LB.1.M16.Z	
		SIZE	A3
		CAGE CODE	00779
		DRAWING NO	C=1106403
		RESTRICTED TO	-