

THIS DRAWING AND THE INFORMATION SET FORTH HEREON ARE THE PROPERTY OF TYCO CORP. AND ARE TO BE HELD IN TRUST AND CONFIDENCE. PUBLICATION, DUPLICATION, DISCLOSURE OR USE FOR ANY PURPOSE NOT EXPRESSLY AUTHORIZED IN WRITING BY TYCO CORP. IS PROHIBITED.

| REVISIONS |                         |         |          |
|-----------|-------------------------|---------|----------|
| LTR       | DESCRIPTION             | DATE    | APPROVED |
| C         | REVISED PER DCR R050285 | 7/25/05 |          |

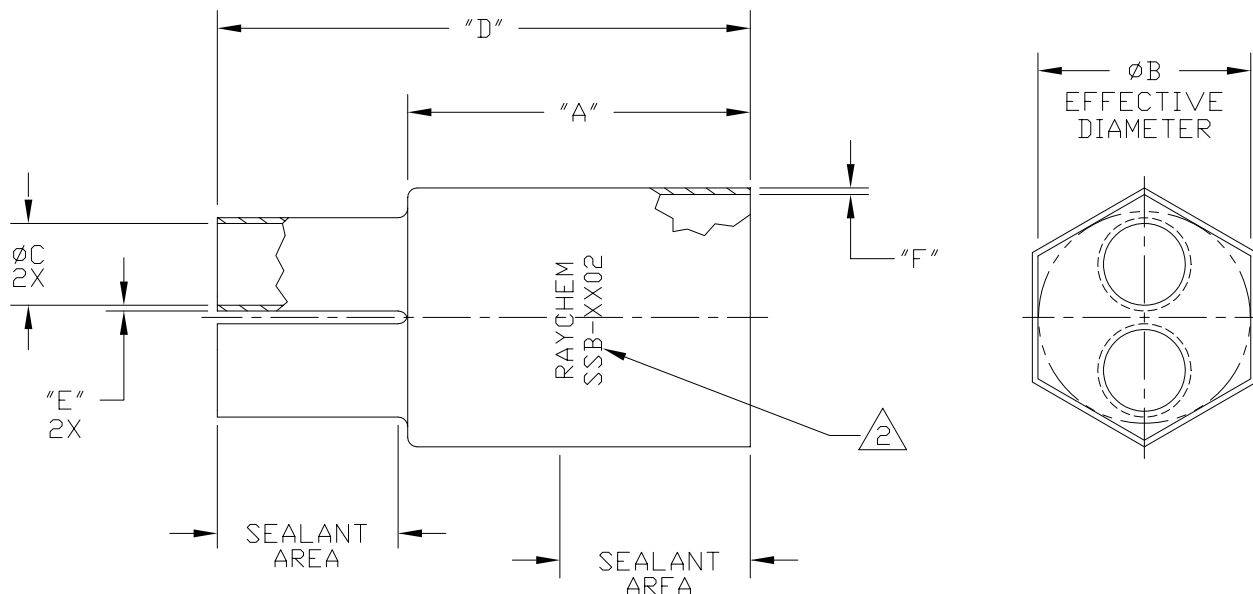

| PART NUMBER | ØB              |                 | ØC             |               | "A" ±10%        |                 | "D" ±10%         |                  | "E" ±20%      | "F" ±20%      |
|-------------|-----------------|-----------------|----------------|---------------|-----------------|-----------------|------------------|------------------|---------------|---------------|
|             | MIN EXP         | MAX REC         | MIN EXP        | MAX REC       | EXP             | REC             | EXP              | REC              | REC           | REC           |
| SSB-1202    | 1.60<br>[40,64] | .50<br>[12,7]   | .50<br>[12,7]  | .15<br>[3,81] | 2.00<br>[50,8]  | 2.57<br>[65,28] | 3.14<br>[79,76]  | 4.09<br>[103,89] | .08<br>[2,03] | .12<br>[3,05] |
| SSB-2002    | 2.00<br>[50,8]  | 1.50<br>[38,10] | .75<br>[19,05] | .37<br>[9,39] | 2.85<br>[72,39] | 3.67<br>[93,22] | 5.32<br>[135,13] | 6.56<br>[166,63] | .09<br>[2,29] | .10<br>[2,54] |

NOTES:

1. MATERIAL: HEAT SHRINKABLE BOOT MATERIAL IN ACCORDANCE WITH -3 POLYOLEFIN THIS INCLUDES INTERNAL COATING OF FACTORY APPLIED NON-SETTING SEALANT. BOOTS ARE AVAILABLE WITHOUT SEALANT ON SPECIAL ORDER.

 MARKING: PART TO BE MARKED AS SHOWN, REPLACE "X'S" WITH APPROPRIATE CHARACTERS (e.g. SSB-2002).

© 2004-2005 Tyco Electronics Corporation. All rights reserved

SPECIFICATION CONTROL DRAWING

UNLESS OTHERWISE SPECIFIED DIMENSIONS ARE IN INCHES. METRIC DIMENSIONS ARE IN BRACKETS.

DECIMALS

.XXX ± — [ mm]  
 .XX ± — [ mm]  
 .X ± — [ mm]

ANGLES

.X ± —

|                      |                 |
|----------------------|-----------------|
| DRAWN<br>G. ROSITANO | DATE<br>9/20/95 |
| CHECKED              | DATE            |
| APPROVED             | DATE            |
| APPROVED             | DATE            |
| CAD NAME<br>R050285  |                 |

THIRD ANGLE PROJECTION

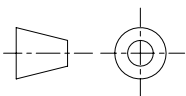

**tyco** **Raychem**  
 Electronics

TYCO ELECTRONICS  
 300 CONSTITUTION DRIVE  
 MENLO PARK, CALIFORNIA 94025

TITLE

2-LEG  
 STRAIGHT BOOTS

|                       |                          |                      |          |
|-----------------------|--------------------------|----------------------|----------|
| SIZE<br>A             | CODE IDENT. NO.<br>06090 | DWG. NO.<br>SSB-XX02 | REV<br>C |
| DO NOT SCALE THIS DWG |                          | SHEET 1 OF 1         |          |