

THIS DRAWING IS UNPUBLISHED. RELEASED FOR PUBLICATION
 © COPYRIGHT 2016 BY TE CONNECTIVITY ALL RIGHTS RESERVED.

REVISIONS				
P	LTR	DESCRIPTION	DATE	APVD
A		INITIAL RELEASE PER ECO-17-017008	17NOV17	PT TR

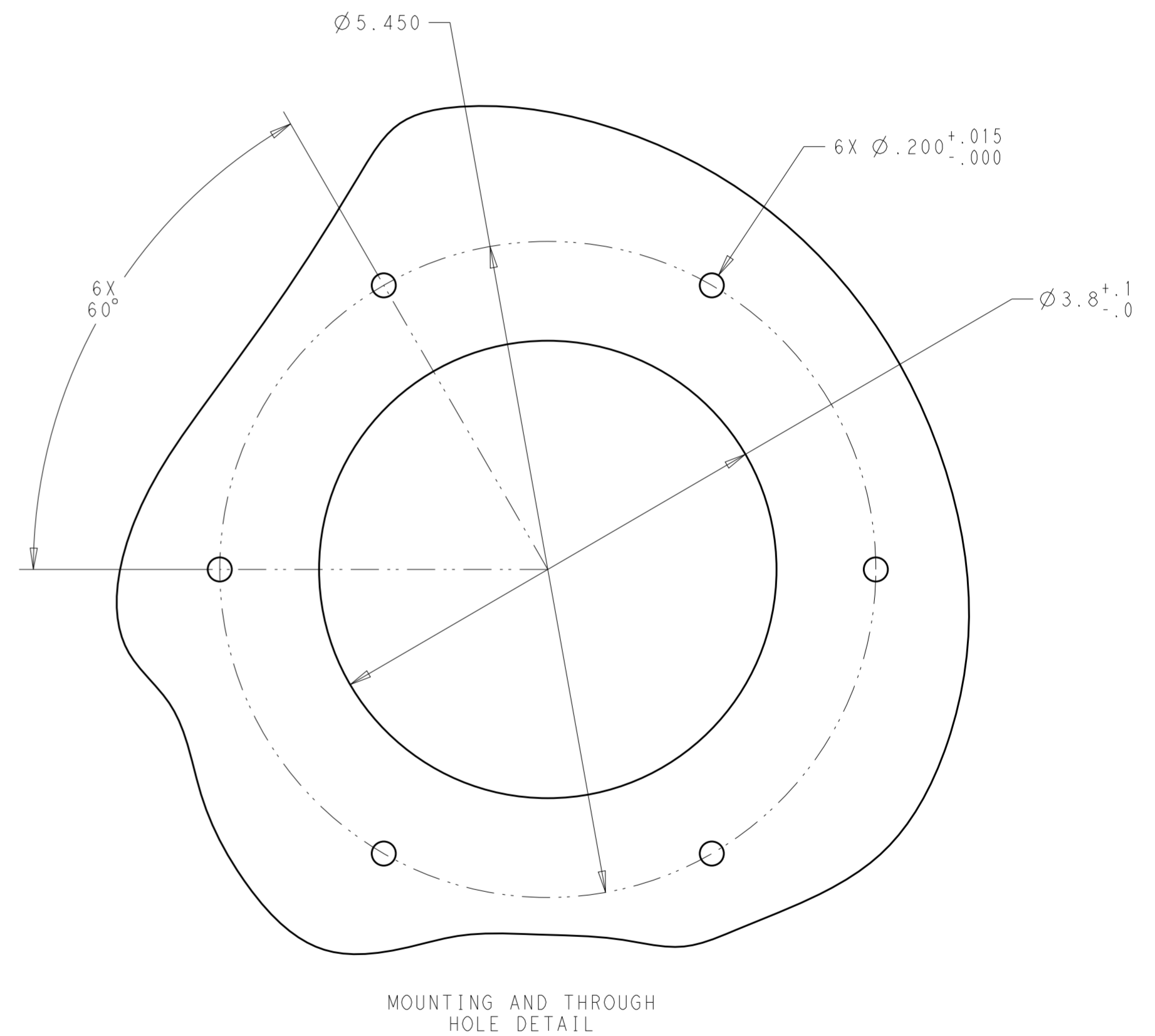
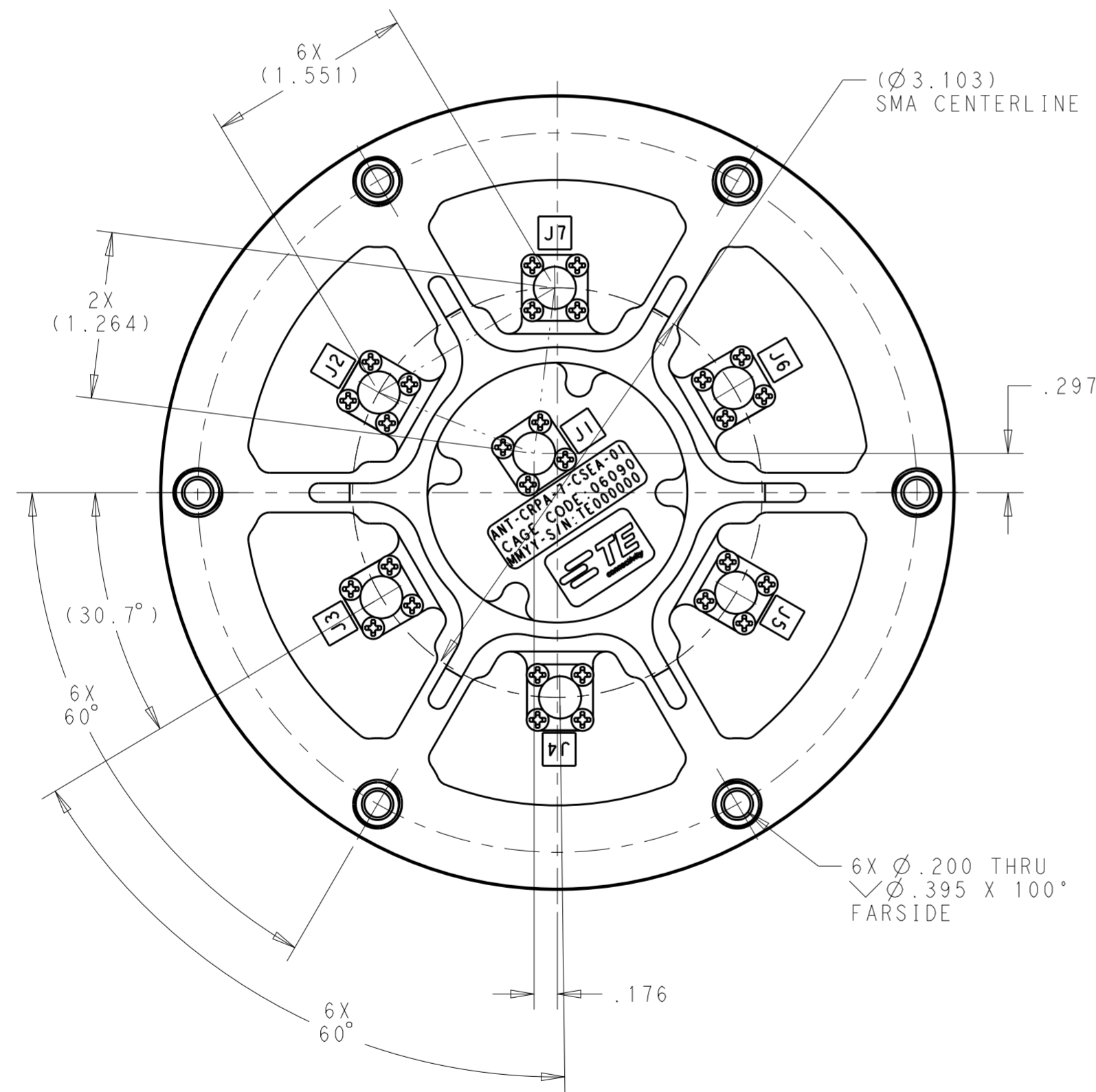
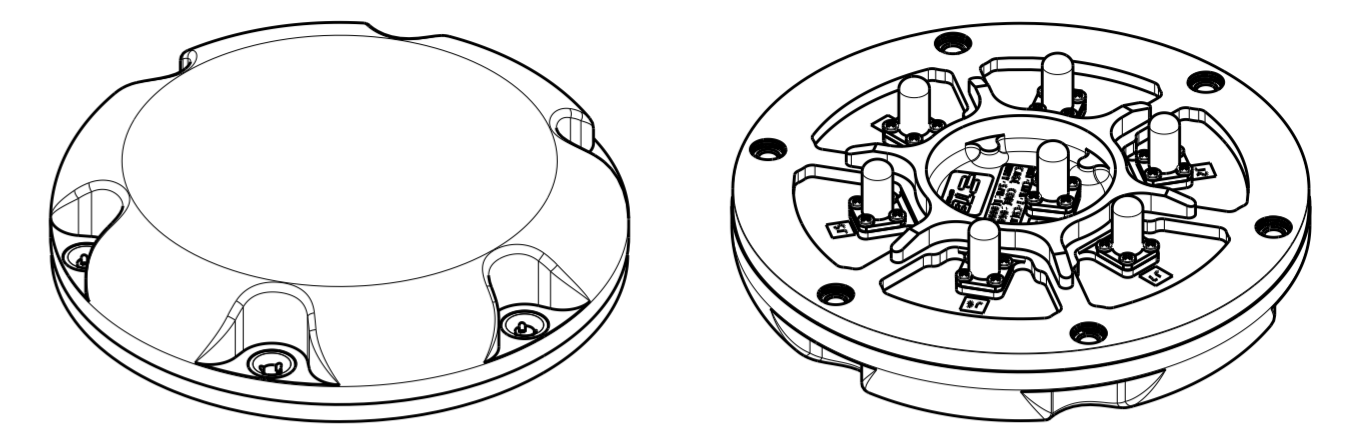
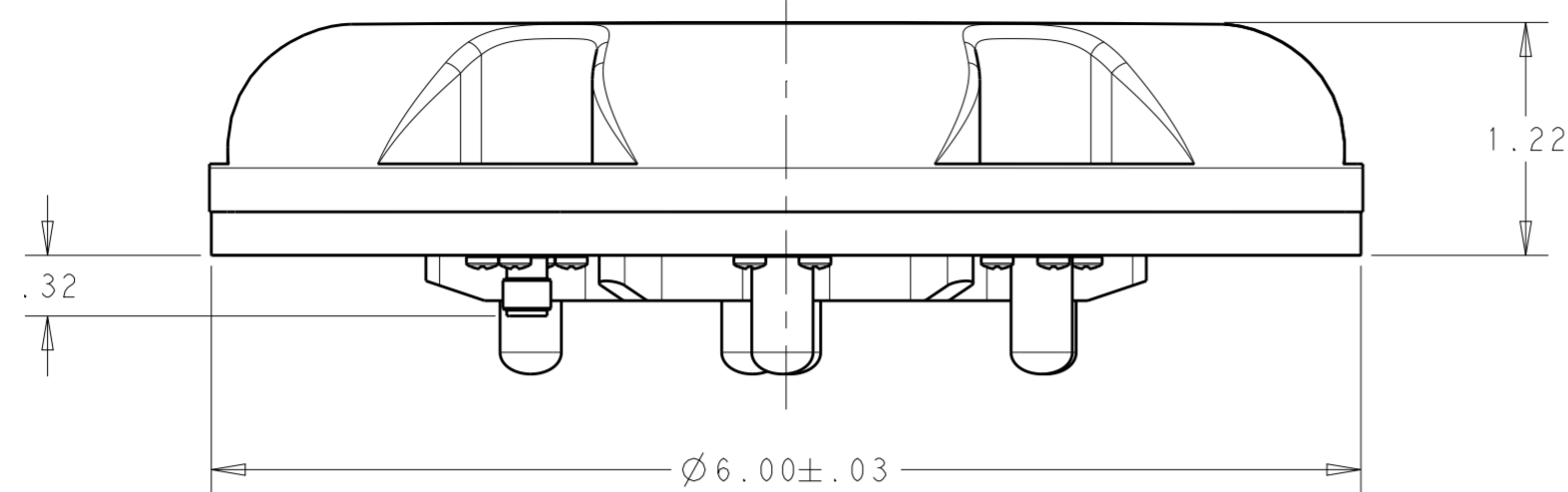

NOTES: UNLESS OTHERWISE SPECIFIED
 1. INSTALLATION NOTES: SEE SHEET 2.

ANT-CRPA-7-CSEA-01	EG4460-000
DESCRIPTION	TCPN

THIS DRAWING IS A CONTROLLED DOCUMENT.		DWN PTALLY 20OCT2017	STE TE Connectivity	
DIMENSIONS: INCH		CHK TRATZLAFF 17NOV2017		
TOLERANCES UNLESS OTHERWISE SPECIFIED:		APVD -	NAME WIDEBAND 7-ELEMENT GNSS ANTENNA	
0 PLC ±-		PRODUCT SPEC	-	
1 PLC ±0.1		APPLICATION SPEC	-	
2 PLC ±0.02		WEIGHT	1.65 LB	SIZE
3 PLC ±0.005		CUSTOMER DRAWING	A206090	CAGE CODE
4 PLC ±0.0005		SCALE	1:2	DRAWING NO
ANGLES ±		SHEET	1 OF 2	RESTRICTED TO
FINISH		REV	A	

THIS DRAWING IS UNPUBLISHED. RELEASED FOR PUBLICATION
 © COPYRIGHT 2016 BY TE CONNECTIVITY ALL RIGHTS RESERVED.

REVISIONS				
P	LTR	DESCRIPTION	DATE	APVD

INSTALLATION NOTES:

1. USE OF SELF-LOCKING FASTENERS OR THREAD LOCKING COMPOUND IS RECOMMENDED ON EACH MOUNTING SCREW (6X).
2. INTERFACE SEAL TO BE DEFINED AND FABRICATED BY CUSTOMER.
3. MOUNTING SCREW LENGTH IS APPLICATION SPECIFIC AND IS DETERMINED BY CUSTOMER.
4. ALODINE COATING MUST BE SCRATCH AND BLEMISH FREE FOR PROPER GROUNDING AND CORROSION PROTECTION TO ANTENNA BASE.
5. INSERT (6X) NUMBER 10, 100°, FLATHEAD STAINLESS STEEL SCREWS INTO MOUNTING POSITIONS.
6. THREAD SCREWS INTO MOUNTING HOLES UNTIL SCREW BEGINS TO CONTACT COUNTERSINK SURFACE.
7. TORQUE SCREWS 18-20 POUND-INCH USING THE SEQUENCE PATTERN SHOWN.
8. TORQUE SMA CONNECTOR NUTS TO 8-9 POUND-INCH.

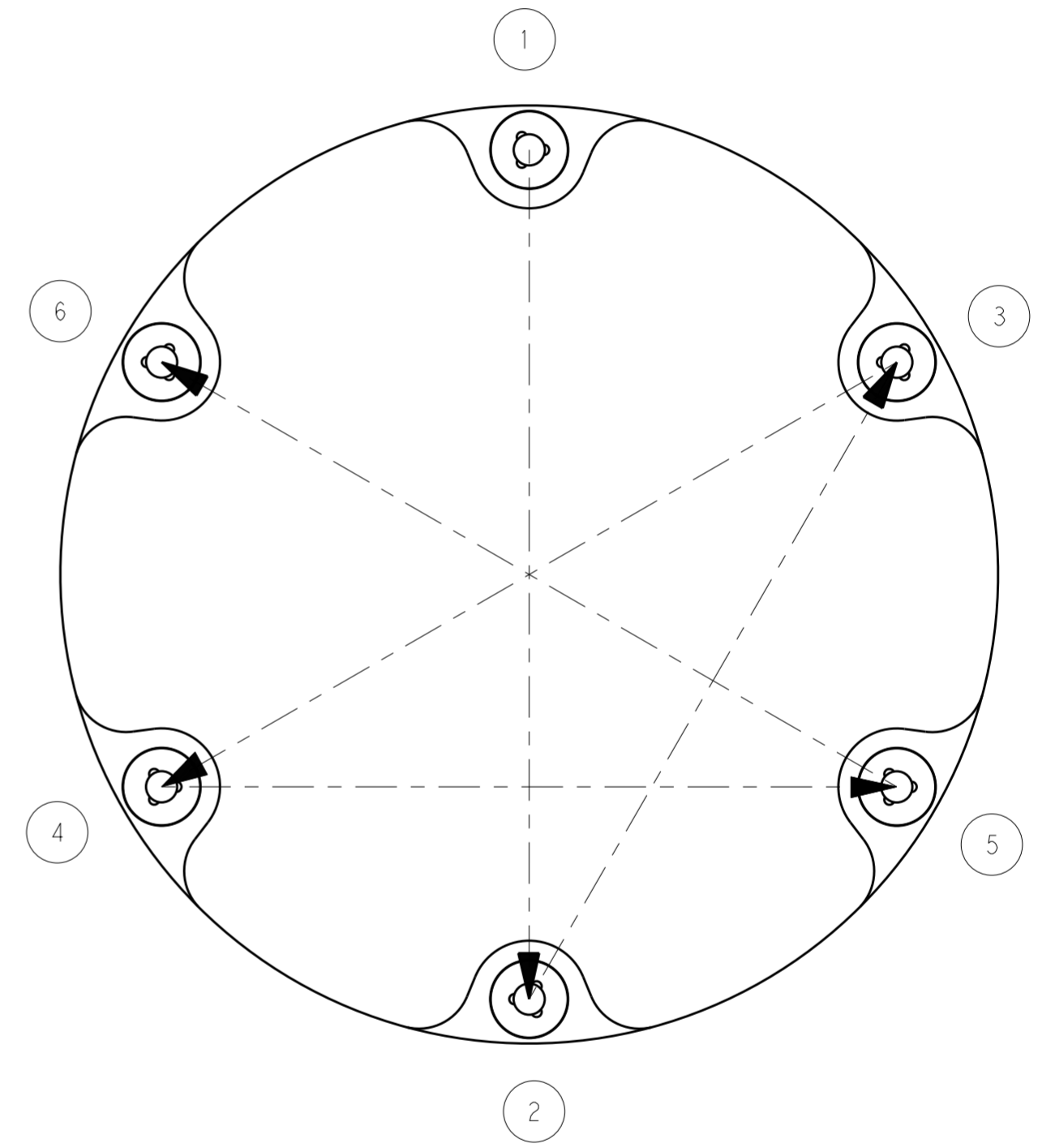
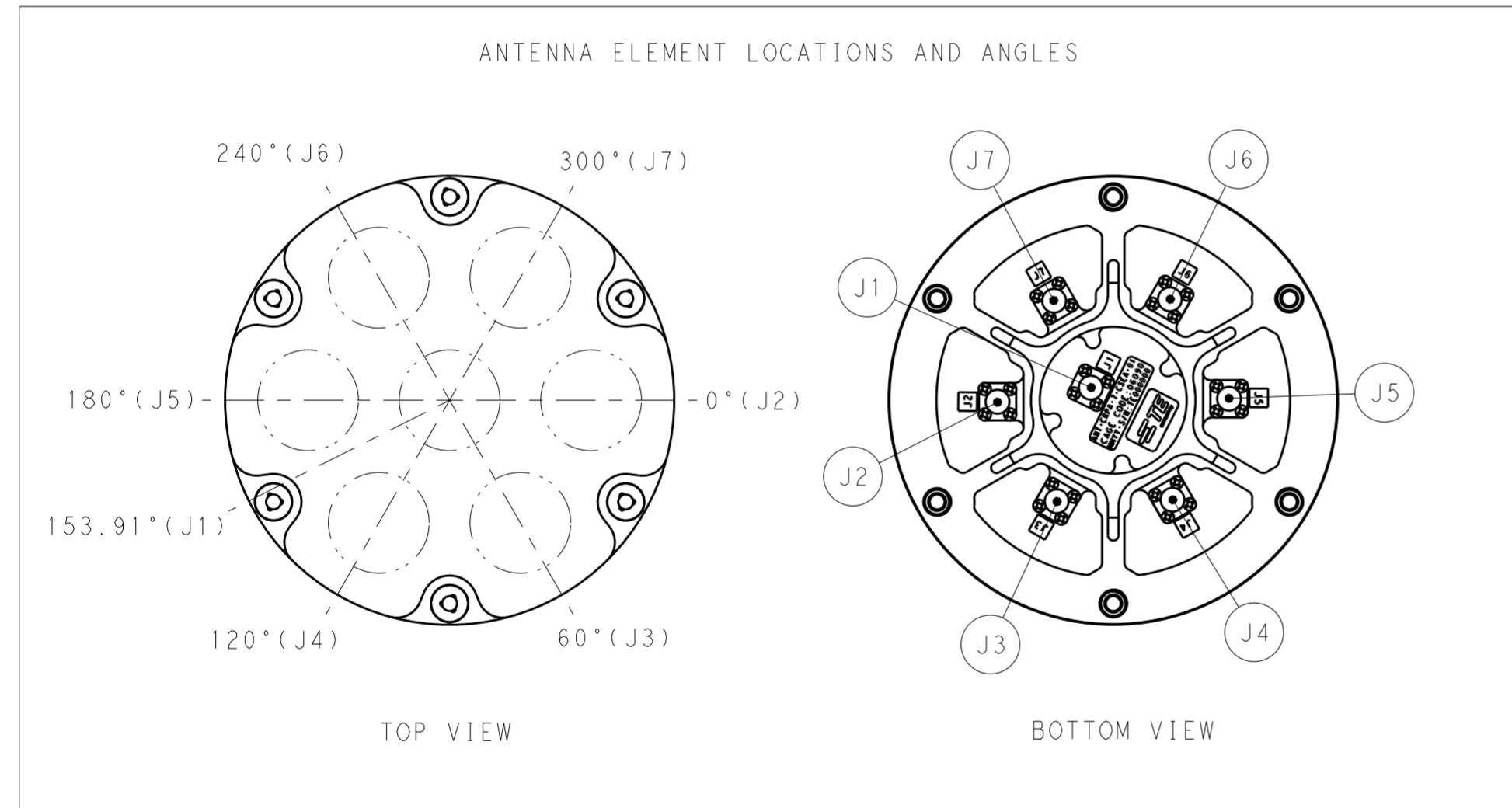

THIS DRAWING IS A CONTROLLED DOCUMENT.		DWN PTALLY 20OCT2017	STE TE Connectivity	
DIMENSIONS: INCH		CHK TRATZLAFF 17NOV2017		
TOLERANCES UNLESS OTHERWISE SPECIFIED:		APVD -	NAME WIDEBAND 7-ELEMENT GNSS ANTENNA	
0 PLC ± 1 PLC ±0.1 2 PLC ±0.02 3 PLC ±0.005 4 PLC ±0.0005 ANGLES ± FINISH		PRODUCT SPEC -	SIZE CAGE CODE DRAWING NO RESTRICTED TO	
MATERIAL -		APPLICATION SPEC -	A206090 G-ANT-CRPA-7-CSEA-01 -	
-		WEIGHT -	SCALE 1:2 SHEET 2 OF 2 REV A	
-		CUSTOMER DRAWING	-	