

NUMBER 84580

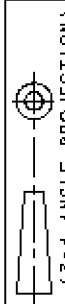

METRIC

CONFIDENTIAL INFORMATION

DIMENSIONS IN MM. DO NOT SCALE PRINT

PRINT DIST

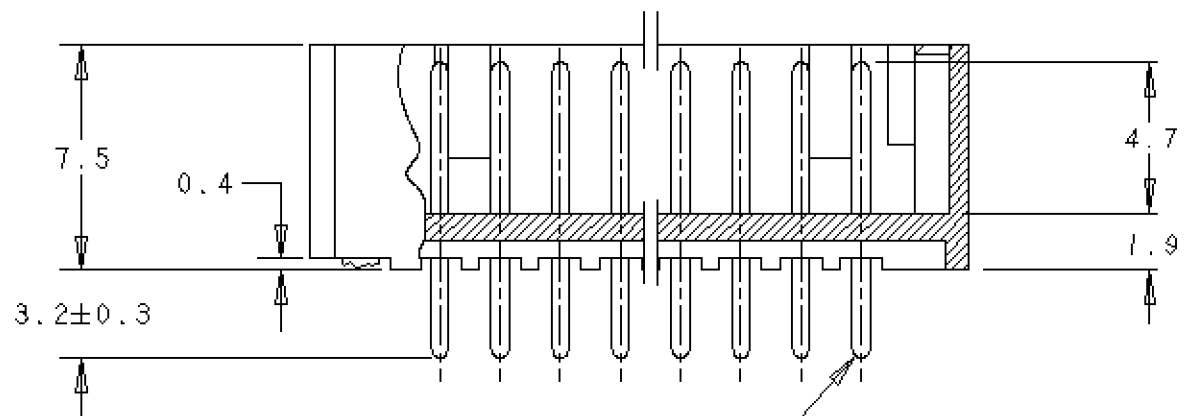
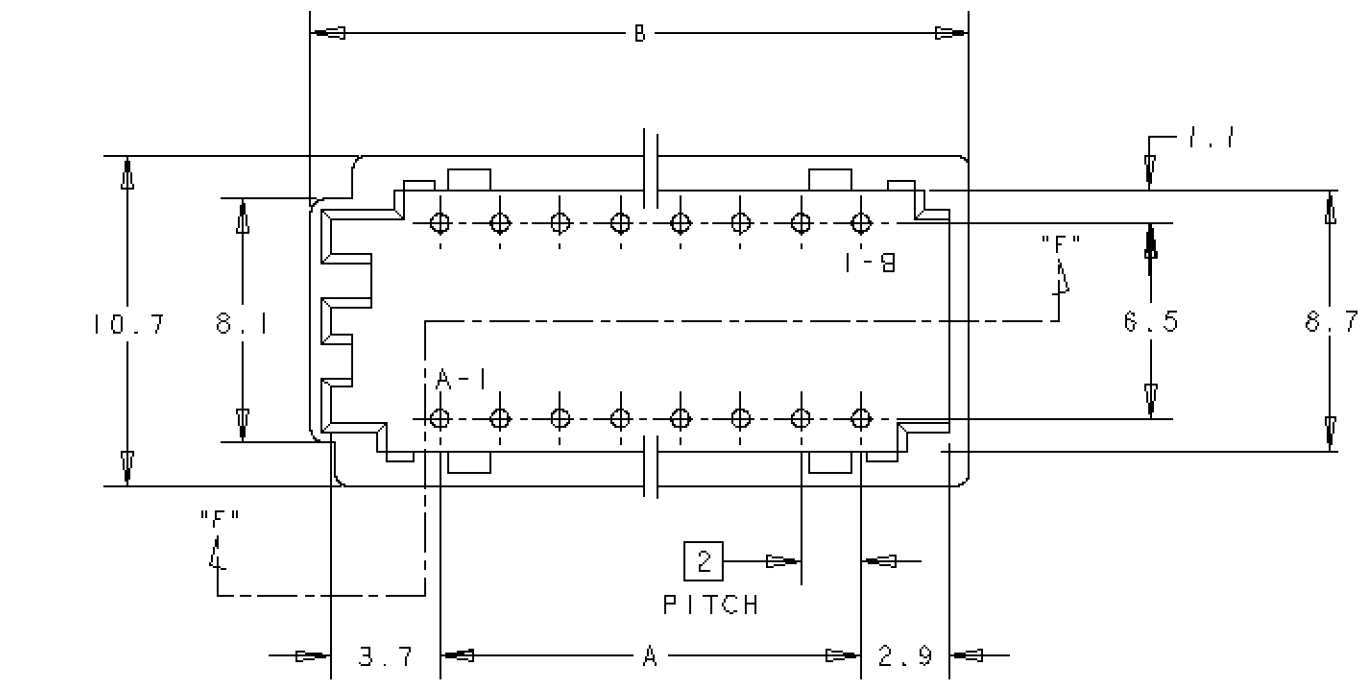

SECT "F"-"F"

NOTES

1. MATERIAL: HOUSING /GLASS-FILLED HIGH TEMP NYLON, UL94V0
POST: 0.6 DIA POST, 3/4H, POST-PLATED TIN

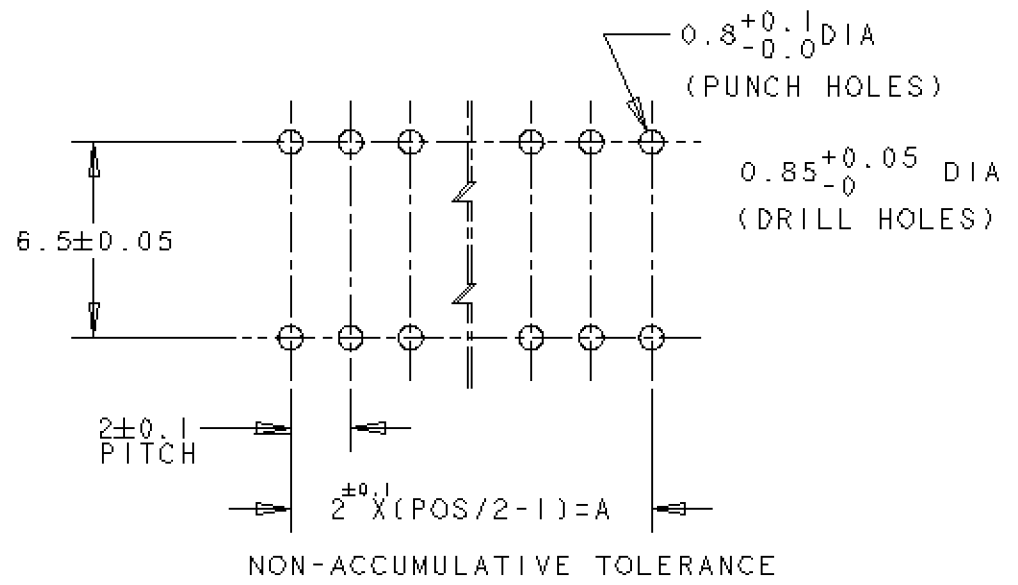

PCB MOUNTING LAYOUT
(CONNECTOR MOUNTING SIDE)
RECOMMENDED PCB THICKNESS : 1.6mm

26.0	33.9	28	2-	-8
20.0	27.9	22	2-	-2
18.0	25.9	20	2-	-0
16.0	23.9	18	1-	-8
14.0	21.9	16	1-	84580-6
A	B	POS	P/N	

B	REVISED ECR-07-014682	C.Z	S.Y	23JUN07
A	REVISED FP00-0281-93	LWY	CWL	11DEC00
O	NPR FP00-0342-95	LWY	ET	28SEP98
LTR	(REVISION RECORD)	DR	CHK	DATE

Copyright ©1998 AMP MANUFACTURING (SINGAPORE) PTE. LTD. ALL RIGHTS RESERVED.		Copyright ©1998 AMP MANUFACTURING (SINGAPORE) PTE. LTD. ALL RIGHTS RESERVED.	
(WIRE RANGE) mm ² (AWG)	(INSULATION DIA.) mm	(NAME)	(FINISH)
SEE NOTE 1	SEE NOTE 1		
DR. WYLEE	APP. WL CHOO	(GENERAL TOLERANCE)	
CHK. ERIC TNG	REL. SHAREL	0 < * ≤ 10 : ±0.2	10 < * ≤ 30 : ±0.25
		30 < * ≤ 100 : ±0.5	ANGLES : ± 3°

AMP		AMP MANUFACTURING (SINGAPORE) PTE. LTD.	
2mm CT DOUBLE-ROW HEADER ASSEMBLY (BOX V TYPE) WITHOUT KINK, HIGH TEMPERATURE TYPE			
SIZE	LOC	(No.)	
A3	DY	84580	
(SCALE)	REV.	SHEET	
NTS	B	1 OF 1	

CUSTOMER DRAWING