

PART NUMBER	REV	FIRST USED
680154-3	D	354500-1

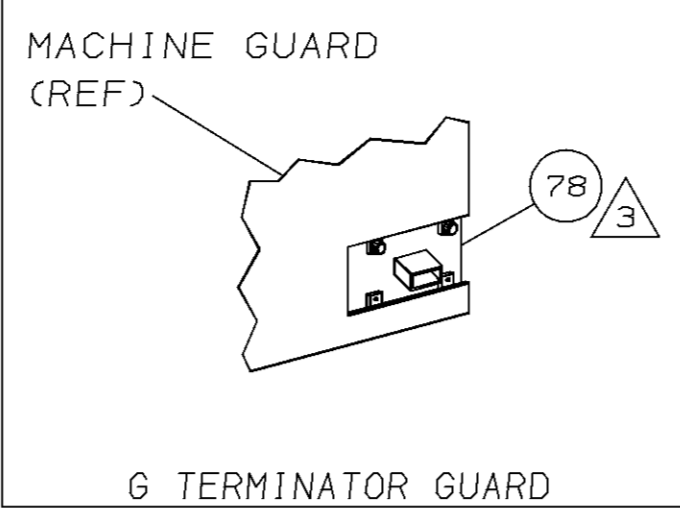

TERMINAL NAME:
.187/.250 FASTON™ TAB

63836			
63835			

TERM APPL SPEC -

CRIMPING DATA			
PAD LTR	CRIMP HEIGHT	WIRE SIZE	
A	-	-	
B	NOT	USED	
C	NOT	USED	
D	NOT	USED	
CRIMP	SIZE	TYPE	RANGE
WIRE	-	-	-
INSUL	-	-	-
FEED	APPL INST	SET UP GAGE	LAYOUT
.310	408-8039	458638-1	L1635
WIRE STRIP LENGTH -			

-3	BENCH MODEL G	AIRFEED
----	---------------	---------

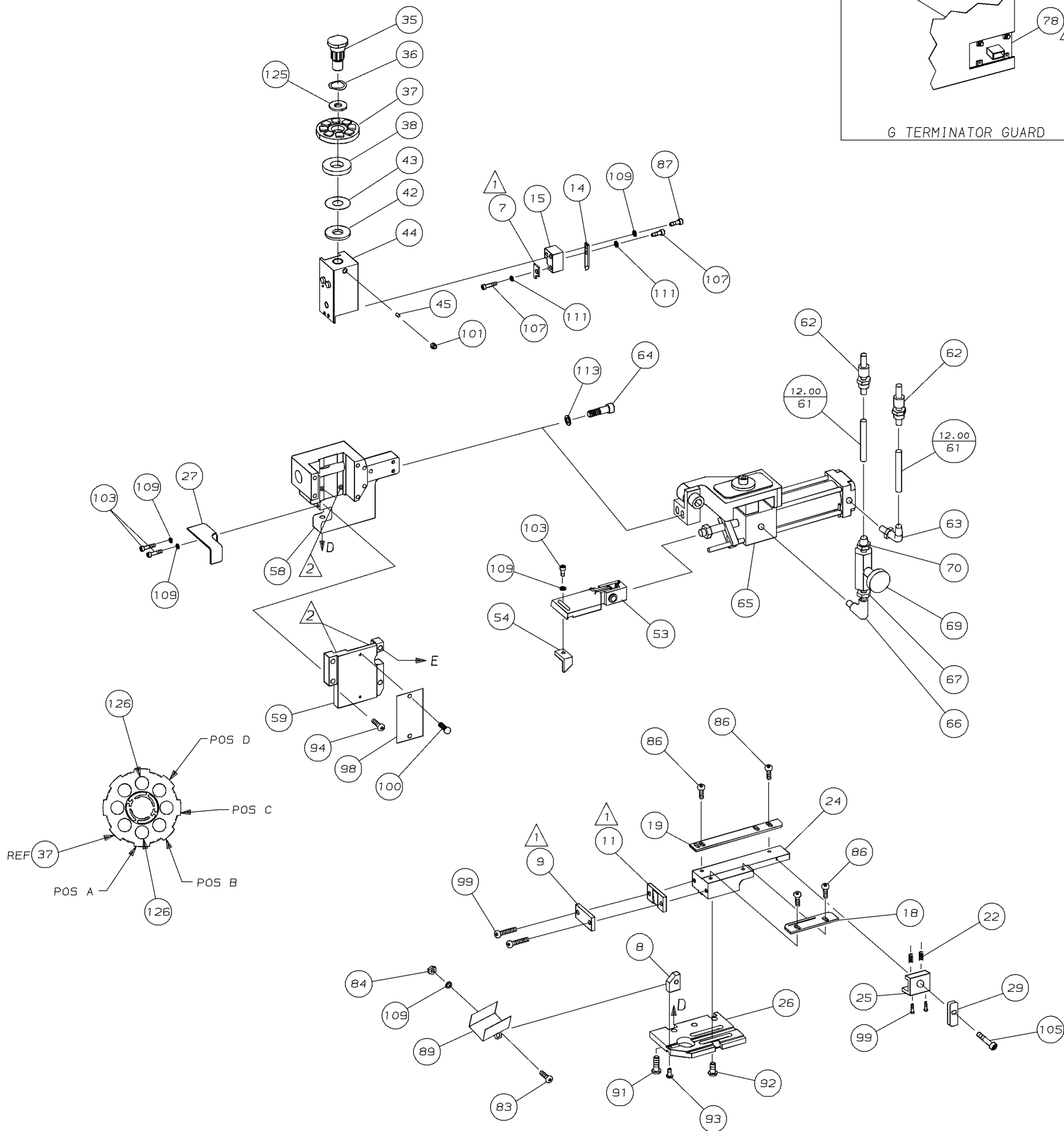

- 1 RECOMMENDED SPARE PARTS.
- 2 GREASE LIGHTLY.
- 3 GUARD MUST BE IN PLACE WHEN OPERATING APPLICATOR IN A BENCH MACHINE.
- 4 SEE DRAWING FOR COMPONENTS
- 5 ITEM NOT SHOWN.

					129
					128
					127
2	-	C	354779-2	PIN, WIRE DISC (.3000)A	126
1	-	A	986950-1	WASHER, FLAT PRECISION	125
					124
					123
					122
1	-	C	356118-1	LOOSE PIECE KIT	121
					120
					119
					118
					117
					116
					115
					114
2	-	A	21024-5	WASHER, LOCK (NO. 10) FEED	113
					112
2	-	A	21024-3	WASHER, LOCK (NO. 6) SLUG BLD	111
					110
6	-	A	21024-4	WASHER, LOCK (NO. 8) ST GUIDE	109
					108
2	-	A	1-21000-9	SCR, SHC (6-32x.38) SLUG BLADE	107
					106
1	-	A	22353-8	SCR, SHLD (Ø.187x.25) DRAG LEVER	105
					104
3	-	A	2-21000-6	SCR, SHC (8-32x.38) FEED HOLDER	103
					102
1	-	A	21009-2	SCR, SKT SET (1/4-20x.25)RAM	101
2	-	A	21017-2	SCR, DRIVE (#2x.19) ID PLATE	100
4	-	A	3-21002-0	SCR, BHC (10-32x.88) DRAG	99
1	-	B	461264-1	PLATE, IDENTIFICATION	98
					97
					96
					95
4	-	A	2-21002-9	SCR, BHC (10-32x.75) CAP	94
1	-	A	22733-8	SCR, BHC (8-32x.38 LW) ANVIL	93
4	-	A	3-21002-3	SCR, BHC (1/4-20x.50) ST GD PL	92
3	-	A	2-22733-8	SCR, BHC (1/4-20x.62) HSG	91
					90
1	-	B	224747-1	CHUTE, PRODUCT	89
					88
2	-	A	3-21000-0	SCR, SHC (8-32x.88) SLUG BLADE	87
7	-	A	2-21002-1	SCR, BHC (8-32x.38) STRIP GUIDE	86
					85
1	-	A	21018-6	NUT, HEX (8-32)	84
1	-	A	2-21002-3	SCR, BHC (8-32x.62) CHUTE	83
					82
					81
					80
					79
					78
1	-	A	189437-1	INSERT, GUARD	77
					76
					75
					74
					73
					72
					71

					70
					69
					68
					67
1	-	A	22304-1	NIPPLE, HEX 1/8NPTx1/8NPT	66
1	-	A	22306-1	ELBOW, STREET 1/8NPTx1/8NPT	65
1	-	C	224800-1	AIR FEED ASSY	64
2	-	A	4-21000-1	SCR, SHC (10-32x1.50) AIR ASSY	63
1	-	A	983427-6	ELBOW, SWIVEL 1/8NPT - 1/4 T	62
2	-	A	23238-1	QUICK DISCONNECT	61
24.00	IN	A	27319-4	TUBING, POLY-FLO Ø.25	60
					59
1	-	C	454220-1	CAP, RAM	58
1	-	D	356078-1	HOUSING	57
					56
					55
					54
1	-	B	224716-1	PAWL, FEED	53
1	-	B	461062-1	FEED FINGER ASSY	52
					51
					50
					49
					48
					47
					46
1	-	A	690191-1	PLUG, NYLON	45
1	-	C	356082-1	RAM	44
1	-	A	690125-1	WASHER, LAMINATED	43
1	-	A	690124-1	WASHER, RAM	42
					41
					40
					39
1	-	A	690223-2	SPACER, INSULATION DISC	38
1	-	D	354777-1	WIRE DISC, PLASTIC	37
1	-	A	22480-5	WASHER, SPRING	36
1	-	B	690212-1	POST, RAM	35
					34
					33
					32
					31
					30
1	-	B	240793-1	LEVER, DRAG RELEASE	29
					28
1	-	B	356344-1	DEFLECTOR, TERMINAL	27
1	-	D	455676-1	PLATE, BASE	26
					25
1	-	C	224710-1	PLATE, STRIP GUIDE	24
					23
2	-	A	1-22284-0	SPRING, DRAG	22
					21
1	-	B	690754-9	DRAG, TERMINAL	20
1	-	B	454204-5	GUIDE, STRIP (REAR)	19
1	-	B	224715-1	GUIDE, STRIP (FRONT)	18
					17
1	-	B	356083-1	HOLDER, TOOL	15
1	-	B	356084-1	PILOT, TERMINAL	14
					13
					12
1	-	B	224708-1	PLATE, REAR SHEAR	11
					10
1	-	B	189683-1	PLATE, FRONT SHEAR	9
1	-	A	224748-1	BLOCK, MOUNTING	8
1	-	C	224707-1	BLADE, SLUG	7
					6
					5
					4
					3
					2
					1

QTY REQD PER ASSY	U/M	DWG SIZE	PART NO	DESCRIPTION	ITEM NO
REVISION OF EACH ASSY NO (WHEN BLANK, USE DWG REVISION)					
PARTS LIST					

QTY REQD PER ASSY	U/M	DWG SIZE	PART NO	DESCRIPTION	ITEM NO
REVISION OF EACH ASSY NO (WHEN BLANK, USE DWG REVISION)					
PARTS LIST					

LOC
A
DIST
66

DIMENSIONS IN INCHES. DO NOT SCALE PRINT. TOLERANCES UNLESS OTHERWISE SPECIFIED.		MATL	HT TR	FIN
2 PLC DEC ±.25		DR	3/24/95	APP
4 PLC DEC ±.4		R O WILSON	4-18-95	A J BEDDICK
ANGLES ±		CHK 4-12-95	REL 9/20/95	B. MORGAN
SURF TEXTURE: ✓		AMP Incorporated Harrisburg, PA 17105-3608		
REMOVE BURRS, BREAK SHARP EDGES R.015 MAX		NAME END FEED HDM APPLICATOR		
SCALE		MACHINE REF MINI APPL		
D		SHEET 1 OF 1		
D		REV D		

THIS DRAWING IS A CONTROLLED DOCUMENT FOR AMP INCORPORATED. IT IS SUBJECT TO CHANGE AND THE CONTROLLING ENGINEERING ORGANIZATION SHOULD BE CONTACTED FOR THE LATEST REVISION.

THIS INFORMATION IS CONFIDENTIAL AND IS DISCLOSED TO YOU ON CONDITION THAT NO FURTHER DISCLOSURE IS MADE BY YOU TO OTHER THAN AMP PERSONNEL WITHOUT WRITTEN AUTHORIZATION FROM AMP INCORPORATED, HARRISBURG, PA.