

THIS DRAWING IS UNPUBLISHED. RELEASED FOR PUBLICATION  
 © COPYRIGHT - By - TE CONNECTIVITY ALL RIGHTS RESERVED.

LOC	DIST	REVISIONS					
CM	00	P	LTR	DESCRIPTION	DATE	DWN	APVD
		E		REVISED PER ECR-20-000814	26MAY2020	PC	SW

- 1 MATERIAL: CONNECTOR - NYLON UL94V-2 (ORANGE)  
 CONTACTS - 0.30 [.012] THICK COPPER ALLOY  
 BRIGHT TIN-LEAD 0.00203 [.000080] MIN THICK  
 FOR CONTACTS 644878-2 THRU 2-644878-4,  
 MATTE WHISKER MITIGATED TIN 0.00203 [.000080] MIN THICK  
 FOR CONTACTS 3-644878-2 THRU 5-644878-4
- 2 CONTACTS ACCEPT 18 AWG WIRE WITH 2.41 [.095] MAX  
 INSULATION DIAMETER.
- 3 CONTACTS MUST ACCEPT 1.14±0.03 [.045±.001] SQUARE  
 POST AND REMAIN LOCKED IN POSITION.
- 4 IDENTIFICATION NUMBER FOR LAST CIRCUIT MAY  
 NOT APPEAR ON ALL ASSEMBLIES.
- 5 DIMENSIONS IN BRACKETS ARE IN INCHES.
- 6 HOUSING FEATURES ARE: CLOSED END WITH LOCKING  
 RAMP AND POLARIZING TAB.
- 7 OBSOLETE PARTS: OBSOLETE CIS STREAMLINING PER D.RENAUD/D.SINISI
- 8 OBSOLETE PARTS

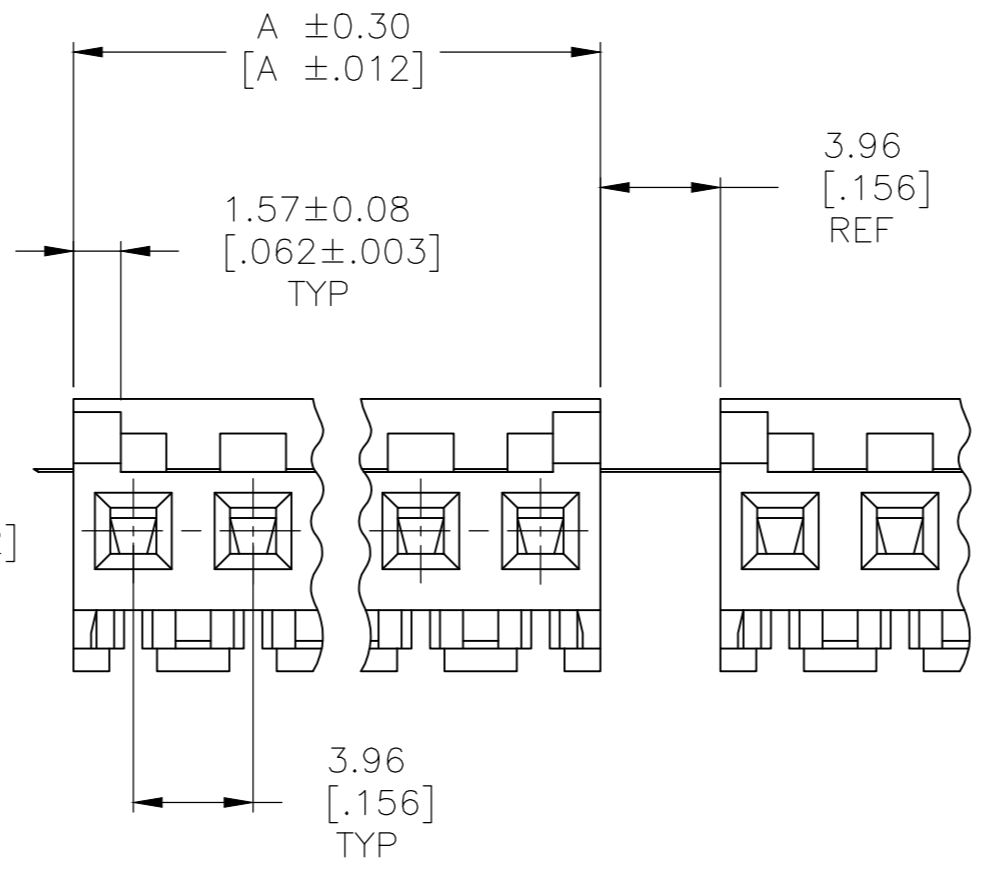
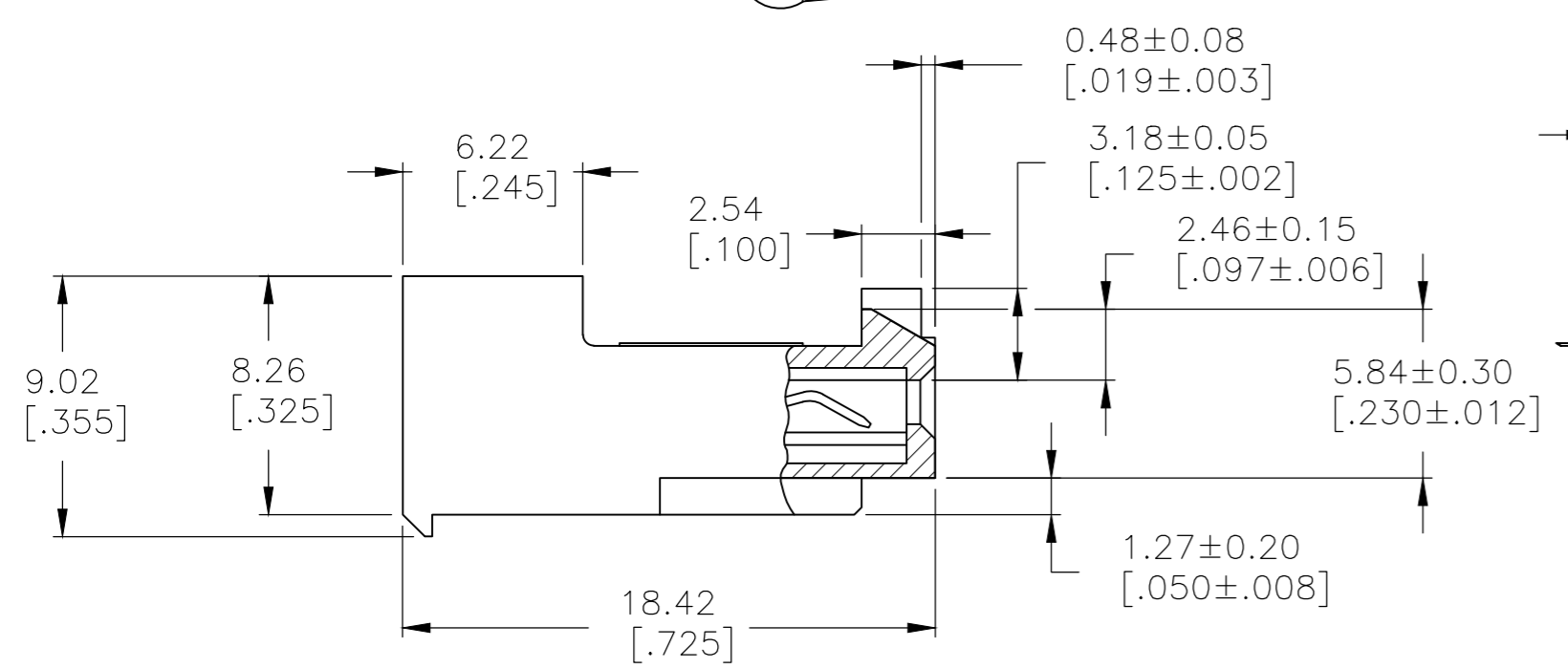
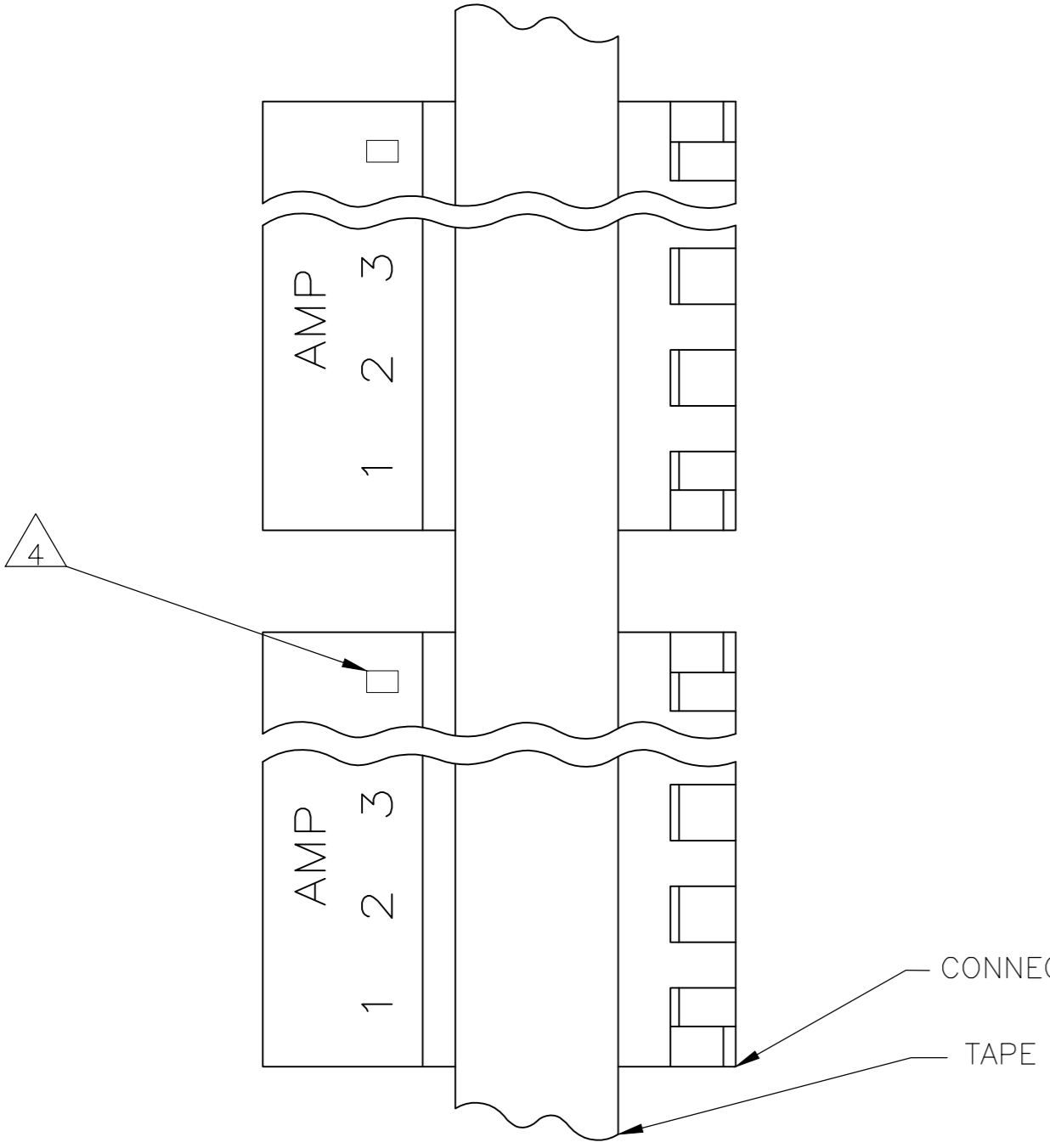

DIM A	NO. OF CIRCUITS	PART NO
95.10 [3.744]	24	5-644878-4
91.14 [3.588]	23	5-644878-3
87.17 [3.432]	22	5-644878-2
83.21 [3.276]	21	5-644878-1
79.25 [3.120]	20	5-644878-0
75.29 [2.964]	19	4-644878-9
71.32 [2.808]	18	4-644878-8
67.36 [2.652]	17	4-644878-7
63.40 [2.496]	16	4-644878-6
59.44 [2.340]	15	4-644878-5
55.47 [2.184]	14	4-644878-4
51.51 [2.028]	13	4-644878-3
47.55 [1.872]	12	4-644878-2
43.59 [1.716]	11	4-644878-1
39.62 [1.560]	10	4-644878-0
35.66 [1.404]	9	3-644878-9
31.70 [1.248]	8	3-644878-8
27.74 [1.092]	7	3-644878-7
23.77 [.936]	6	3-644878-6
19.81 [.780]	5	3-644878-5
15.85 [.624]	4	3-644878-4
11.89 [.468]	3	3-644878-3
7.92 [.312]	2	3-644878-2
95.10 [3.744]	24	<del>2-644878-4</del>
91.14 [3.588]	23	<del>2-644878-3</del>
87.17 [3.432]	22	<del>2-644878-2</del>
83.21 [3.276]	21	<del>2-644878-1</del>
79.25 [3.120]	20	<del>2-644878-0</del>
75.29 [2.964]	19	<del>1-644878-9</del>
71.32 [2.808]	18	<del>1-644878-8</del>
67.36 [2.652]	17	<del>1-644878-7</del>
63.40 [2.496]	16	<del>1-644878-6</del>
59.44 [2.340]	15	<del>1-644878-5</del>
55.47 [2.184]	14	<del>1-644878-4</del>
51.51 [2.028]	13	<del>1-644878-3</del>
47.55 [1.872]	12	<del>1-644878-2</del>
43.59 [1.716]	11	<del>1-644878-1</del>
39.62 [1.560]	10	<del>1-644878-0</del>
35.66 [1.404]	9	<del>644878-9</del>
31.70 [1.248]	8	<del>644878-8</del>
27.74 [1.092]	7	<del>644878-7</del>
23.77 [.936]	6	<del>644878-6</del>
19.81 [.780]	5	<del>644878-5</del>
15.85 [.624]	4	<del>644878-4</del>
11.89 [.468]	3	<del>644878-3</del>
7.92 [.312]	2	<del>644878-2</del>

7 SUPERSEDED  
 8 SUPERSEDED  
 8 SUPERSEDED  
 8 SUPERSEDED  
 8 SUPERSEDED  
 7 SUPERSEDED

THIS DRAWING IS A CONTROLLED DOCUMENT.

DIMENSIONS: mm [INCHES]	TOLERANCES UNLESS OTHERWISE SPECIFIED: 0 PLC ± - 1 PLC ± - 2 PLC ± 0.30[.012] 3 PLC ± - 4 PLC ± - ANGLES ± -	DWN R. VESTAL 25 MAY 95 CHK R. SWING 25 MAY 95 APVD D. CLARK 25 MAY 95 PRODUCT SPEC 108-1051 APPLICATION SPEC 114-1020	NAME MTA-156 CONNECTOR ASSEMBLY 18 AWG, STANDARD, TAPE MOUNTED
MATERIAL 1	FINISH 1	WEIGHT CUSTOMER DRAWING	SIZE A2 CAGE CODE 00779 DRAWING NO. C-644878 RESTRICTED TO - SCALE 4:1 SHEET 1 OF 1 REV E