

THIS DRAWING IS UNPUBLISHED. RELEASED FOR PUBLICATION
 © COPYRIGHT BY TYCO ELECTRONICS CORPORATION. ALL RIGHTS RESERVED.

LOC	DIST	REVISIONS			
P	LTR	DESCRIPTION	DATE	DWN	APVD
GA	1	A	PER LC20-0113-07 / ECO-07-008478	12APR07	DM BJ

1. DIMENSIONS ARE FOR REFERENCE ONLY
2. INHIBITOR IS APPLIED AT FACTORY TO GROOVES OF 'C' BODY AND WEDGE
3. WIRE SIZES ARE MARKED ON WEDGE
4. P/N 602007-1 IS INSTALLED WITH BATTERY TOOL ONLY.
P/N 602007 IS INSTALLED WITH AMP TOOL PART NO 69611.
(USE YELLOW SHELL PART NO. 69338-4).
5. APPEARANCE OF WEDGE AND ITS MARKING MAY VARY.

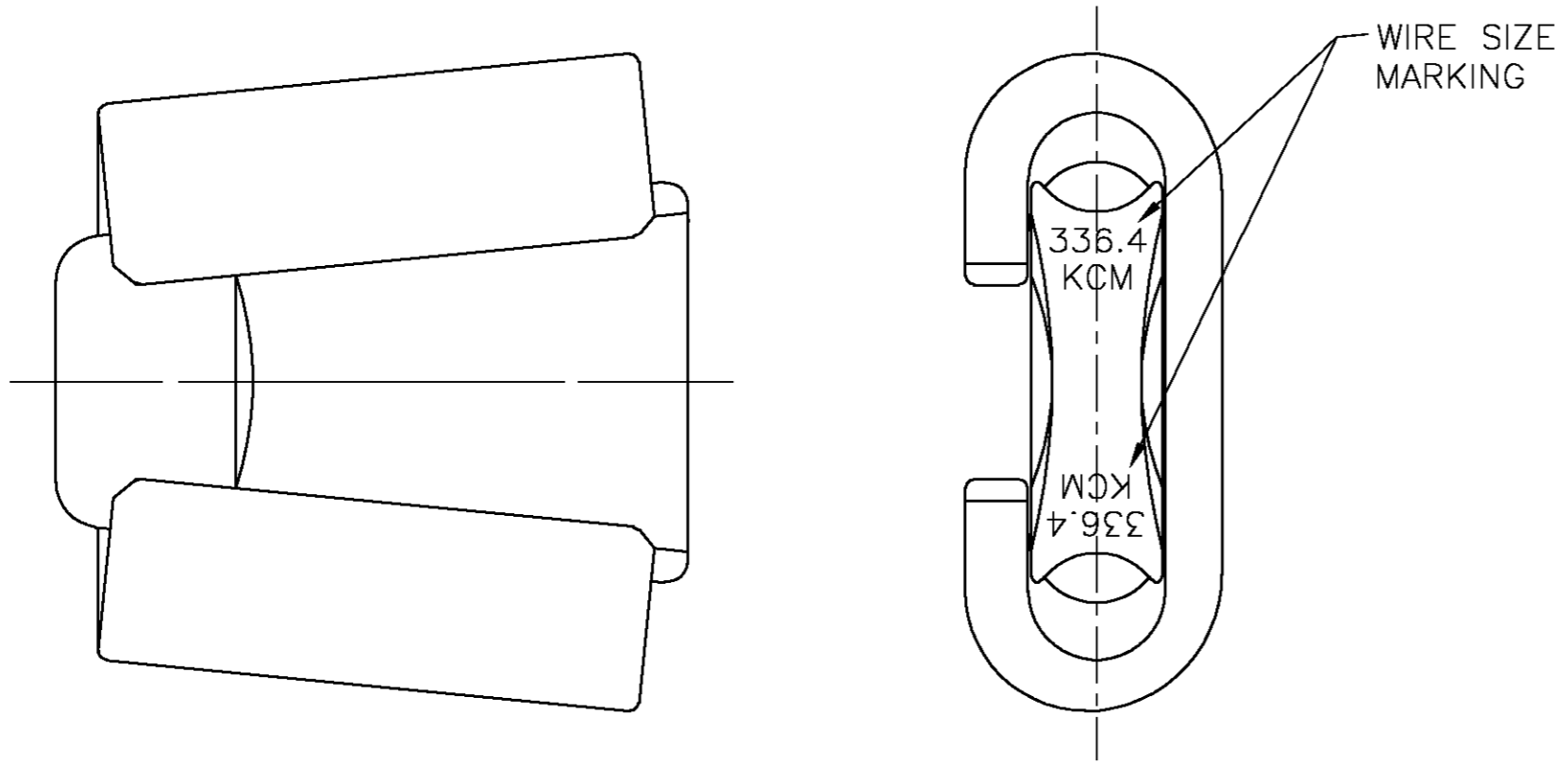
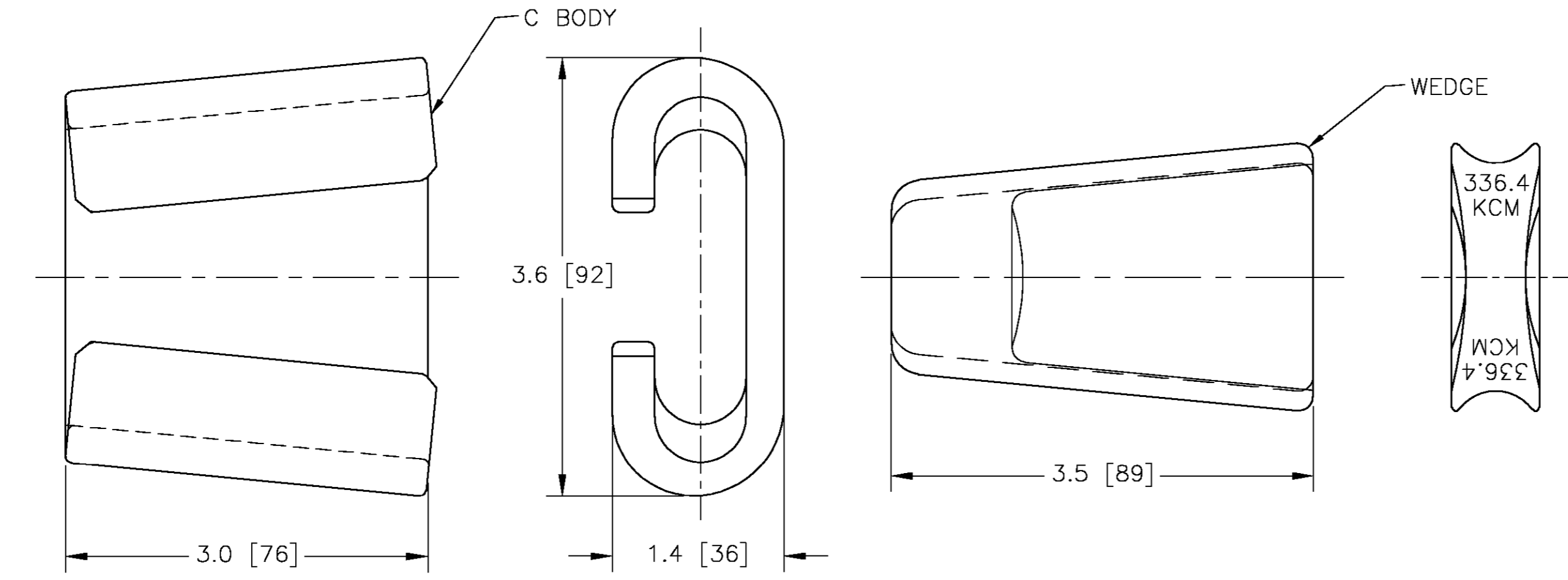

ALUMINUM ALLOY	ALUMINUM ALLOY	602007-1
		602007
WEDGE (QTY: 1)	"C" BODY (QTY: 1)	TYCO P/N

THIS DRAWING IS A CONTROLLED DOCUMENT.		DWN M. CHOW 11DEC97	Tyco Electronics Corporation Markham, ON L3R 1E1															
DIMENSIONS: INCHES		CHK H. HENRY 17DEC97	NAME P. CHAN 17DEC97															
TOLERANCES UNLESS OTHERWISE SPECIFIED:		PRODUCT SPEC																
<table border="0"> <tr><td>0 PLC</td><td>±</td></tr> <tr><td>1 PLC</td><td>±</td></tr> <tr><td>2 PLC</td><td>±</td></tr> <tr><td>3 PLC</td><td>±</td></tr> <tr><td>4 PLC</td><td>±</td></tr> <tr><td>ANGLES</td><td>±</td></tr> <tr><td>FINISH</td><td>±</td></tr> </table>		0 PLC	±	1 PLC	±	2 PLC	±	3 PLC	±	4 PLC	±	ANGLES	±	FINISH	±	APPLICATION SPEC		
0 PLC	±																	
1 PLC	±																	
2 PLC	±																	
3 PLC	±																	
4 PLC	±																	
ANGLES	±																	
FINISH	±																	
MATERIAL SEE TABLE		WEIGHT																
NONE		SIZE A2	CAGE CODE 00779	DRAWING NO C-602007														
CUSTOMER DRAWING		RESTRICTED TO	SCALE NTS	SHEET 1 OF 1														
		REV A																

602007