

THIS DRAWING IS A CONTROLLED DOCUMENT FOR AMP INCORPORATED. IT IS SUBJECT TO CHANGE AND THE CONTROLLING ENGINEERING ORGANIZATION SHOULD BE CONTACTED FOR THE LATEST REVISION.

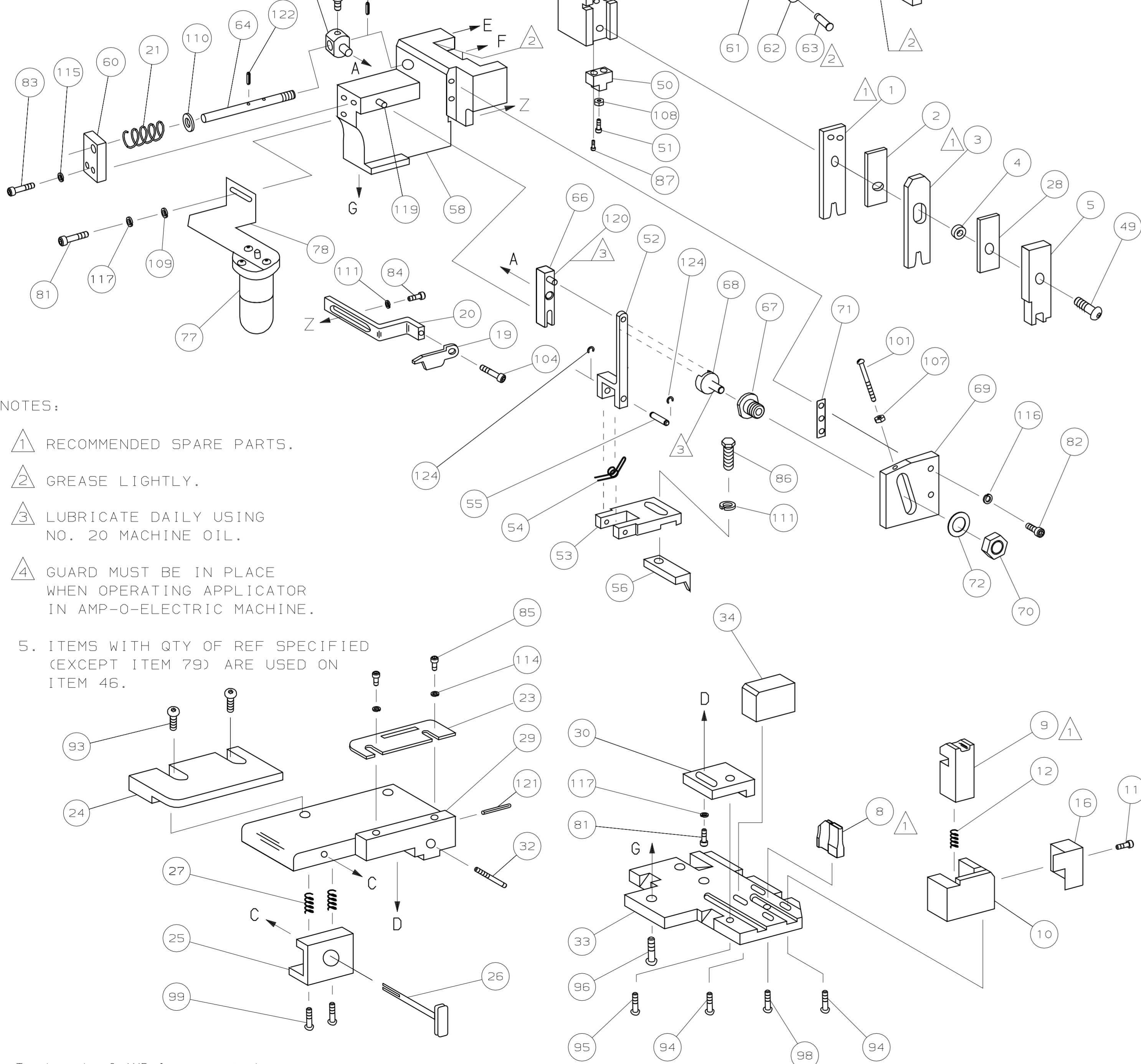
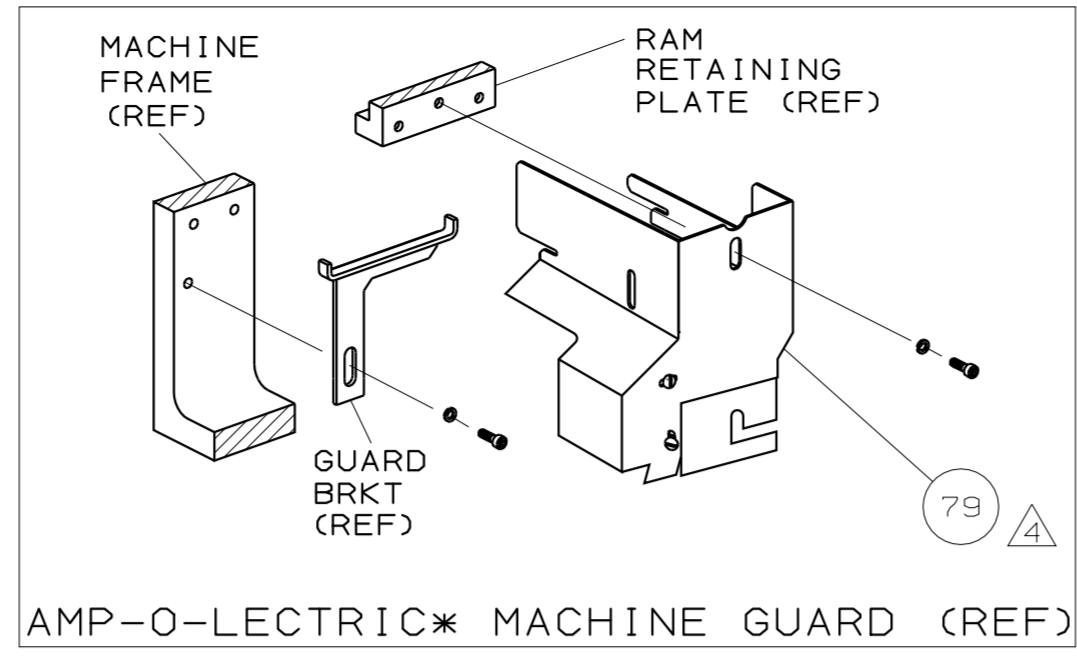
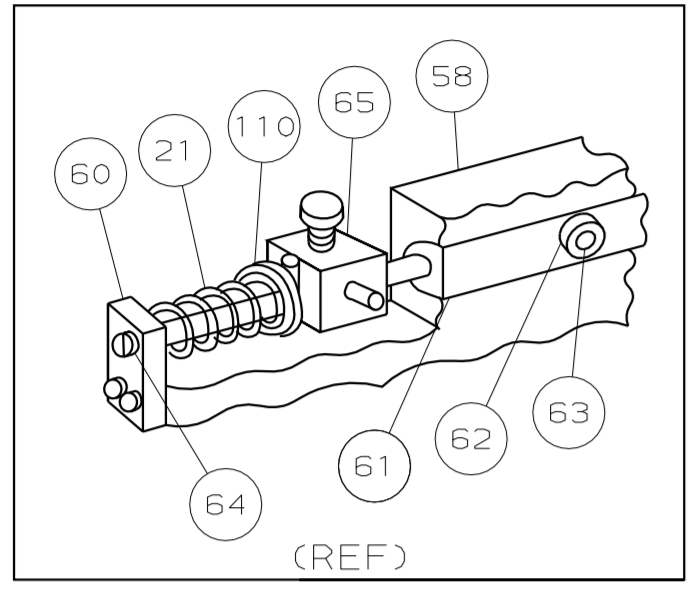
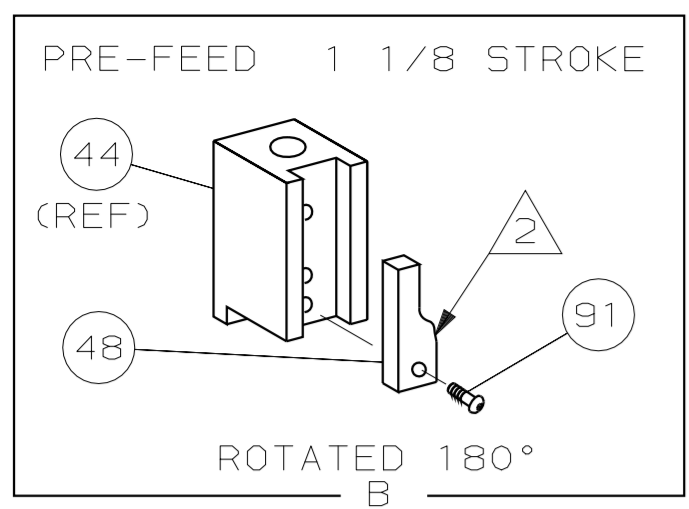

- NOTES:
- 1 RECOMMENDED SPARE PARTS.
  - 2 GREASE LIGHTLY.
  - 3 LUBRICATE DAILY USING NO. 20 MACHINE OIL.
  - 4 GUARD MUST BE IN PLACE WHEN OPERATING APPLICATOR IN AMP-O-ELECTRIC MACHINE.
5. ITEMS WITH QTY OF REF SPECIFIED (EXCEPT ITEM 79) ARE USED ON ITEM 46.

QTY	PART NO	DESCRIPTION	ITEM NO
2	21045-3	RING,RET "C"(1.87ø)FEED FINGER PIN	124
1	5-21028-1	PIN,SLT SPR(.125øx.50)ADJ ROD	123
1	4-21028-0	PIN,SLT SPR(.093øx.75)ST GUIDE PL	122
1	1-21030-1	PIN,DOWEL(.187øx.50)LEVER	120
1	1-21030-6	PIN,DOWEL(.187øx1.25)HOUSING	119
2	21024-5	WASHER,LOCK(NO.10)ADJ BLOCK	118
2	21024-5	WASHER,LOCK(NO.10)ADJ PLATE	117
2	21024-5	WASHER,LOCK(NO.10)FEED GUIDE ROD	116
2	21024-2	WASHER,LOCK(NO.4)FRONT STRIP GUIDE	115
			114
			113
			112
			111
4	21024-4	WASHER,LOCK(NO.8)STRIPPER	110
1	21899-4	WASHER,FLAT(5/16 DIA)SCREW ADJ	109
1	21899-2	WASHER,FLAT(NO.10)LUB ASSY	108
1	21018-5	NUT,HEX(NO.6)HOLDDOWN	107
1	21018-5	NUT,HEX(6-32)FEED ADJ	106
			105
			104
1	456567-1	SCR,SHLD(.188øx.125)STRIPPER	103
1	21009-2	SCR,SKT SET(1/4-20x.25LOC-WEL)RAM	102
2	21017-2	SCR,DRIVE(#2x.19)ID PLATE	101
1	6-23715-5	SCR,PAN HD(6-32x1.50)FEED ADJ	100
1	461264-1	PLATE, IDENTIFICATION	99
2	3-21002-0	SCR,BHC(10-32x.88)DRAG	98
1	22733-8	SCR,BHC(8-32x.38LOC-WEL)ANVIL	97
4	2-21002-9	SCR,BHC(10-32x.75)CAP	96
3	2-22733-8	SCR,BHC(1/4-20x.62)HOUSING	95
1	2-21002-7	SCR,BHC(10-32x.50)SG ADJ BLOCK	94
2	2-21002-2	SCR,BHC(8-32x.50)SHEAR	93
2	2-21000-6	SCR,BHC(8-32x.38)R STRIP GUIDE	92
1	1-21002-7	SCR,BHC(6-32x.38)CAM	91
			90
			89
			88
			87
			86
2	1-21000-6	SCR, SET CAP 4-40 X .62	85
1	2-22603-0	SCR,HEX HEAD(8-32x.31)FEED FINGER	84
2	1-21000-3	SCR,SKT CAP(4-40x.25)F STRIP GUIDE	83
1	2-21000-7	SCR,SKT CAP(8-32x.50)STRIPPER	82
2	3-21000-7	SCR,SKT CAP(10-32x.75)FEED ROD GD	81
2	3-21000-6	SCR,SKT CAP(10-32x.62)FEED ADJ BLK	80
2	3-21000-4	SCR,SKT CAP(10-32x.38)SG ADJ BL	79
2	3-21000-4	SCR,SKT CAP(10-32x.38)PIVOT BLOCK	78
REF	455749-1	GUARD, WINDOW	77
1	1-465184-0	LUBRICATOR ASSY	76
-	-	-	75
			74
			73
			72
			71
			70
			69
			68
			67
			66
			65
			64
			63
			62
			61
			60
			59
			58
			57
			56
			55
			54
			53
			52
			51
			50
			49
			48
			47
			46
			45
			44
			43
			42
			41
			40
			39
			38
			37
			36
			35
			34
			33
			32
			31
			30
			29
			28
			27
			26
			25
			24
			23
			22
			21
			20
			19
			18
			17
			16
			15
			14
			13
			12
			11
			10
			9
			8
			7
			6
			5
			4
			3
			2
			1

REMARKS	NO	REV
APPL USED ON MACHINE PART NO	MACH SERIAL NO	DISTRIBUTION
CUSTOMER NAME	APPL SERIAL NO	ORIGINAL
ADDRESS	PURCHASE ORDER	CUSTOMER COPY
CITY	ENG APP	FIELD ENG COPY

CRIMPING DATA			APPLICATOR WILL APPLY	
PAD LTR	CRIMP HEIGHT	WIRE SIZE	66341	
A	NOT	USED	213543-2	
B	.035	22,24,OR 26 *		
C	.033	2 (30'S)		
D	NOT	USED		
CRIMP	SIZE	TYPE	FEED	APPL INST
WIRE	.054	F	.350	A1 8040
INSUL	.110	0		
WIRE RANGE	26-22	INSULATION RANGE	.028-.054	MACHINE NO
REMARKS				
AMP-O-ELECTRIC PRE-FEED * (2) 26 OR (2) 29 WIRES MAY BE USED AT THIS CRIMP HEIGHT				

THIS INFORMATION IS CONFIDENTIAL AND IS DISCLOSED TO YOU ON CONDITION THAT NO FURTHER DISCLOSURE IS MADE BY YOU TO OTHER THAN AMP PERSONNEL WITHOUT WRITTEN AUTHORIZATION FROM AMP INCORPORATED, HARRISBURG, PA.

SET UP GAGE	10-1	AMP INCORPORATED
458637-1	L1322-1	Harrisburg, Pa.
DR 11-13-92	APP -	
N. O'BRIEN		
CHK -	REL -	LOC A
		D NO 567313-4
		REV A
NAME	MINIATURE QUICK CHANGE APPLICATOR	
SIDE FEED	( SERPENT )	