

CONNECTOR TYPE

OSCS PANEL FEEDTHROUGH
 HERMETIC PLUG RECEPTACLE
 COMPRESSION SEAL WITH GASKET

TOOLS REQUIRED:

250-36,UNS-2B BOTTOMING TAP: 2098-5619-54
 STEP REAMER: 2098-0442-54
 TORQUE WRENCH: 2098-5619-54

CONNECTOR

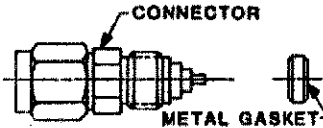

ASSEMBLY OPERATIONS

- 1.0 MOUNTING HOLE PREPARATION**
- 1.1 DRILL $.066 + .001$ DIAMETER HOLE THROUGH PANEL.
 - 1.2 INSERT STEP REAMER INTO PILOT HOLE AND REAM TO DEPTH SHOWN.
 - 1.3 TAP $.250 -36$ THREAD TO DEPTH SHOWN.

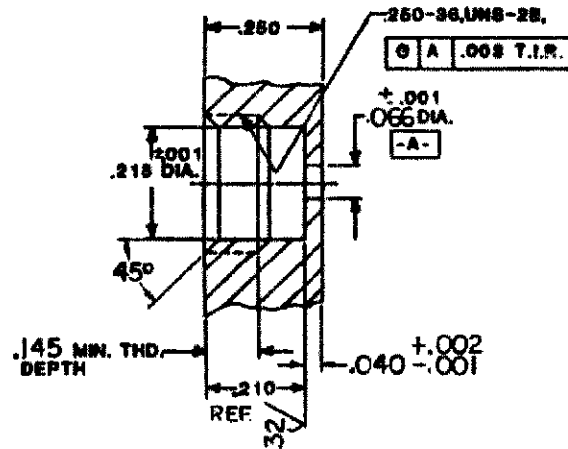

- 2.0 INSTALLATION OF CONNECTOR INTO PANEL**
- 2.1 ASSEMBLE METAL BUSHING ONTO CONNECTOR.
 - 2.2 THREAD CONNECTOR INTO MOUNTING HOLE.
 - 2.3 TORQUE CONNECTOR TO 25-30 IN. LBS.
 - 2.4 ASSEMBLY IS NOW COMPLETE.

