

REVISIONS				
#	CTH	DESCRIPTION	DATE	OWN APVD
A1		ECO-17-006000	02MAY2017	MH DS
B		REVISED PER ECO-19-005220	04APR2019	AP RP
C		REVISED PER ECO-19-011912	05AUG2019	AP RP
D		REVISED PER ECN-21-114708	26AUG2021	RZ HL

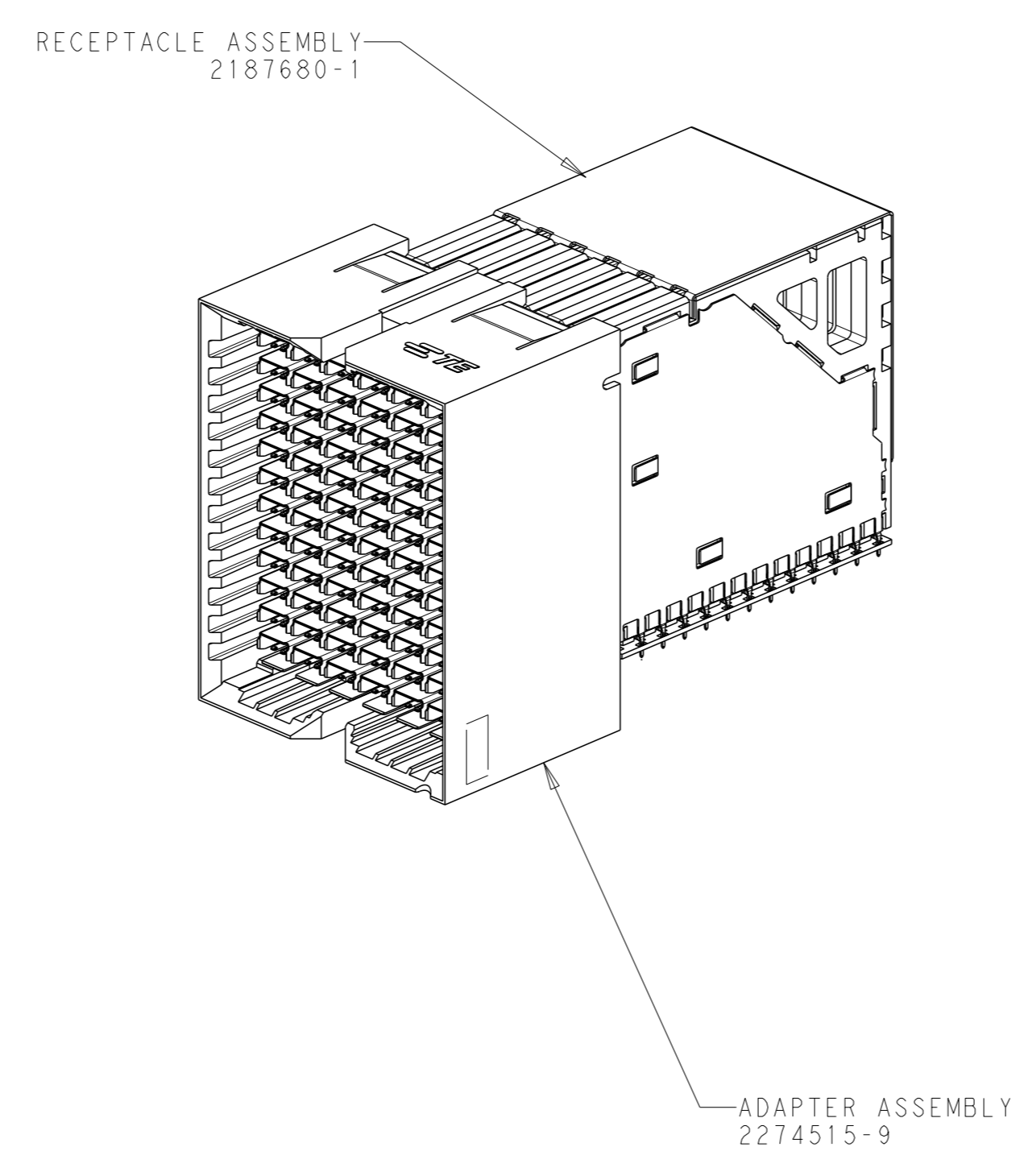

SCALE 2:1

- 1 CONTACTS AND SHIELDS - COPPER ALLOY  
 CLIP - STAINLESS STEEL  
 HOUSINGS, GROUND SHELLS, AND ORGANIZER - THERMOPLASTIC, UL 94V-0, BLACK
- 2 CONFORMS TO THE REQUIREMENTS OF TE PRODUCT SPECIFICATION 108-32112  
 BASED ON TELCORDIA GR-1217-CORE FOR SYSTEM QUALITY LEVEL III,  
 APPLICATIONS IN CONTROLLED ENVIRONMENTS (CENTRAL OFFICE).  
 COMPLIANT PIN AREA: 0.5µm MIN MATTE TIN.
- 3 GROUND PLATED THRU HOLE REQUIREMENTS:  
 FINISHED HOLE =  $\varnothing 0.34 \pm 0.05$   
 HOLE SIZE PRIOR TO PLATING =  $\varnothing 0.420 \pm 0.025$   
 COPPER THICKNESS = 0.025 MIN  
 IMMERSION TIN IF APPLICABLE = (0.00095)
- 4 SIGNAL PLATED THRU HOLE REQUIREMENTS:  
 FINISHED HOLE =  $\varnothing 0.24 \pm 0.04$   
 HOLE SIZE PRIOR TO PLATING =  $\varnothing 0.320 \pm 0.025$   
 COPPER THICKNESS = 0.025 MIN  
 IMMERSION TIN IF APPLICABLE = (0.00095)
- 5 SI VIA PLATED THRU HOLE REQUIREMENTS:  
 FINISHED HOLE =  $\varnothing 0.34 \pm 0.05$   
 HOLE SIZE PRIOR TO PLATING =  $\varnothing 0.420 \pm 0.025$   
 COPPER THICKNESS = 0.025 MIN  
 IMMERSION TIN IF APPLICABLE = (0.00095)
- 6 SI VIAS & SIGNAL HOLES:  
 PTH DIMENSIONS APPLY TO THE TOP 1.00mm OF THE PCB THICKNESS FROM THE  
 CONNECTOR MOUNTING SIDE.  
 GROUND HOLES:  
 PTH DIMENSIONS APPLY TO THE TOP 1.25mm OF THE PCB THICKNESS FROM THE  
 CONNECTOR MOUNTING SIDE.
- 8 DATUMS AND BASIC DIMENSIONS ESTABLISHED BY CUSTOMER
- 9 APPLIES TO FINISHED HOLE DIAMETER.
- 10 CONNECTOR MARKED WITH ASSEMBLY PART NUMBER, DATE CODE, AND "100 OHM"  
 IN APPROXIMATE AREA SHOWN.

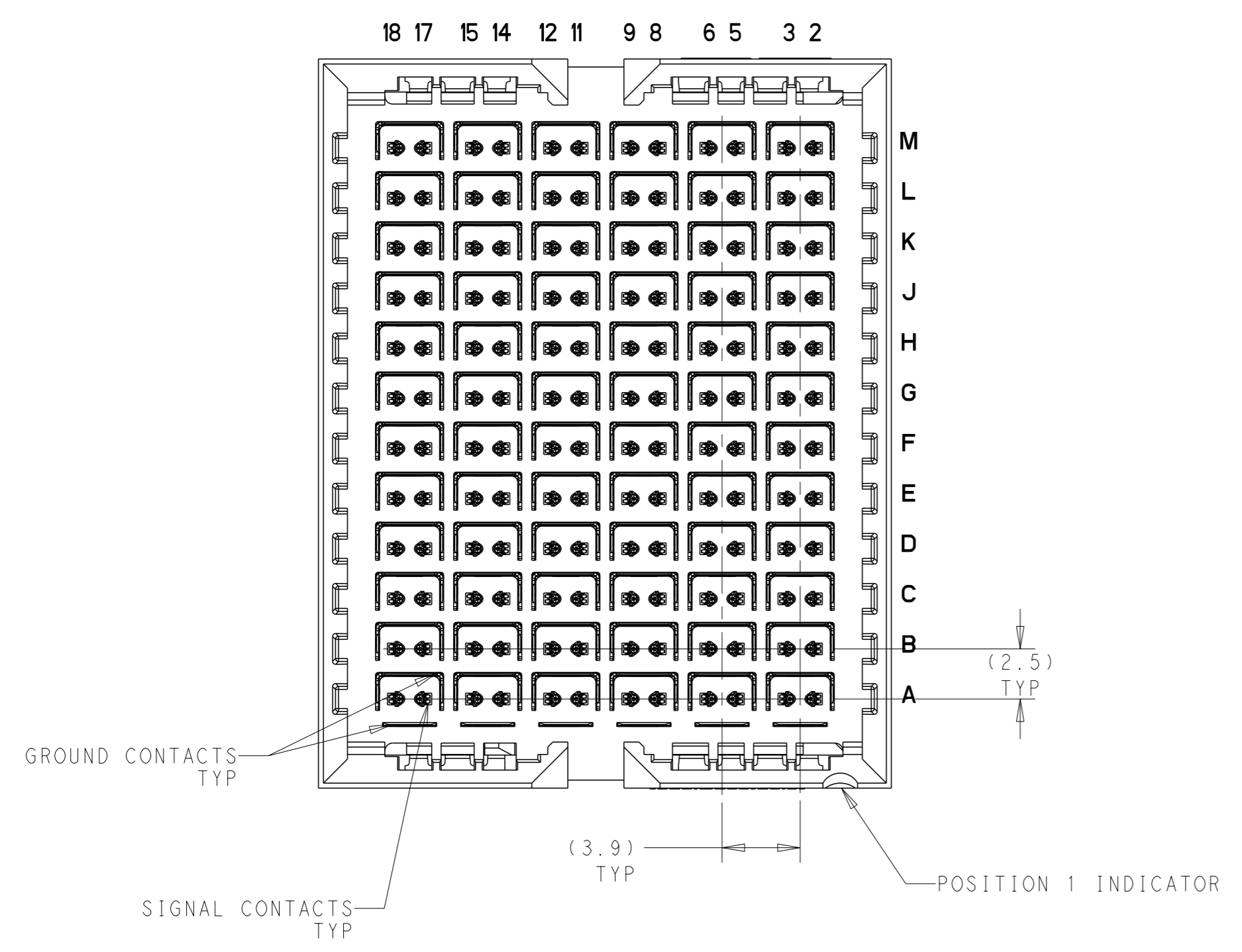
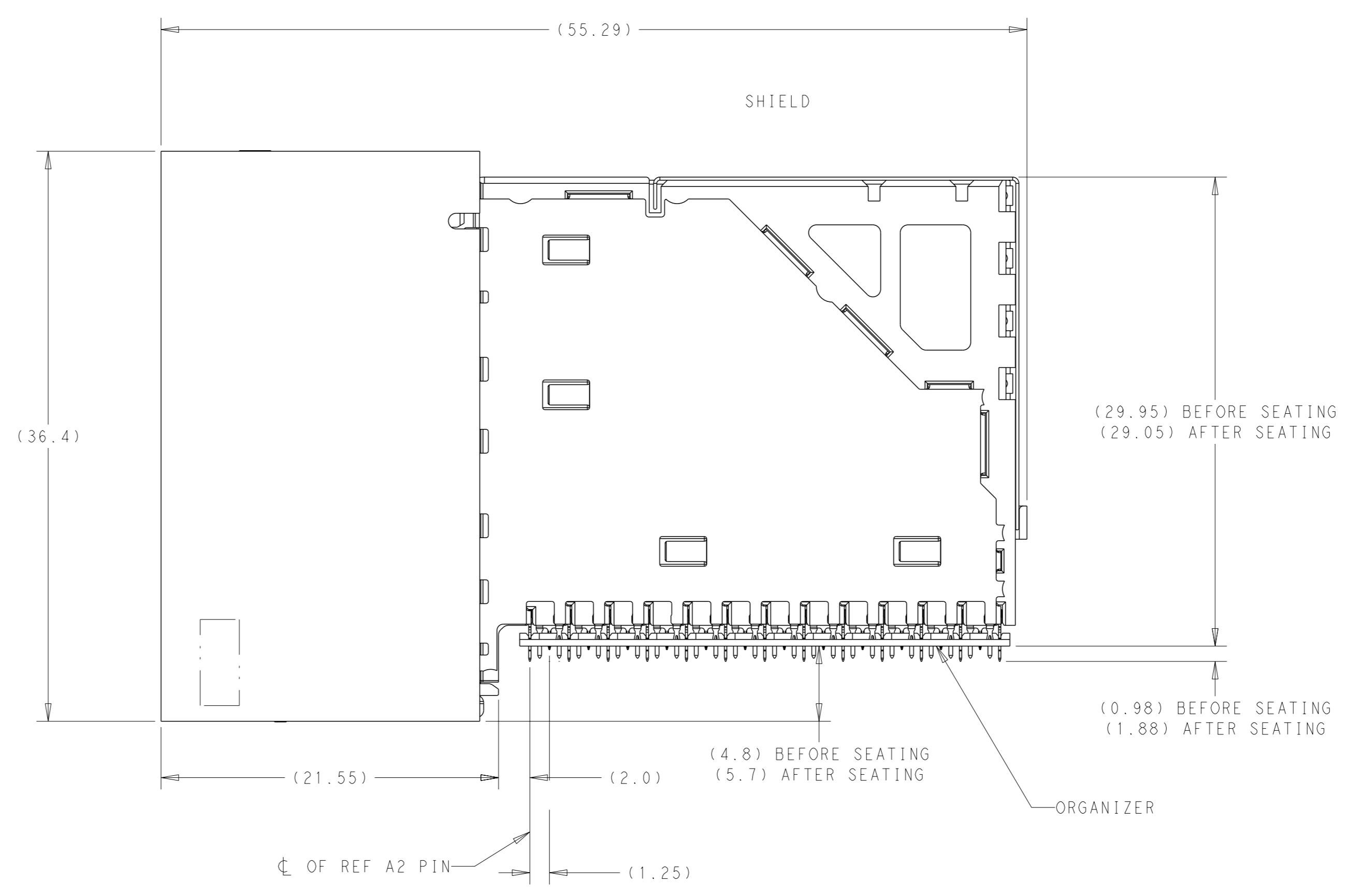
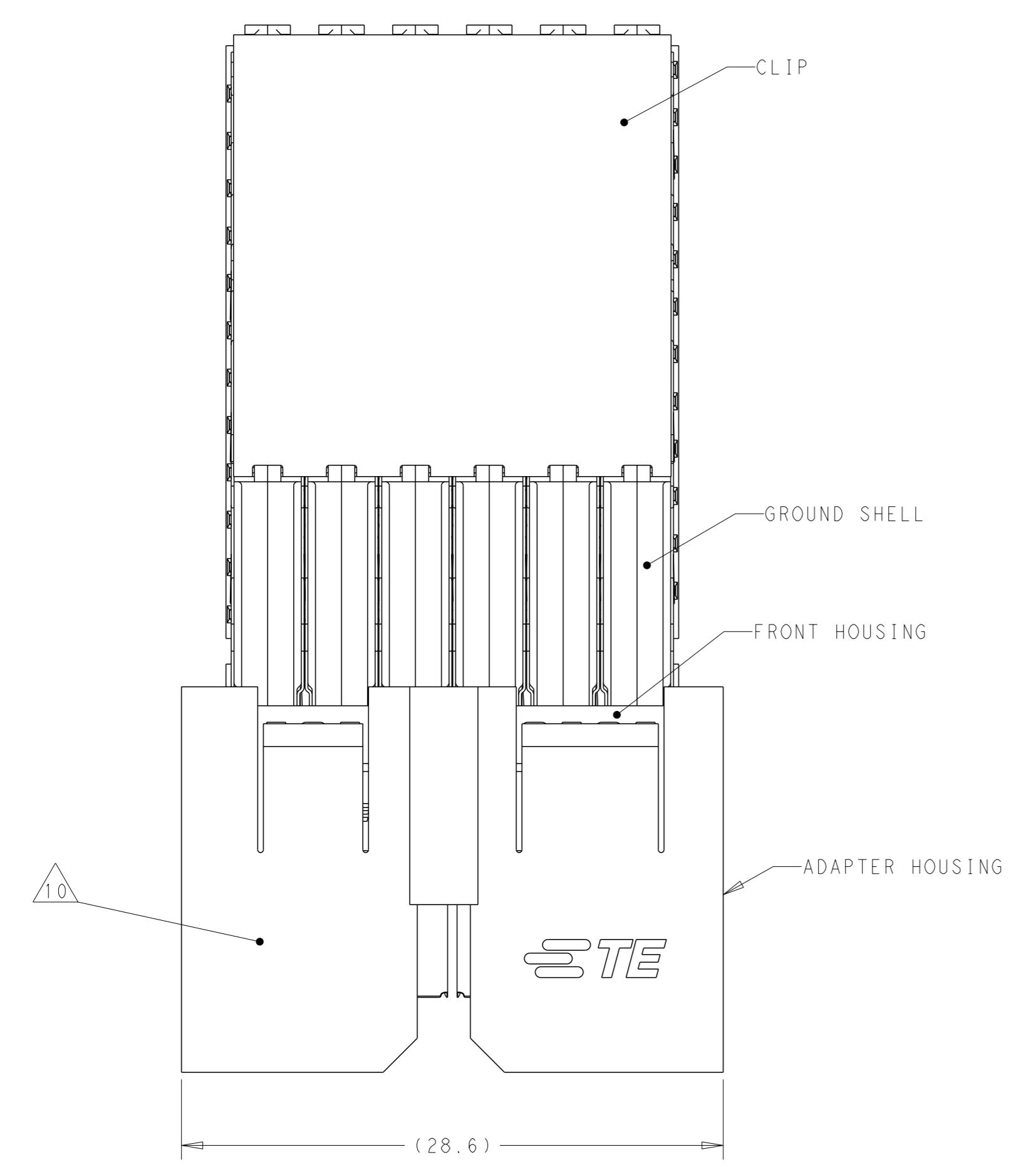

2274518-1  
 PART NUMBER

THIS DRAWING IS A CONTROLLED DOCUMENT.		OWN M. SHIRK 07APR2014	TE Connectivity NAME RIGHT ANGLE ADAPTER ASSEMBLY, 12 PAIR 6 COLUMN, 100 OHM DPO, STRADA WHISPER
DIMENSIONS:		CHK J. McCLELLAN 07APR2014	
mm	0 PLC ±	APVD J. McCLELLAN 07APR2014	PRODUCT SPEC
	1 PLC ±0.25	APPLICATION SPEC	SIZE
	2 PLC ±0.13	114-32120	A1
	3 PLC ±	WEIGHT	RESTRICTED TO
	4 PLC ±		
	ANGLES		
	FINISH		
MATERIAL		CUSTOMER DRAWING	

SCALE 4:1 SHEET 1 OF 2 REV D

REVISIONS				
#	DATE	DESCRIPTION	OWN	APVD
-	-	SEE SHEET 1	-	-

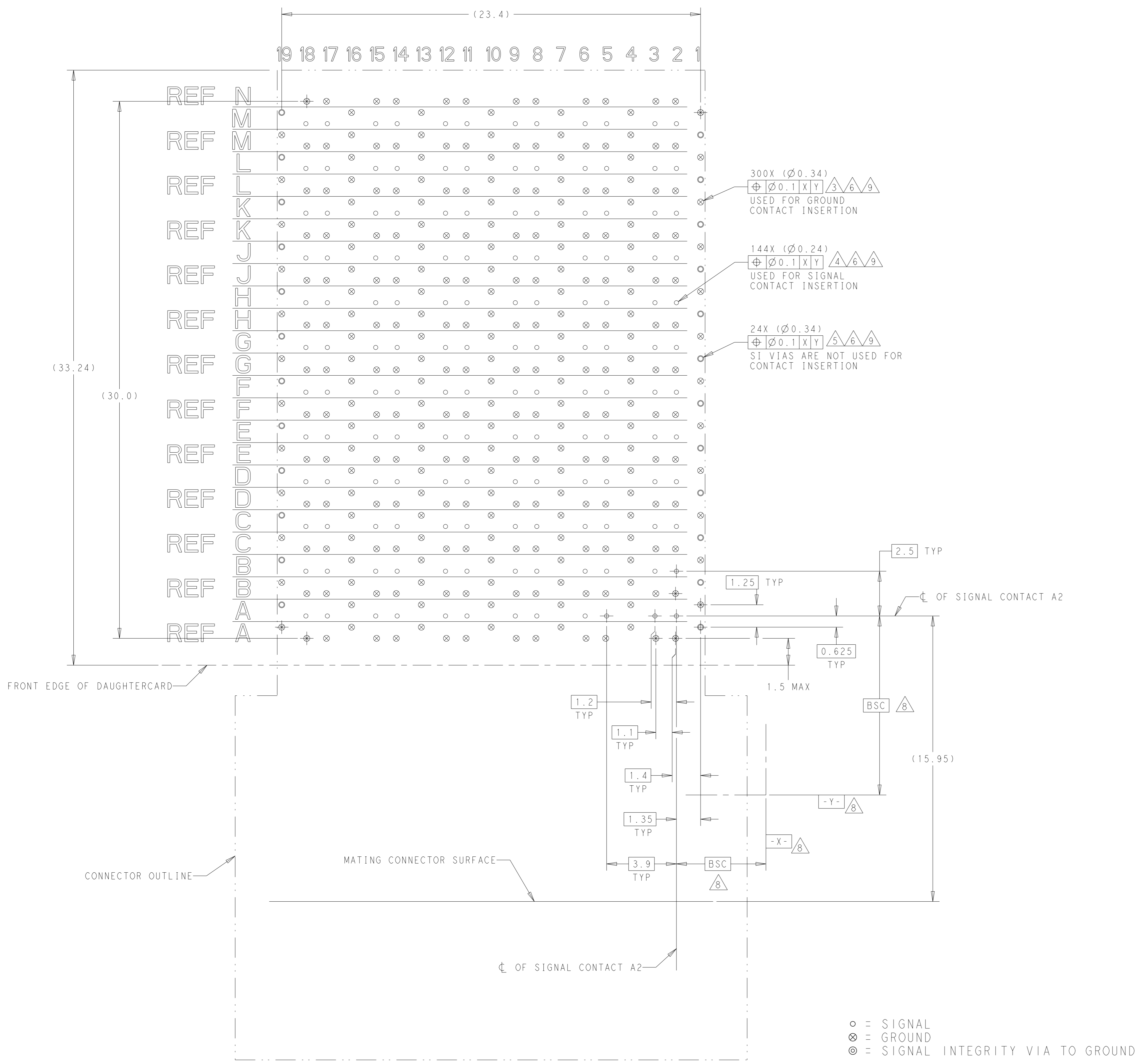

○ = SIGNAL  
 ⊗ = GROUND  
 ⊙ = SIGNAL INTEGRITY VIA TO GROUND

RECOMMENDED PCB LAYOUT  
 SINGLE CONNECTOR (NON-STACKING)  
 COMPONENT SIDE SHOWN  
 SCALE 8:1

THIS DRAWING IS A CONTROLLED DOCUMENT.		OWN: M. SHIRK 07APR2014	TE Connectivity
DIMENSIONS: mm		CHK: J. McCLELLAN 07APR2014	
TOLERANCES UNLESS OTHERWISE SPECIFIED:		APVD: J. McCLELLAN 07APR2014	NAME: RIGHT ANGLE ADAPTER ASSEMBLY, 12 PAIR 6 COLUMN, 100 OHM DPO, STRADA WHISPER
0 PLC ±	1 PLC ±0.25	PRODUCT SPEC	SIZE: A1
2 PLC ±0.13	3 PLC ±	APPLICATION SPEC	CAGE CODE: 114-32120
4 PLC ±	ANGLES ±	FINISH ±	RESTRICTED TO: -
MATERIAL: -	WEIGHT: -	CUSTOMER DRAWING	SCALE: 4:1 SHEET: 2 OF 2 REV: D

Printed on 30-Aug-2021 10:47:47 China Standard Time from TE423832