

2138755-1 (WITH FLANGE)

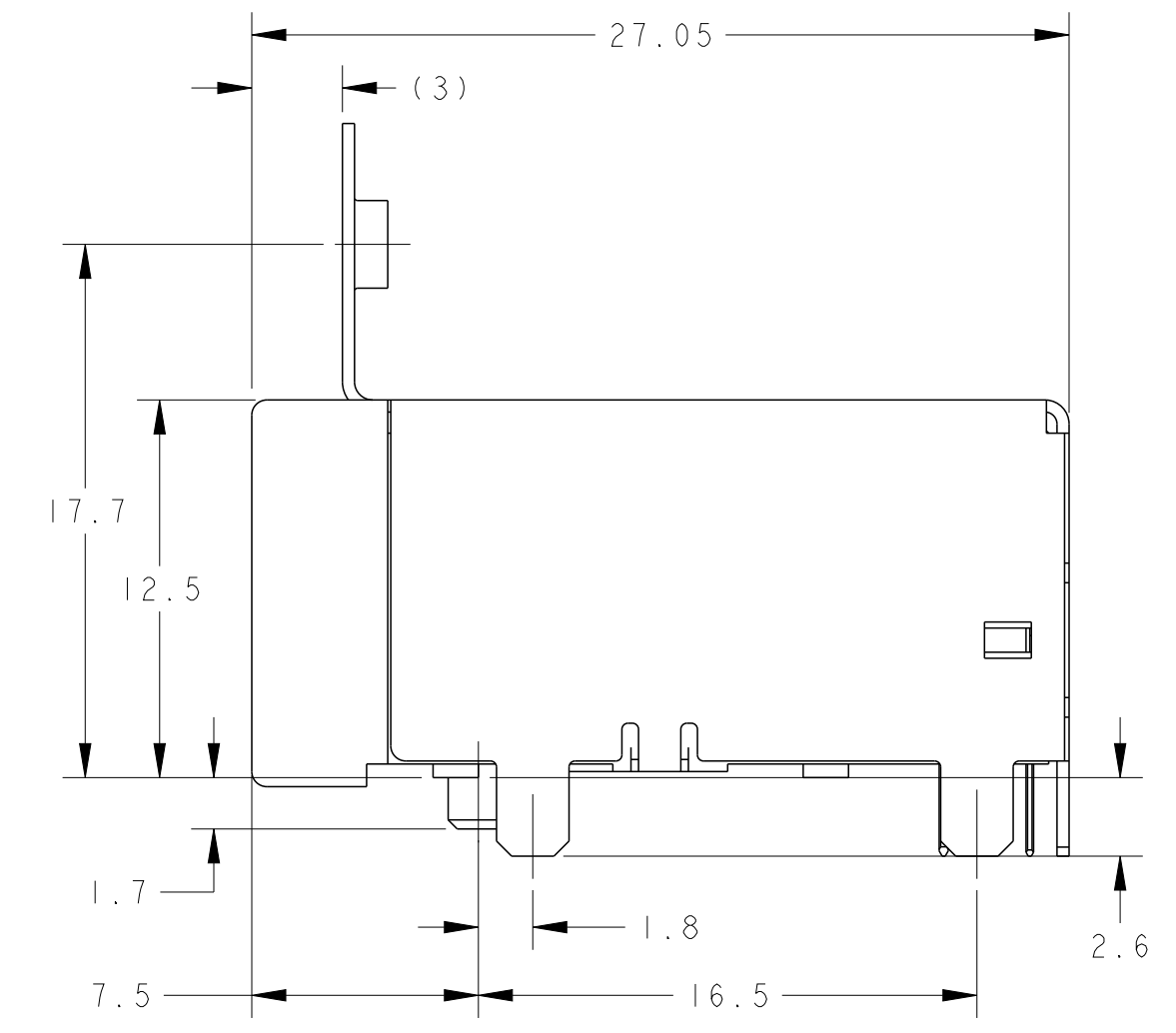

2138755-2 (WITHOUT FLANGE)

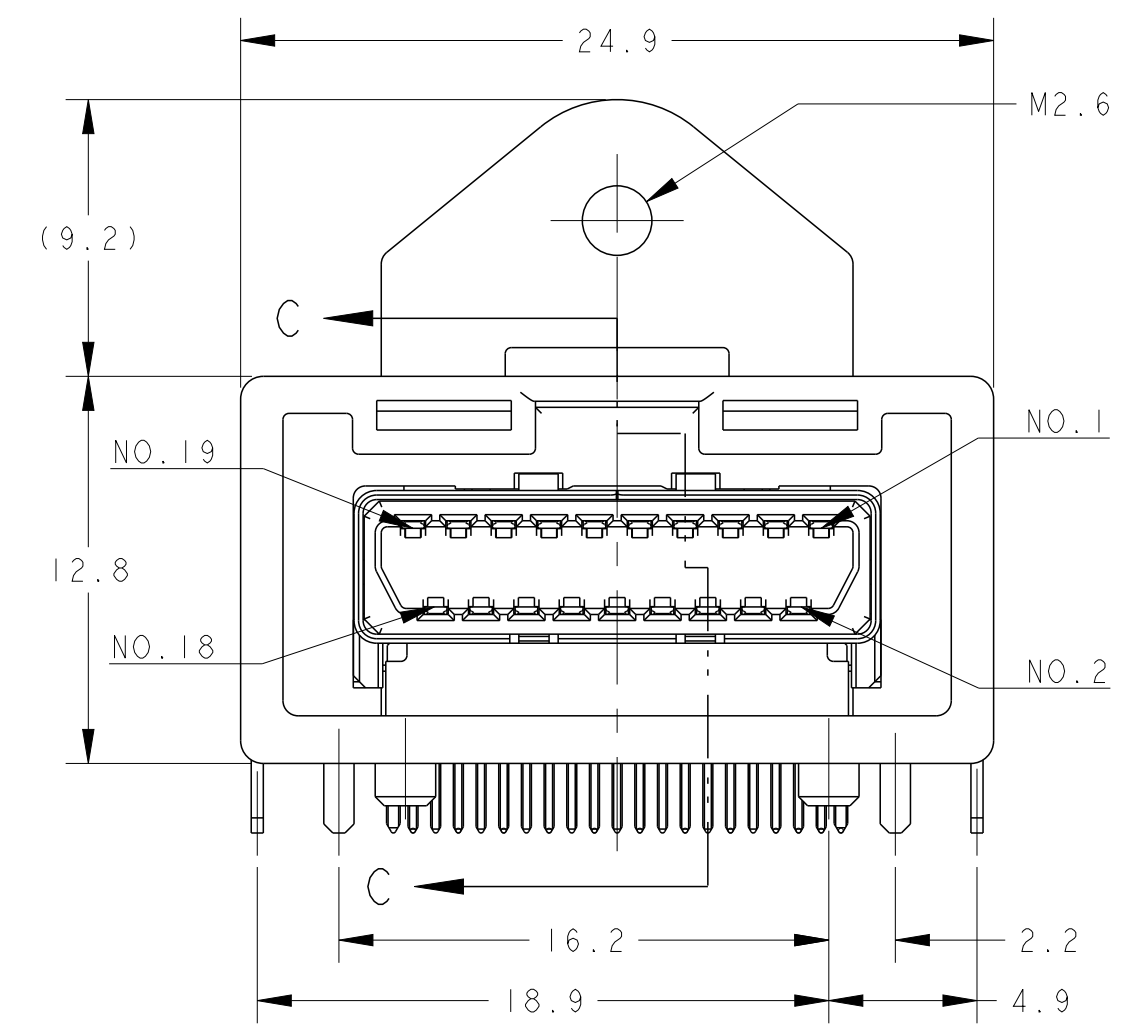
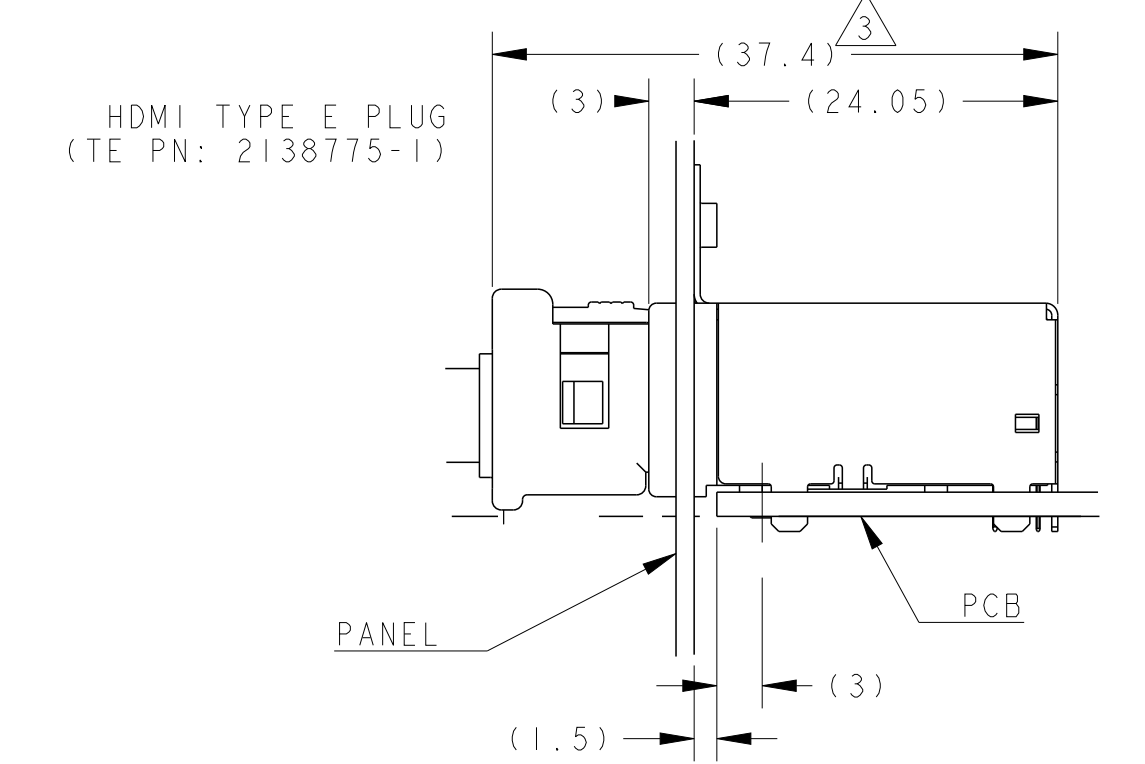
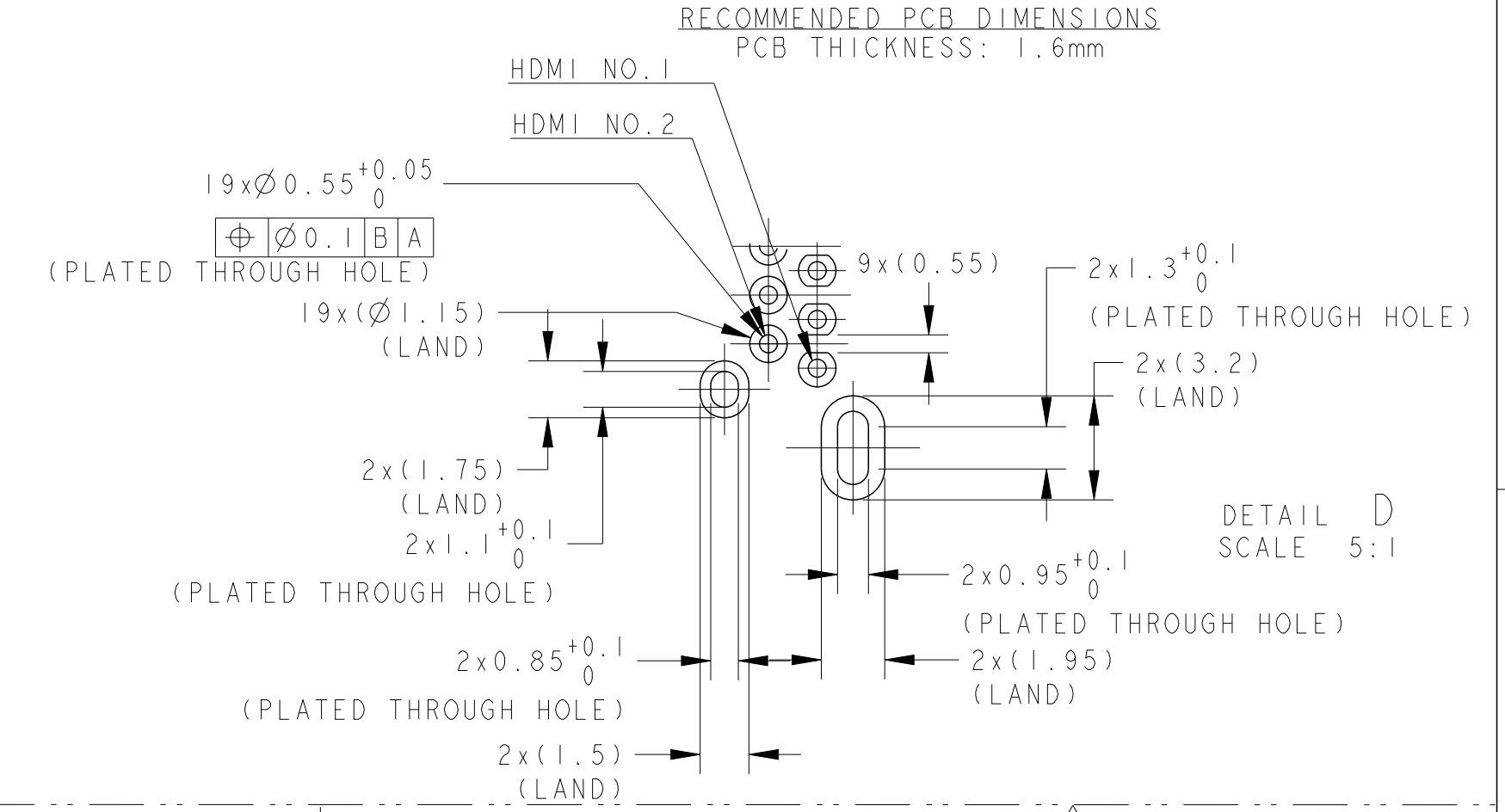
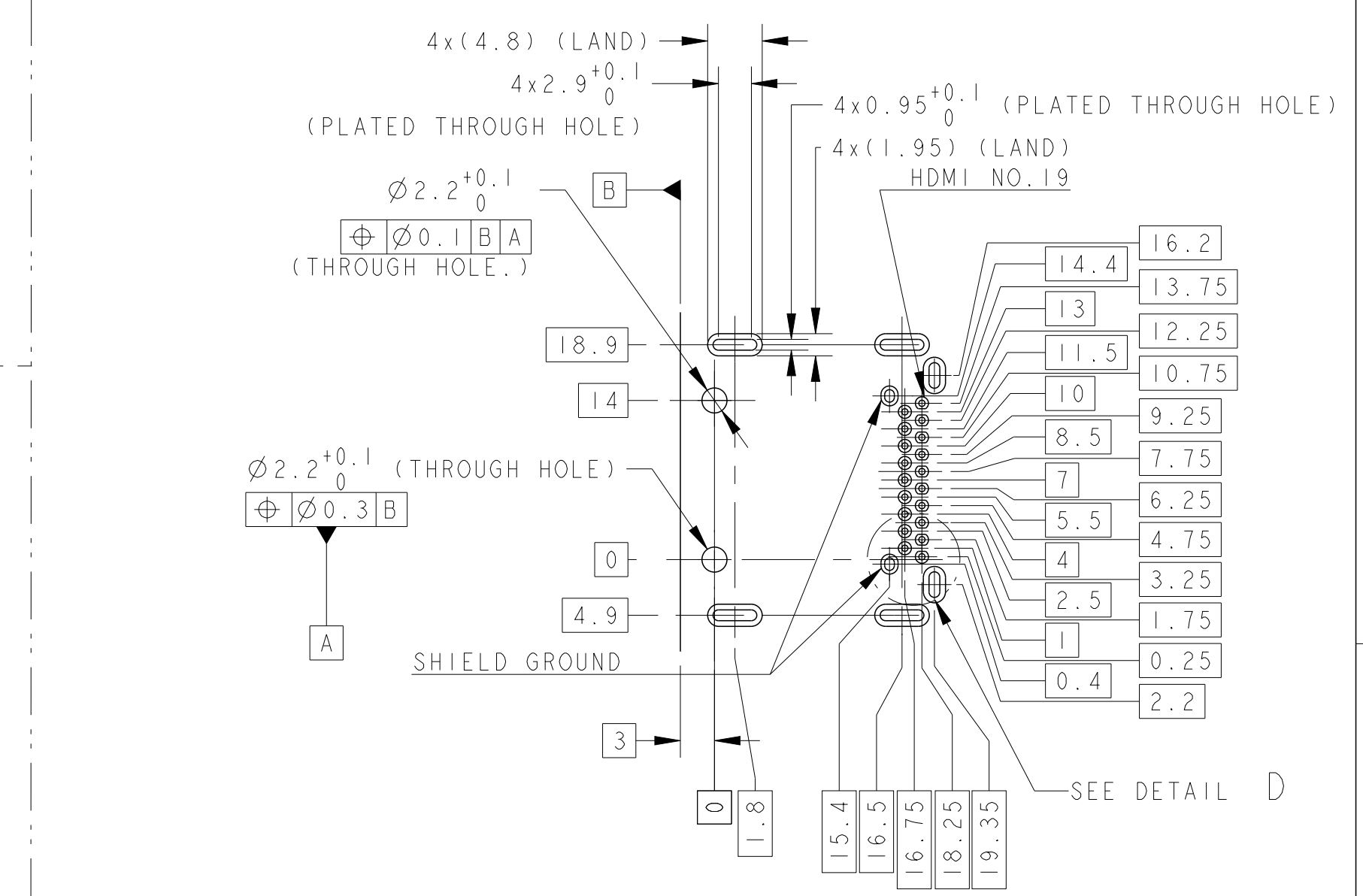
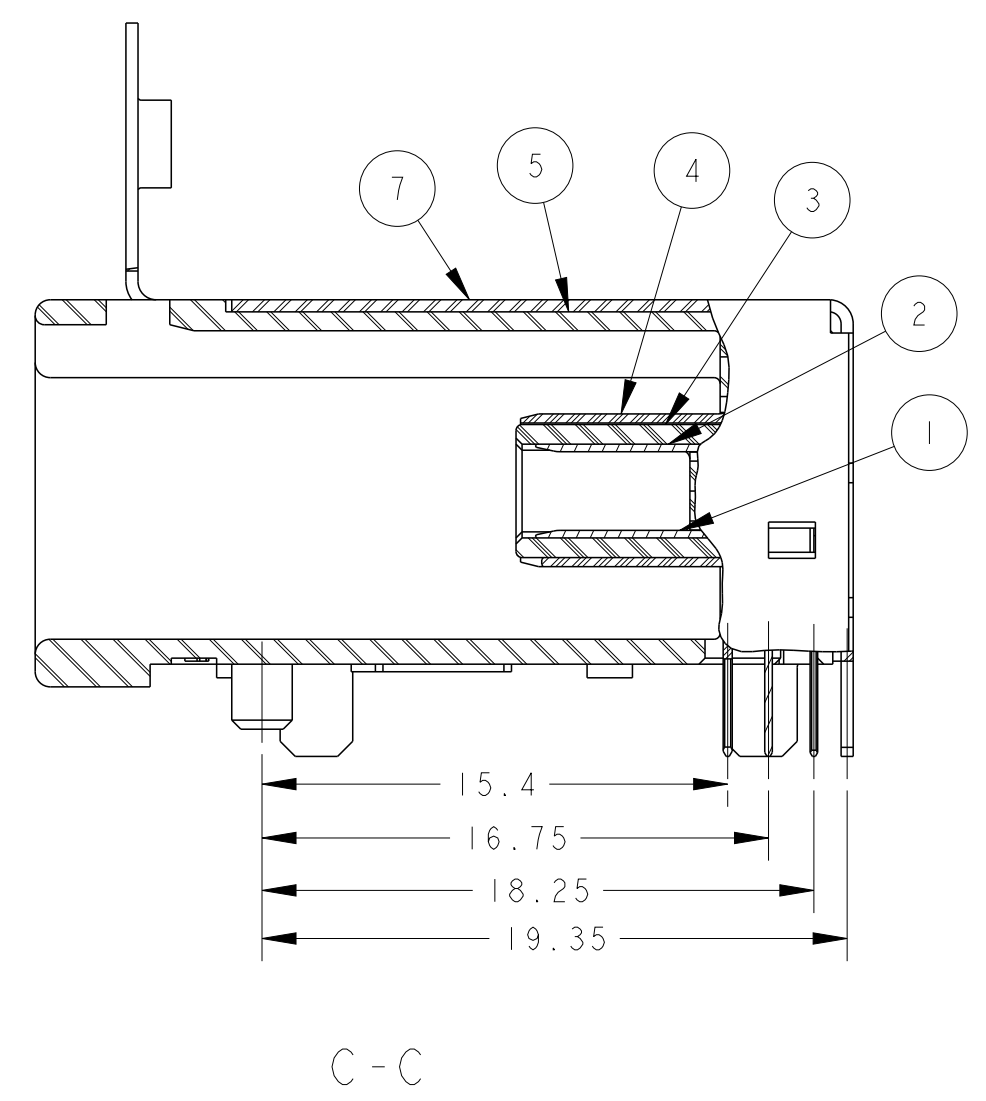
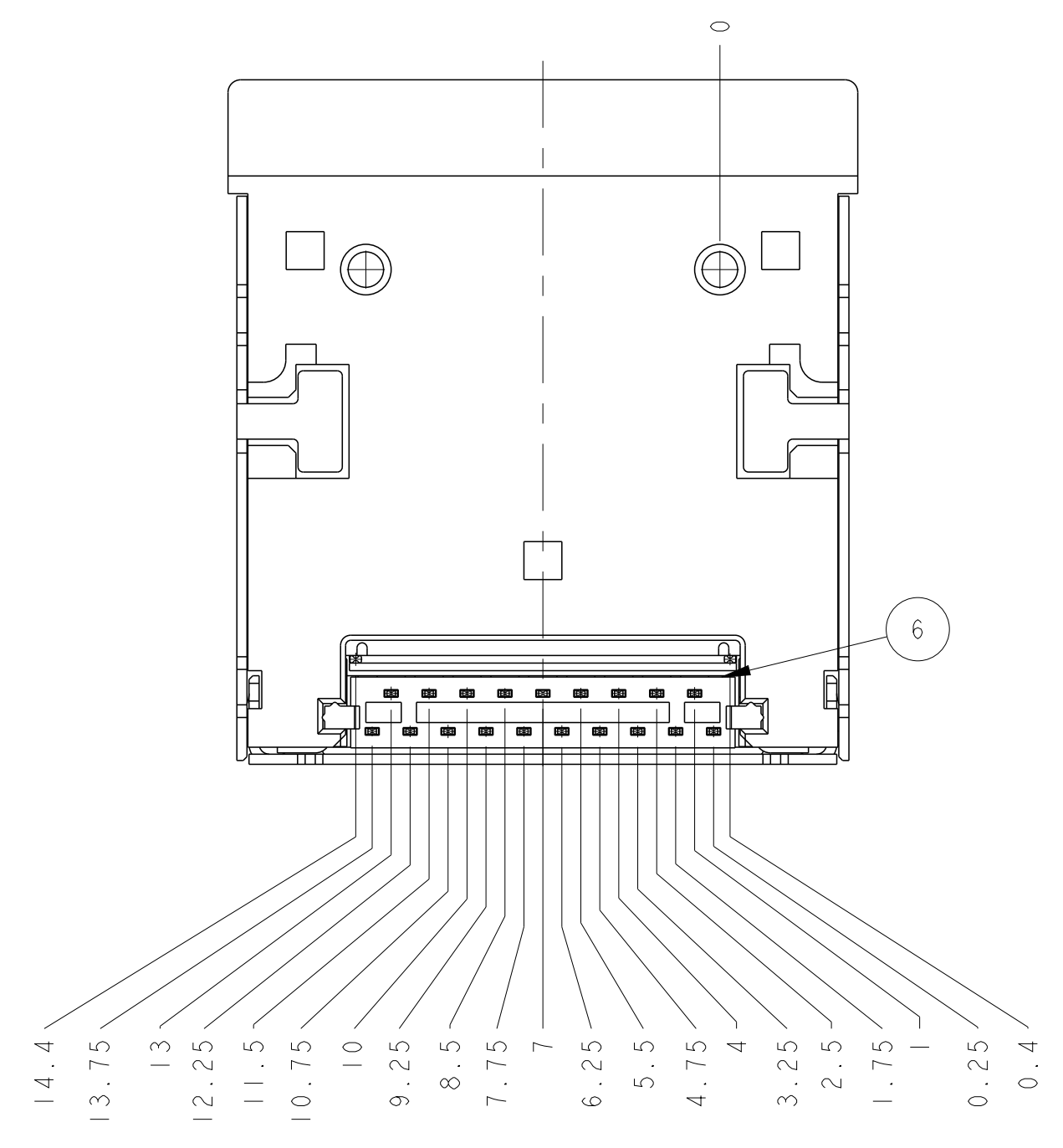
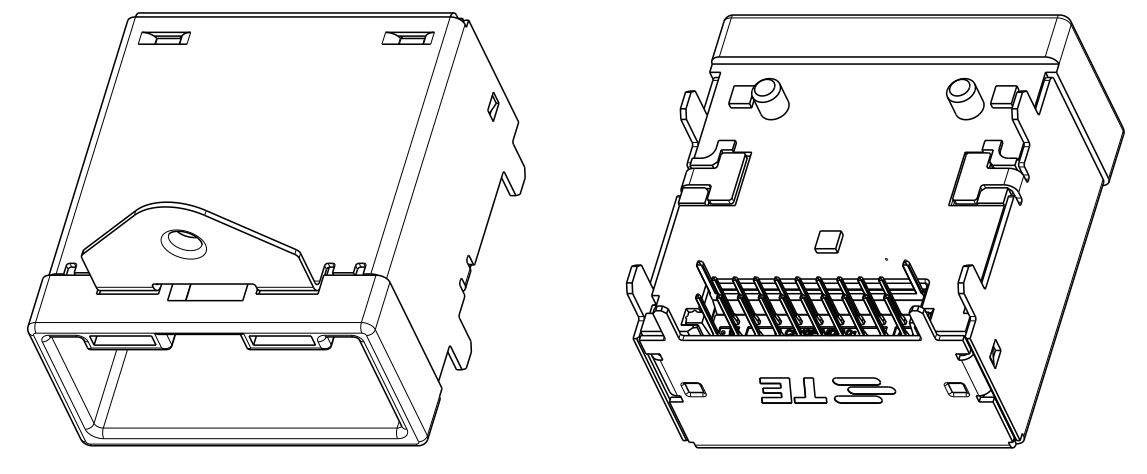
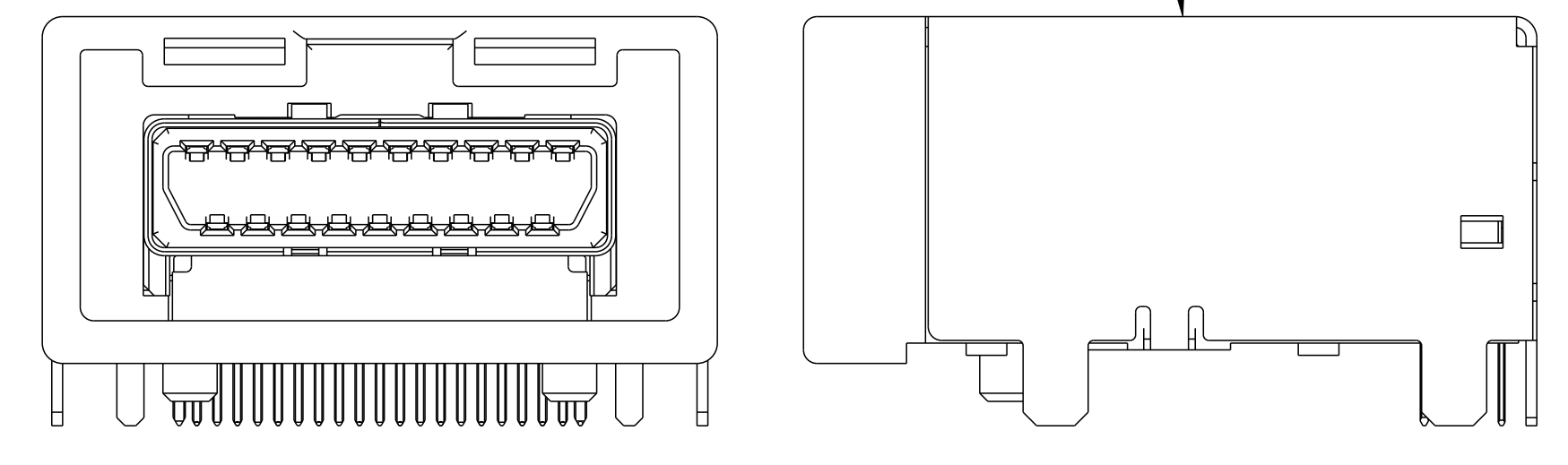

REVISIONS					
P.	LTN	DESCRIPTION	DATE	OWN	APVD
A	RELEASED	ECR-14-009079	04JUL2014	TK	MS
A1	REVISED	ECR-24-206863	22APR2024	TK	HK

④	PAPER BOX			OUTER	PACKAGING		
	EMBOSS REEL	SOFT TRAY	SOFT TRAY	INNER	STEEL ALLOY	OUTER SHELL W/O FLANGE	ITEM NO.
			—	POST-TIN	STEEL ALLOY	OUTER SHELL WITH FLANGE	7
	—	—		POST-TIN	STEEL ALLOY	OUTER SHELL WITH FLANGE	7
				BLACK	LCP	TINE PLATE	6
				BLACK	LCP	OUTER HOUSING	5
				POST-TIN	COPPER ALLOY	INNER SHELL	4
				BLACK	LCP	INNER HOUSING	3
	10	10	10	CONTACT AREA: GOLD PLATING SOLDERING AREA: POST-TIN	COPPER ALLOY	TAB CONTACT 2	2
	9	9	9	CONTACT AREA: GOLD PLATING SOLDERING AREA: POST-TIN	COPPER ALLOY	TAB CONTACT 1	1
④	2138755-3	2138755-2	2138755-1	FINISH/COLOR	MATERIAL	DESCRIPTION	ITEM NO.

- ①. PRELIMINARY PART - NOT RELEASED FOR PRODUCTION
- ②. THIS PRODUCT CONFORM HDMI SPECIFICATION.
- ③. THIS DIMENSION IN CASE OF MATING WITH TE PLUG
- ④. -3 IS THE SAME AS -2. (JUST DIFFERENT PACKAGING)

THIS DRAWING IS A CONTROLLED DOCUMENT. DWG: T. KUMAMOTO 04JUL2014
 CHK: T. YAMAMOTO 04JUL2014
 APVD: M. SHIMAOKA 04JUL2014

TE Connectivity

HDMI HEADER TYPE E FOR AUTOMOTIVE

108-78937 APPLICATION SPEC

SIZE: CAGE CODE: DRAWING NO: A100779C=2138755

RESTRICTED TO: -

WEIGHT: 10 g

CUSTOMER DRAWING

SCALE: 2:1 SHEET 1 OF 2 REV: A1

REVISIONS				
P.	LTN	DESCRIPTION	DATE	APVD
-	-	SEE SHEET 1	-	-

Ⓐ <EMBOSS REEL INFORMATION FOR -3>

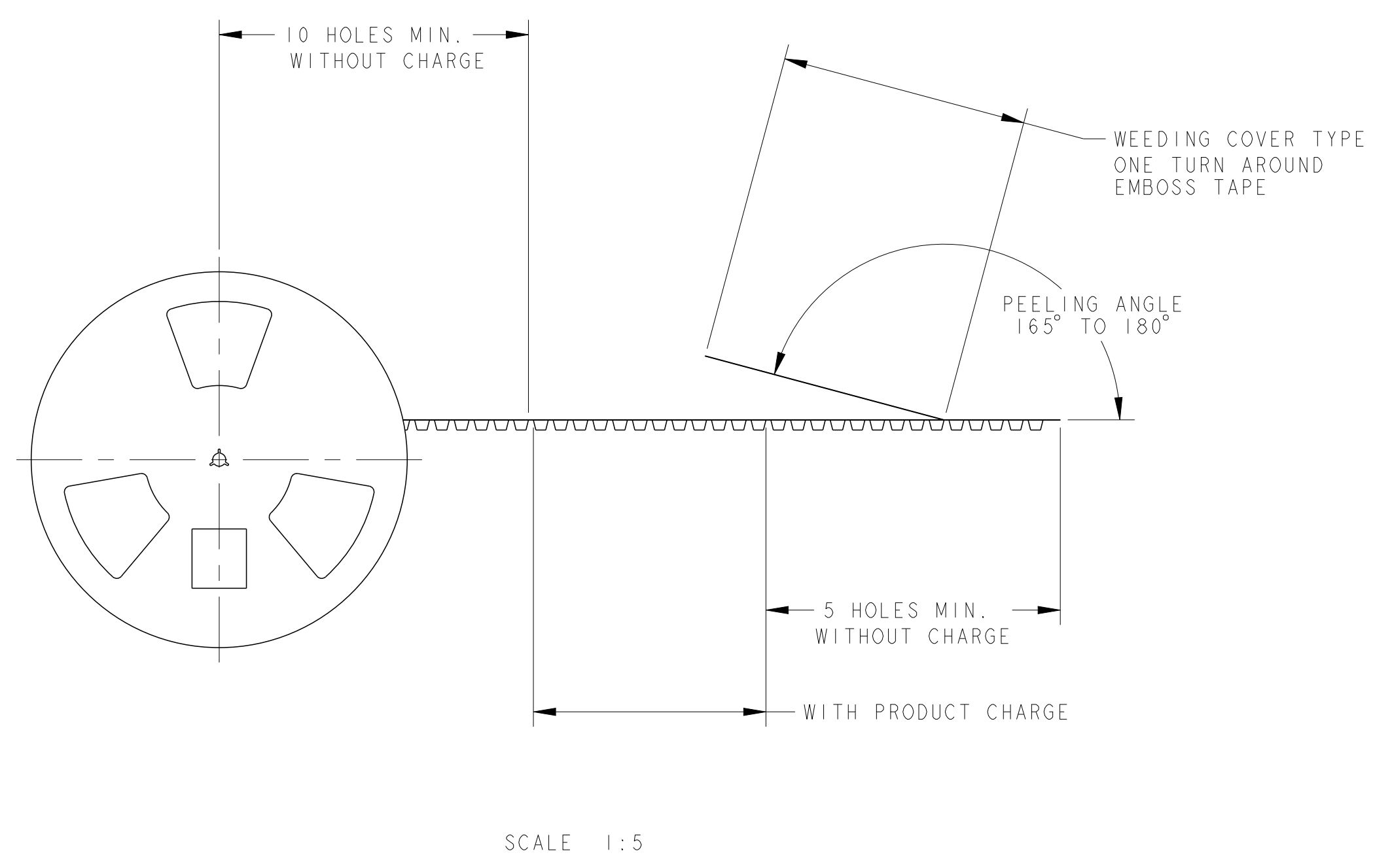
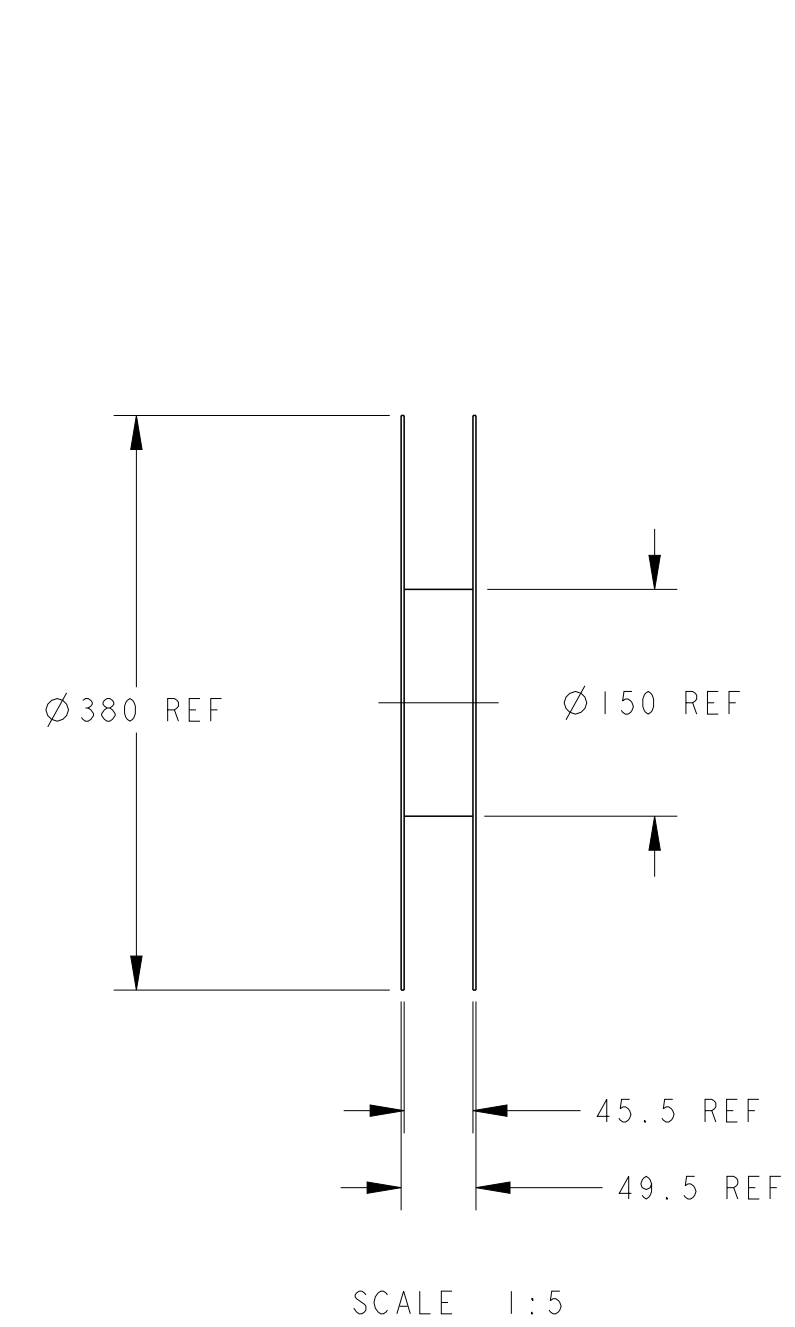
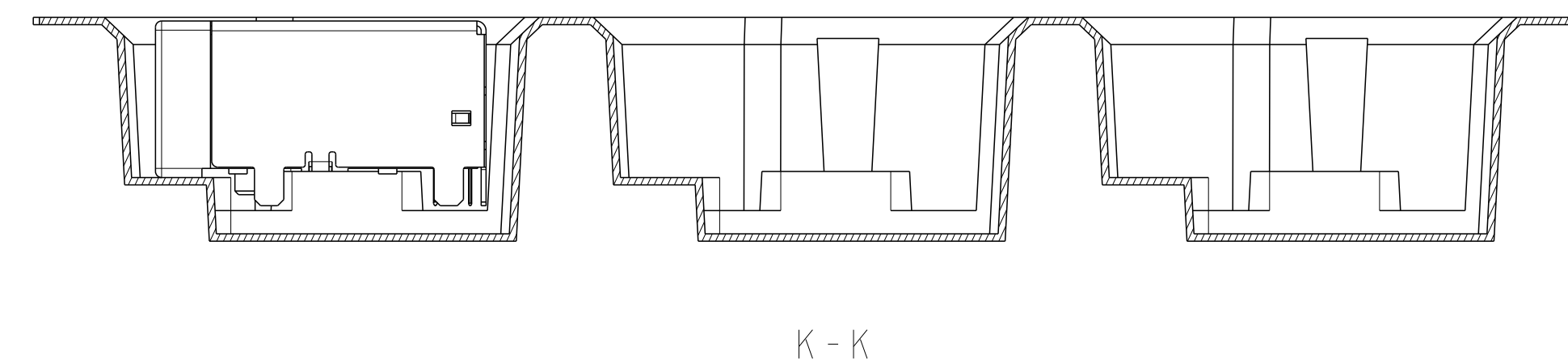
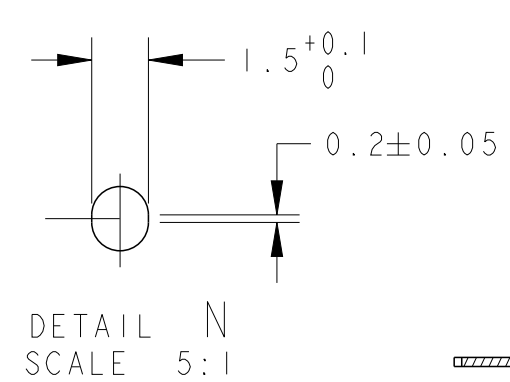
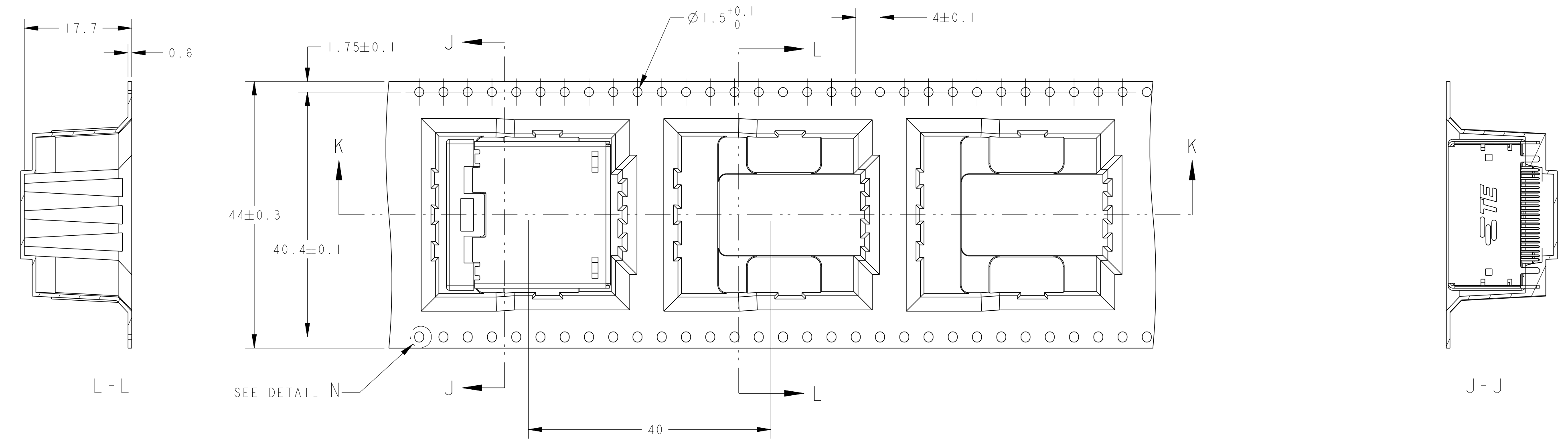

THIS DRAWING IS A CONTROLLED DOCUMENT.		OWN T. KUMAMOTO	04JUL2014	TE Connectivity
DIMENSIONS: mm		CHK T. YAMAMOTO	04JUL2014	
TOLERANCES UNLESS OTHERWISE SPECIFIED: 0-PLC ±0.3 1-PLC ±0.5 2-PLC ±0.75 3-PLC ±0.13 4-PLC ±0.001 ANGLES ±3° FINISH SEE TABLE		APVD M. SHIMAOKA	04JUL2014	NAME HDMI HEADER TYPE E FOR AUTOMOTIVE
MATERIAL SEE TABLE		PRODUCT SPEC 108-78937 APPLICATION SPEC		SIZE CAGE CODE DRAWING NO A100779C=2138755
CUSTOMER DRAWING		WEIGHT 10 g	SCALE 2:1	SHEET 2 OF 2 REV A1