

REVISIONS				
P	LTN	DESCRIPTION	DATE	OWN APVD
B		REVISED PER ECO-15-004915	09APR2015	AP DD
B1		REVISED PER ECN-24-252036	25MAR2024	AP RS

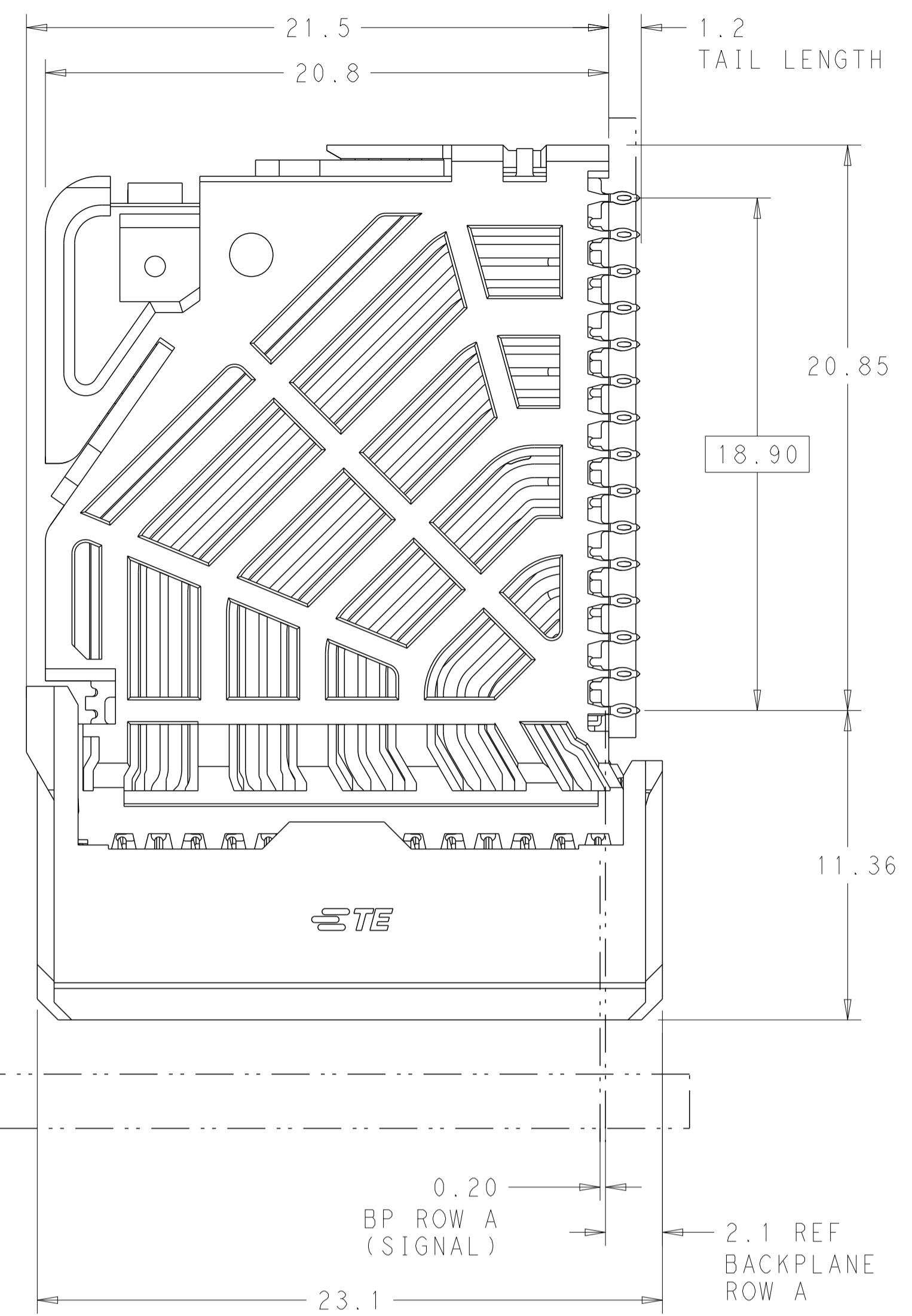

⚠ MATERIAL:
 HOUSING: LCP, GLASS FILLED, UL94V-0.
 TERMINALS: HIGH PERFORMANCE COPPER ALLOY.

⚠ FINISH:
 30µ" SELECTIVE GOLD IN CONTACT AREA. SELECTIVE TIN ON PCB TAILS, NICKEL OVERALL.

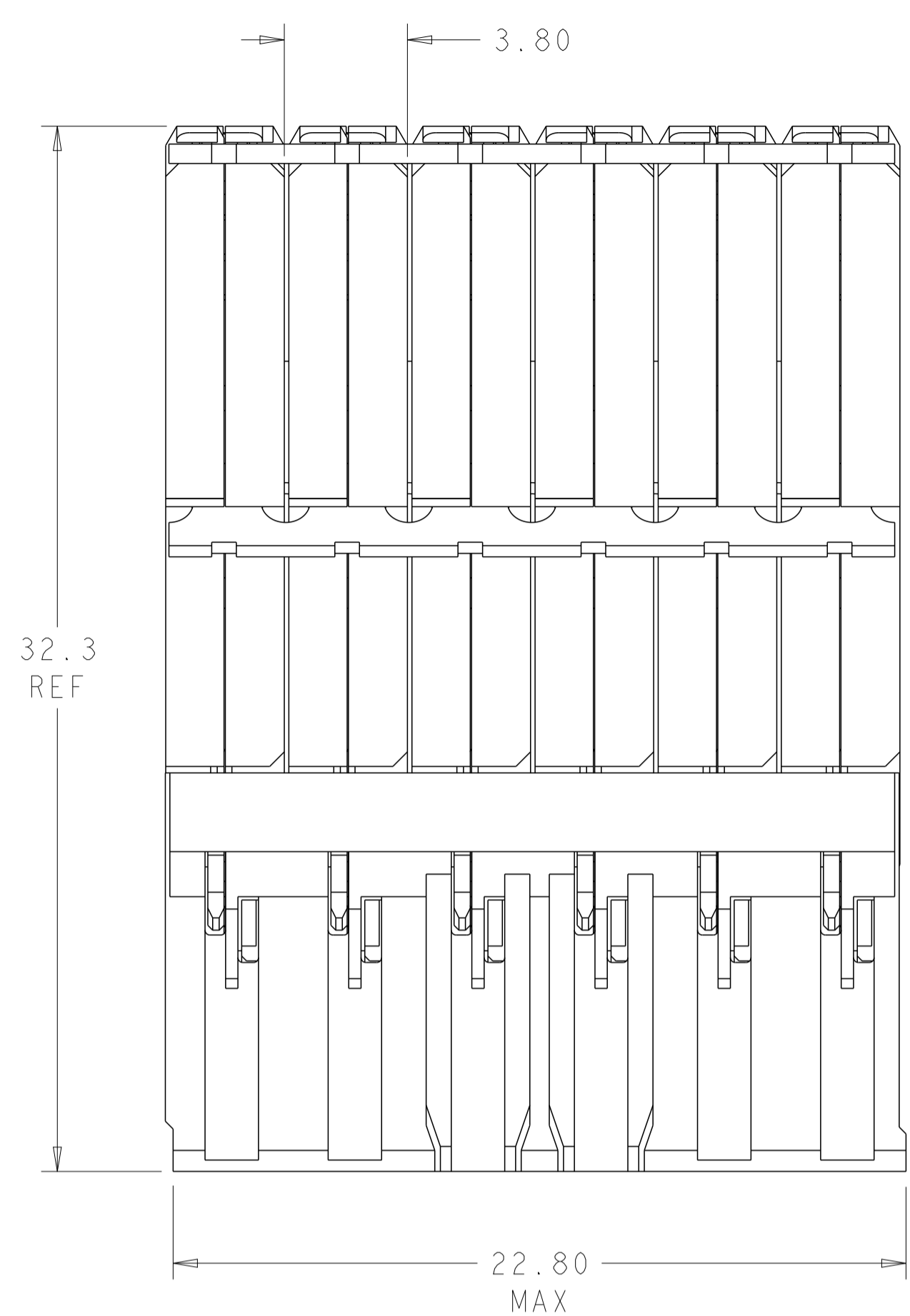
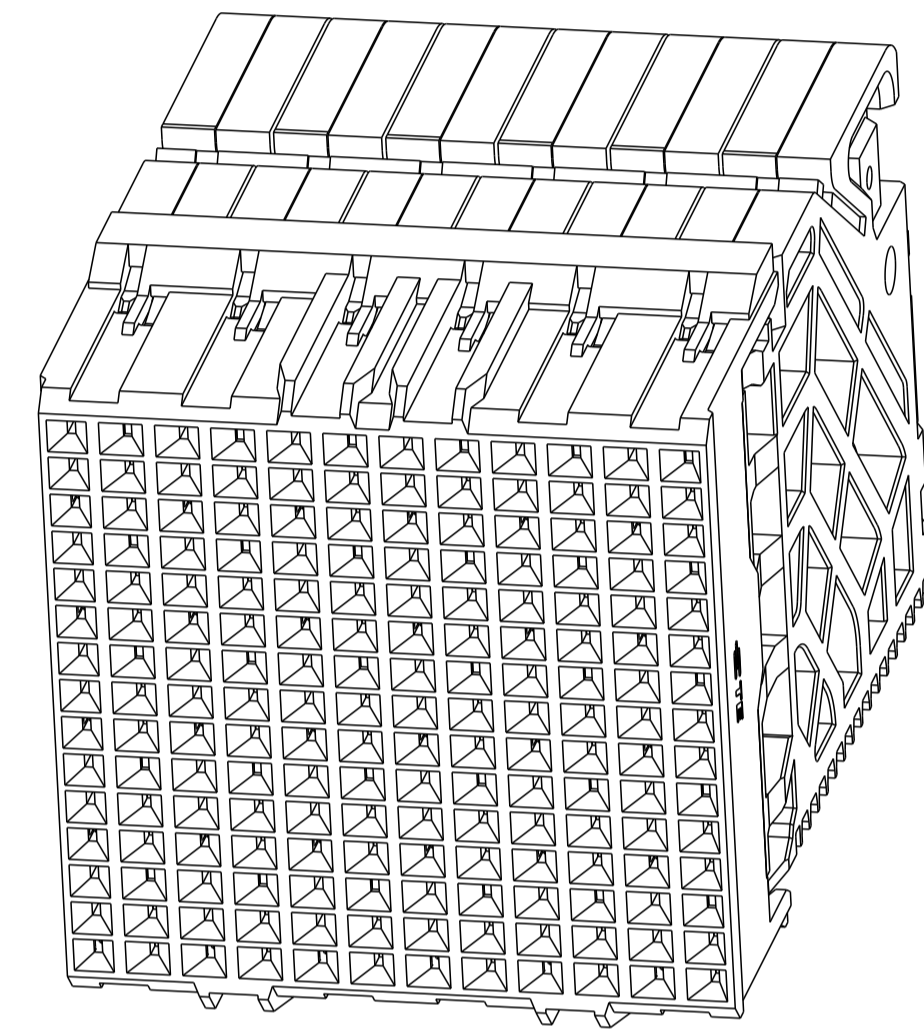

SCALE 4:1

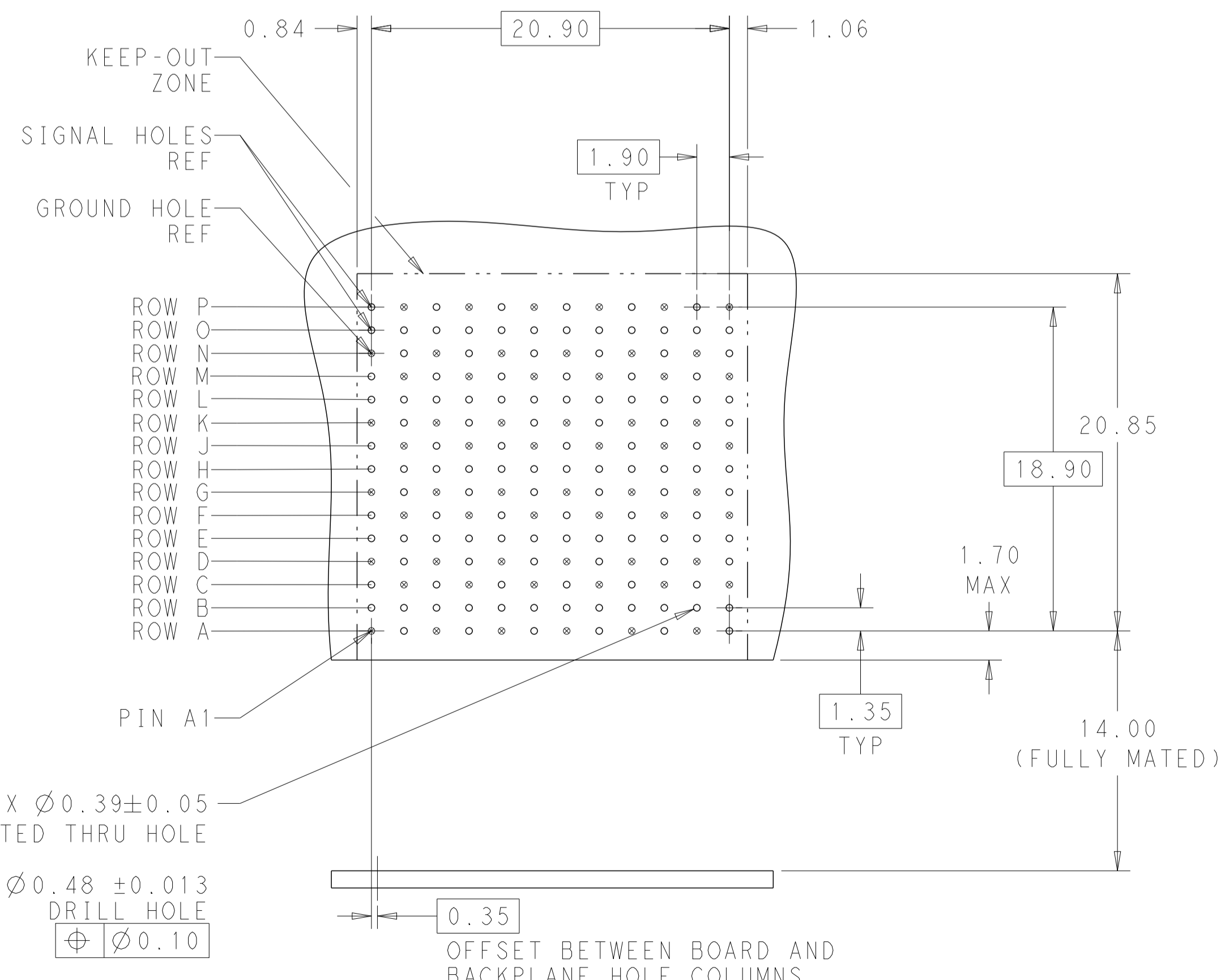
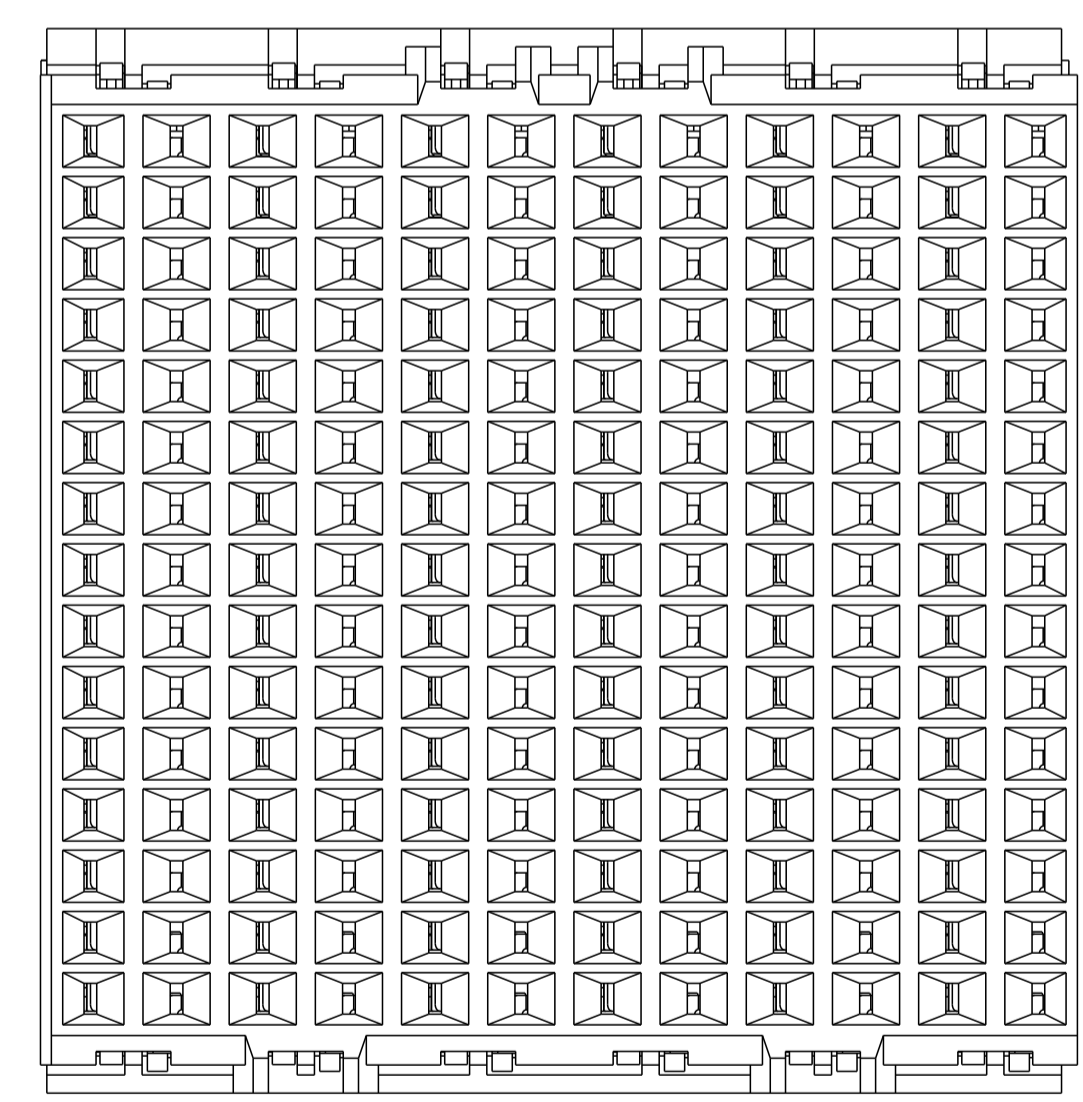

180X $\varnothing 0.39 \pm 0.05$ PLATED THRU HOLE
 180X $\varnothing 0.48 \pm 0.013$ DRILL HOLE
 $\varnothing 0.10$

RECOMMENDED PCB LAYOUT
 MIN BOARD THICKNESS 1.0

REFER TO WWW.TE.COM FOR PRODUCT AVAILABILITY

NONE	⚠	2110112-1
KEY POSITION	FINISH	PART NUMBER

THIS DRAWING IS A CONTROLLED DOCUMENT.		OWN: KIRAN HOLH 08NOV2012	NAME: IMPACT, 5 PAIR, DAUGHTERCARD	
DIMENSIONS: mm		CHK: D. DIXON 08NOV2012	TE Connectivity	
TOLERANCES UNLESS OTHERWISE SPECIFIED:		APVD: D. DIXON 08NOV2012	PRODUCT SPEC: 12 COLUMN, UNGUIDED, SIGNAL MODULE, 0.39 EYELET	
0 PLC ±		APPLICATION SPEC: -	SIZE: A1	
1 PLC ±0.2		WEIGHT: -	CAGE CODE: 100779	
2 PLC ±0.13		RESTRICTED TO: -	DRAWING NO: 2110112	
3 PLC ±		CUSTOMER DRAWING	SCALE: 6:1	
4 PLC ±			SHEET 1 OF 1	
ANGLES ±			REV: B1	
FINISH: SEE TABLE				