

LOC	DIST	REV	DATE	BY	CHK	APPV
D		REV PER ECO 12-014265	8-7-12	CT	DH	
F		ECO-13-004755	26MAR2013	KG	DH	
G		ECO-14-017030	25NOV2014	MGM	CT	

- 1 MATERIAL:
CONTACT - COPPER ALLOY
HOUSING - LCP, COLOR - BLACK
- 2 FINISH:
MATING AREA: 1.27µm MIN GOLD OVER
1.25µm MIN NICKEL
- 3 DATUMS AND BASIC DIMENSIONS ESTABLISHED BY CUSTOMER.
- 4 REFERENCE APPLICATION SPEC 114-13267 FOR RECOMMENDED
PLATING THRU HOLE DIAMETER AND PLATING THICKNESSES.
- 5 FINISH:
COMPLIANT PIN AREA: 0.38µm MIN BRIGHT TIN LEAD OVER
1.27µm MIN NICKEL
- 6 FINISH:
COMPLIANT PIN AREA: 0.38µm MIN MATTE TIN OVER
1.27µm MIN NICKEL

4
 $\oplus \varnothing 0.05 \text{ X Y}$
 FINISHED HOLE SIZE
 AND PLATED THRU HOLES

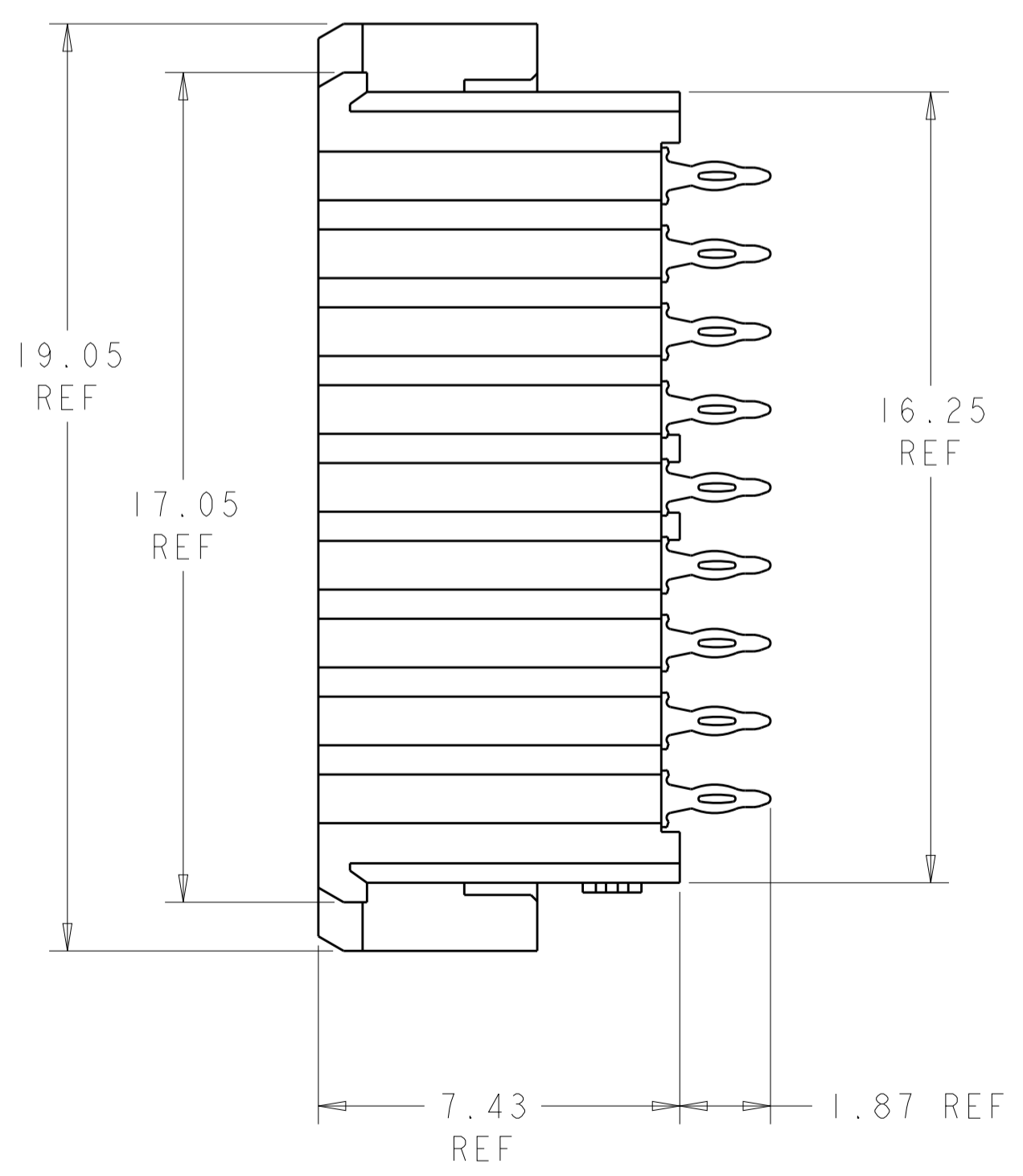
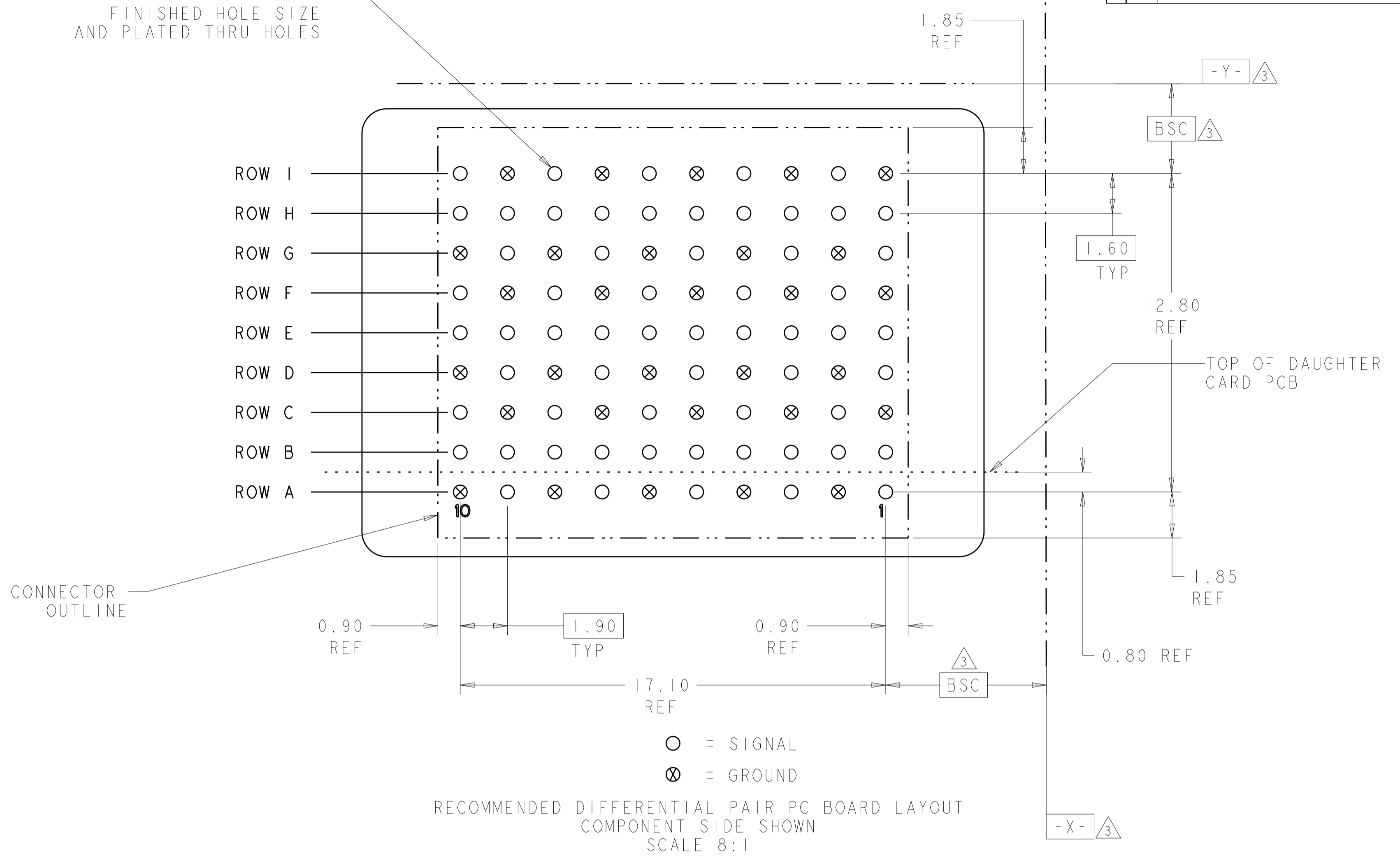
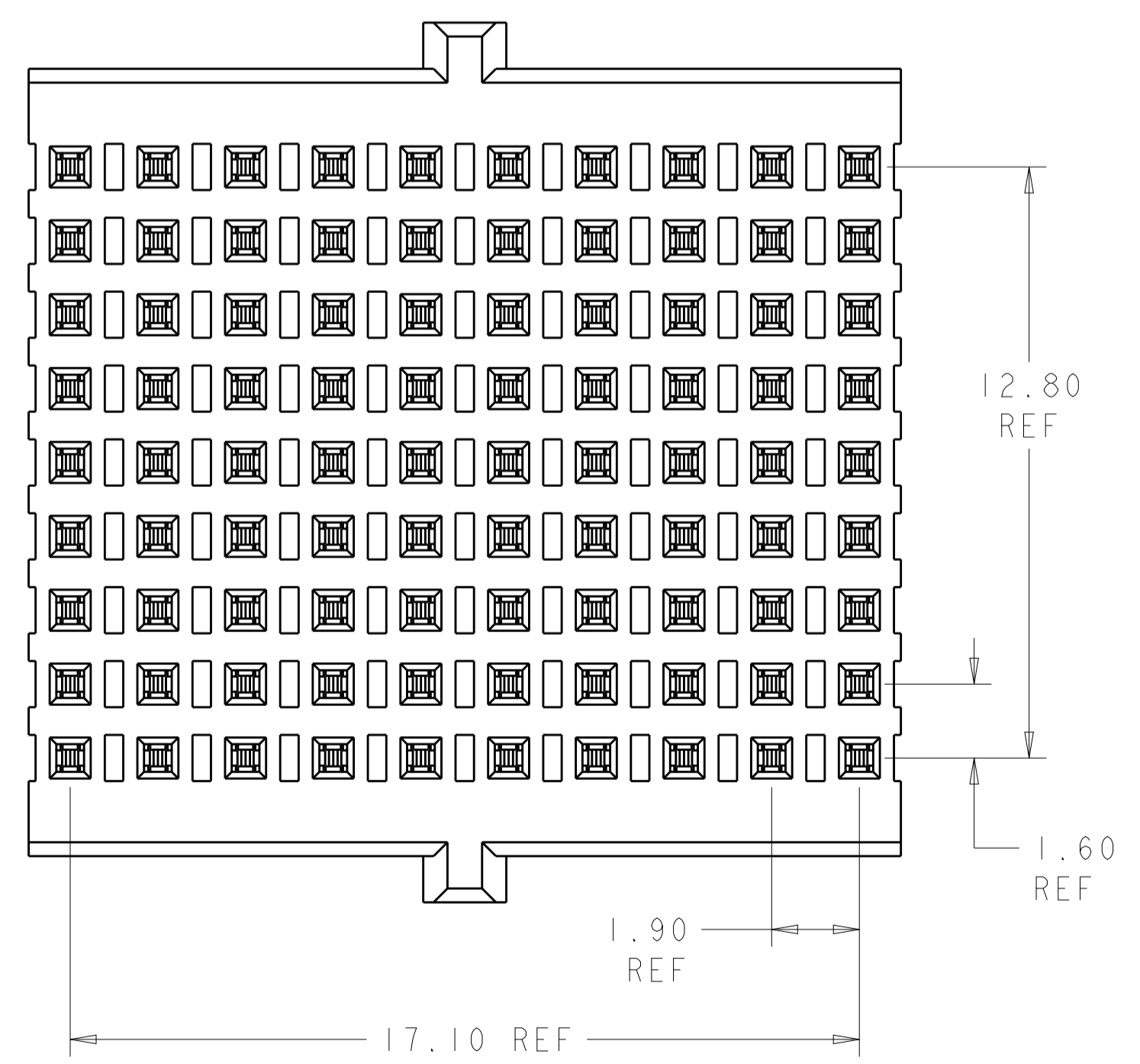
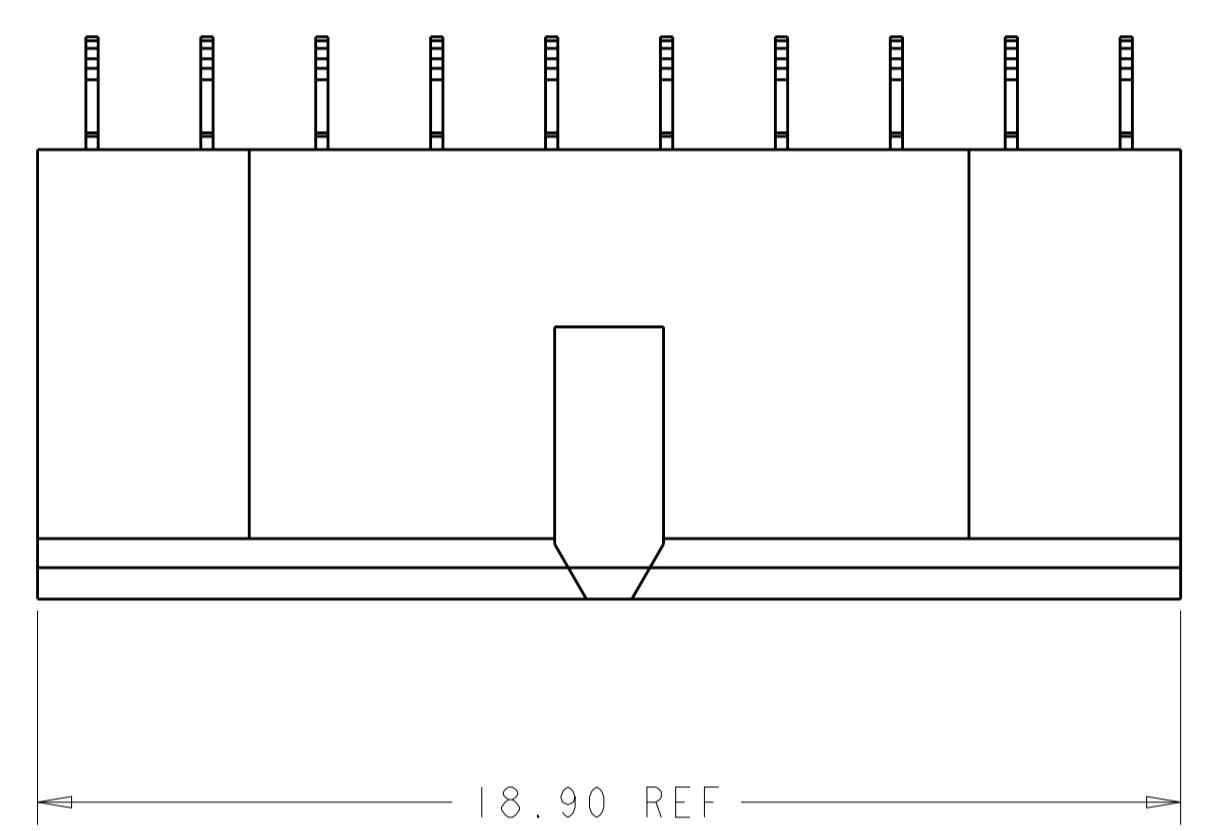

2/6	2000896-2
2/5	2000896-1
FINISH	PART NUMBER

THIS DRAWING IS A CONTROLLED DOCUMENT. DIMENSIONING AND TOLERANCING PER GPS (ISO STANDARDS).		DWN: D. BELACK 24JUN2009	TE Connectivity
TOLERANCES UNLESS OTHERWISE SPECIFIED:		CHK: A. TSANG 2-24-2009	
DIMENSIONS:	mm	APV: M. McALONIS 2-24-2009	NAME: Fortis Zd. 10-COLUMN, 3-PAIR, VERTICAL CENTER MODULE ASSEMBLY SIZE: CAGE CODE DRAWING NO: RESTRICTED TO WEIGHT: 3.38 g -2x CUSTOMER DRAWING
	0 PLC ±	PRODUCT SPEC	
	1 PLC ±0.13	108-2409	
	2 PLC ±0.05	APPLICATION SPEC	
	3 PLC ±	114-13267	SCALE: 8:1 SHEET 1 OF 1 REV G
	4 PLC ±		
	ANGLES ±		
MATERIAL	FINISH		