

THIS DRAWING IS UNPUBLISHED. RELEASED FOR PUBLICATION  
 © COPYRIGHT - By - ALL RIGHTS RESERVED.

LOC	DIST	REVISIONS			
P	LTR	DESCRIPTION	DATE	DWN	APVD
G	14	A	REVISED PER ECO-13-009685	11JUN13	KH DR

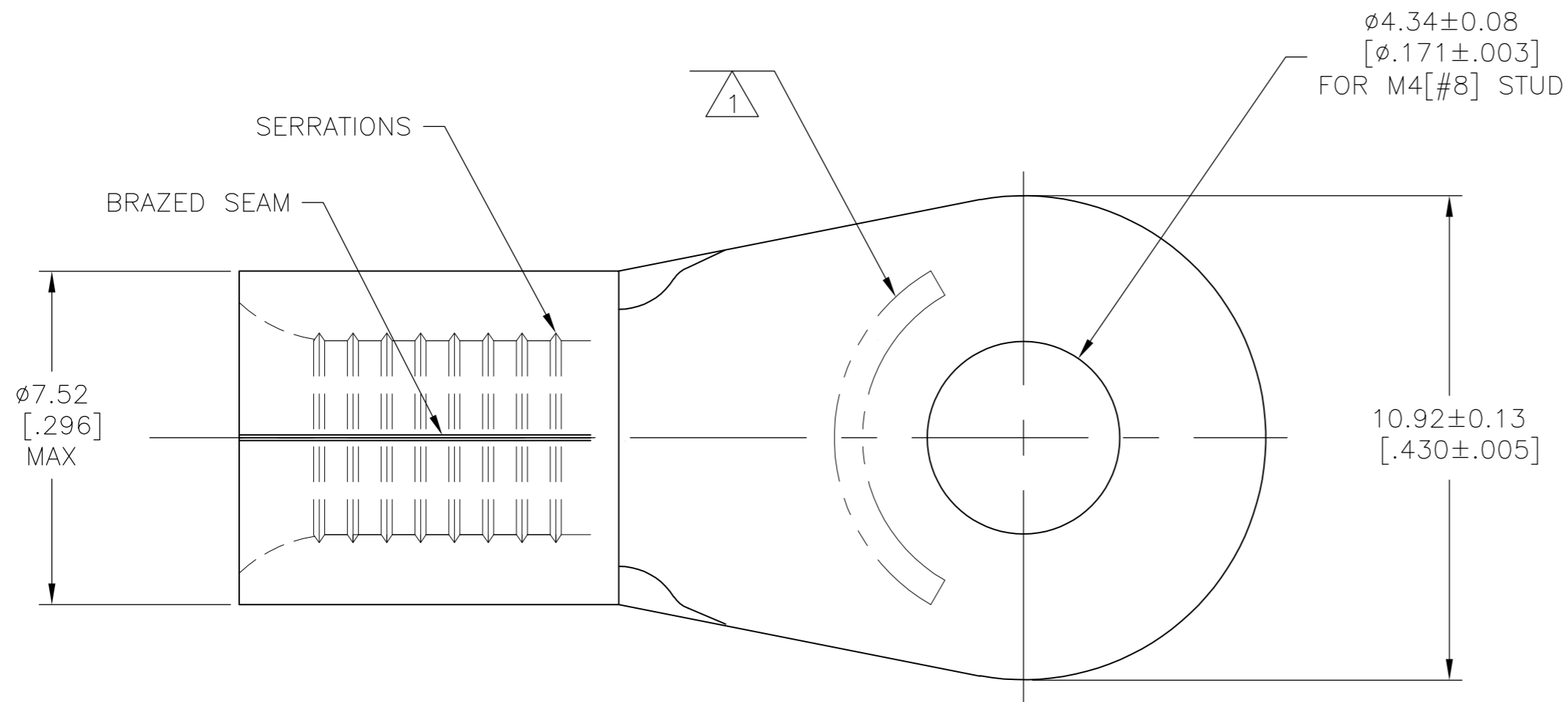

1 STAMP AMP 8\* APPROX AS SHOWN  
 2 GOLD PLATE 0.00127[.000050] MIN EXT THK PER ASTM B488, TYPE I, CODE C, OVER NICKEL PLATE 0.00127[.000050] MIN EXT THK PER SAE AMS QQ-N-290 OVER COPPER FLASH PER SAE AMS 2418

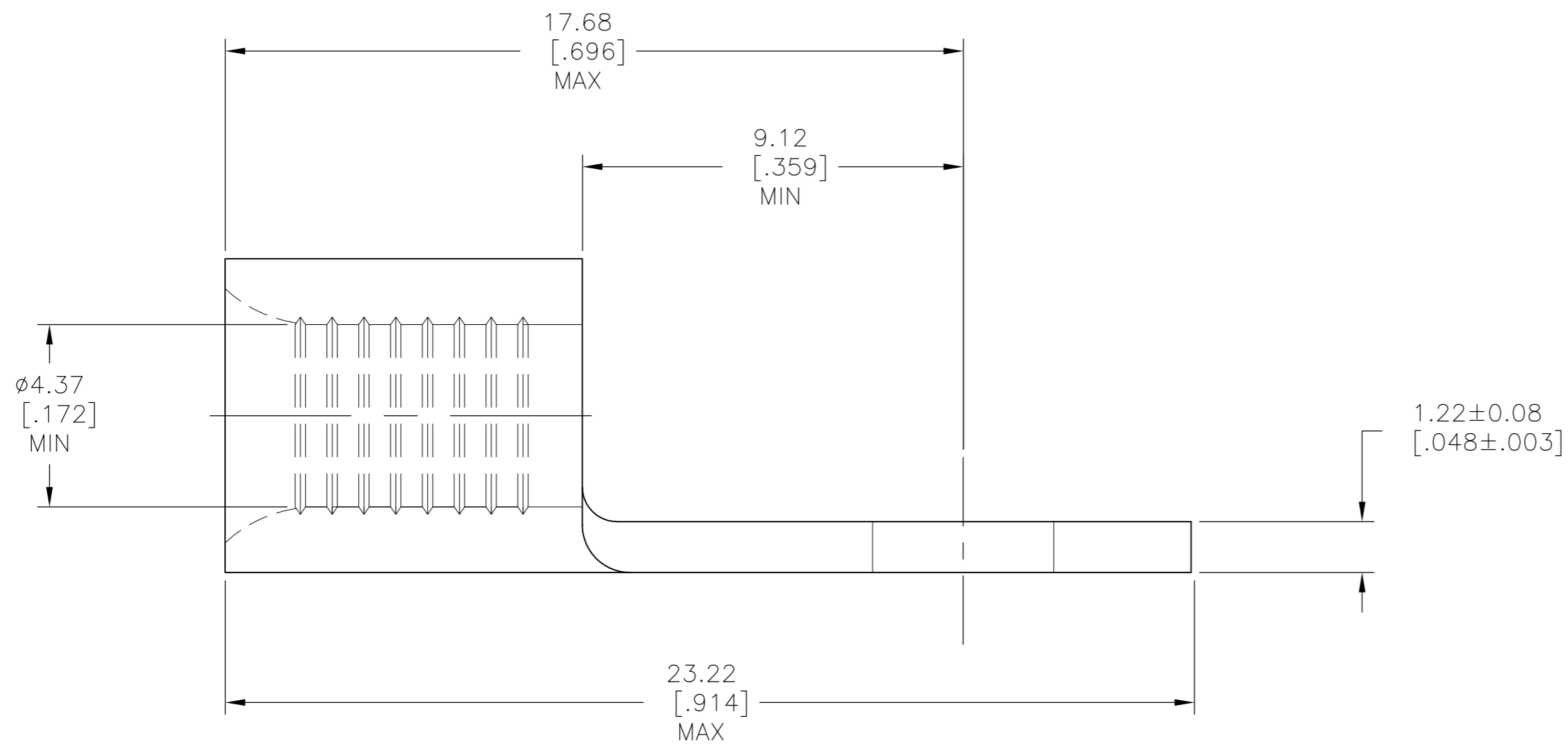

<b>AMP INCORPORATED</b> <b>CUSTOMER SERVICE SYSTEMS</b>		MAX RECOMMENDED OPERATING TEMPERATURE: 260°C [500°F]
FOR ADDITIONAL PRODUCT INFORMATION OR COPIES OF DRAWINGS AND TECHNICAL DOCUMENTS	PRODUCT INFORMATION CENTER 1-800-522-6752	VOLTAGE RATING: NOT APPLICABLE
FOR APPLICATION TOOLING INFORMATION	TOOLING ASSISTANCE CENTER 1-800-722-1111	WIRE CROSS SECTIONAL AREA RANGE: 6.64-10.5MM <sup>2</sup> [13,100-20,800] CIR MILS SOLID OR STRANDED
FOR ORDER ENTRY	1-800-526-5142	

THIS DRAWING IS A CONTROLLED DOCUMENT.		DWN 07DEC12 KIRAN HOLAL	100	LOOSE PIECE	1958437-1
DIMENSIONS: mm [INCHES]		CHK 07DEC12 ROHDE DANIEL	QTY	PACKAGE TYPE	PART NUMBER
TOLERANCES UNLESS OTHERWISE SPECIFIED:		APVD 07DEC12 ROHDE DANIEL	TE Connectivity NAME TERMINAL, RING TONGUE, STRATO-THERM		
0 PLC ± - 1 PLC ± - 2 PLC ± - 3 PLC ± - 4 PLC ± - ANGLES ± -		PRODUCT SPEC			
MATERIAL COPPER PER ASTM B-152 ANNEALED		FINISH 2	SIZE A2	CAGE CODE 00779	DRAWING NO C=1958437
CUSTOMER DRAWING		WEIGHT	SCALE 8:1	SHEET 1 of 1	REV A