

NUMBER C-172129

METRIC

PRINT DIST
ALL DIMENSIONS IN MM. DO NOT SCALE PRINT

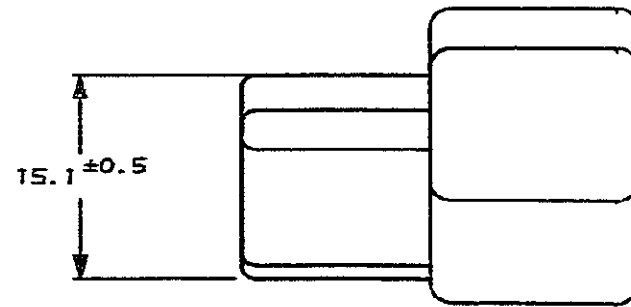
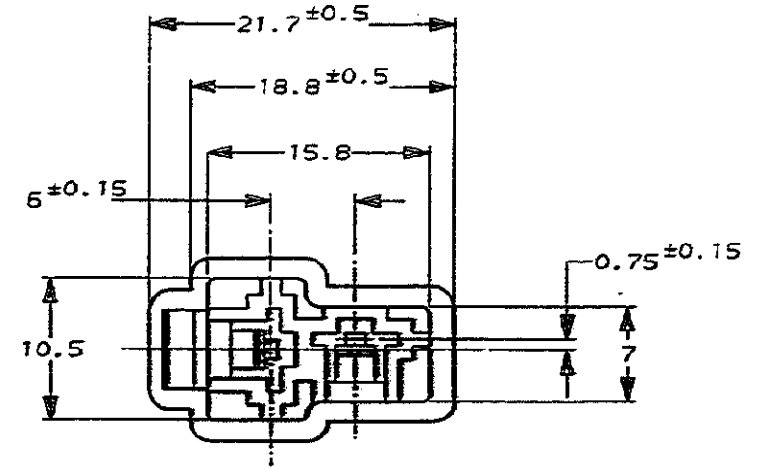
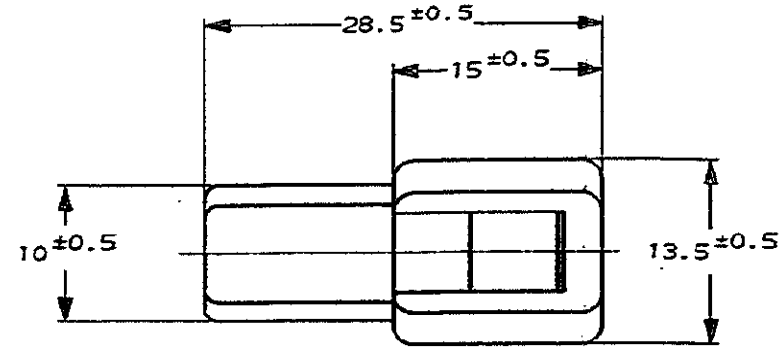
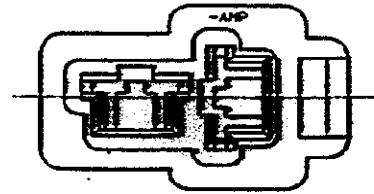

注.

1. 嵌合する相手ハウジングは型番172130
2. 使用端子は型番170340, 170341, 170349

NOTE.

1. THE MATING PLUG HOUSING, P/N 172130
2. APPLIED CONTACT, P/N 170340, 170341, 170349

△ OBSOLETE PARTS: OBSOLETE CIS STREAMLINING PER D.RENAUD/D.SINISI

色 (COLOR)	番号 (NUMBER)
淡灰 (LIGHT GRAY)	6-172129-5
自然色 (NATURAL) 94V-0	1-▲-1
赤 (RED)	-9
△ OBSOLETE 橙 (ORANGE)	-8
OBSOLETE 黄 (YELLOW)	7
青 (BLUE)	-5
△ OBSOLETE 緑 (GREEN)	-4
OBSOLETE 茶 (BROWN)	-3
黒 (BLACK)	▼-2
自然色 (NATURAL)	172129-1

STE TE Connectivity

REV. (REVISION)	DATE	CHK	DR	材料 (MATERIAL)	仕上 (FINISH)	名称 (NAME)
C6	REVISED PER ECR-21-116405	SS	EW	11OCT2023	絶縁被覆範囲 (WIRE RANGES)	絶縁被覆 (INSULATION DIA.)
C5	REVISED PER ECR-19-018127	AA	EW	10AUG20	mm ² (AWG)	mm
C4	REVISED PER ECR-17-012979	BDA	TD	11SEP2017	材料 (MATERIAL)	仕上 (FINISH)
C3	REVISED PER ECR-16-015261	RS	TD	28OCT16	6/6 ナイロン (6/6 NYLON)	色: 表参照 (COLOR: SEE TABLE)
C2	REVISED PER ECO-11-005030	RK	HMR	22MAR11	DR. K. Yamada 9/10/23	DE. K. Yamada 9/10/23
LTR	変更 (REVISION RECORD)	DR	CHK	DATE	CHK. D. Tamura 9/10/23	APR. D. Tamura 9/10/23

一般公差 (GENERAL TOLERANCES)	LOG	番号 (No.)
100μm: ±0.2	B	J
100μm < 300μm: ±0.25		
300μm < 100mm: ±0.3		
100mm < 100mm: ±0.3		
角度: ±3°		
尺度 (SCALED)	REV.	SHEET
2-1	C6	1 OF 1