

THIS DRAWING IS UNPUBLISHED. RELEASED FOR PUBLICATION 20
 © COPYRIGHT 20 BY - ALL RIGHTS RESERVED.

REVISIONS					
P	LTR	DESCRIPTION	DATE	DWN	APVD
B		ECR-13-017246	08NOV2013	KG	DW
C		ECR-17-001574	12APR2017	KG	DW
C1		ECR-17-006210	18MAY2018	PHM	DW

1. THIS PRODUCT HAS NOT COMPLETED VALIDATION TESTING.
2. PROTECTIVE LABELS APPLIED AFTER FINAL CLEAN ROOM TEST TO PREVENT OPTICAL CAVITY CONTAMINATION. REMOVE ONLY WHEN READY TO ASSEMBLE.
3. SINGLEMODE IDENTIFIER
4. USE WITH FERRULE ASSEMBLY KIT, 1985635-1 (125um) OR 1985635-3 (125.5 um). QUANTITY OF 8 REQUIRED.
5. FOR USE AT BOTH 1310 AND 1550nm WAVELENGTHS.

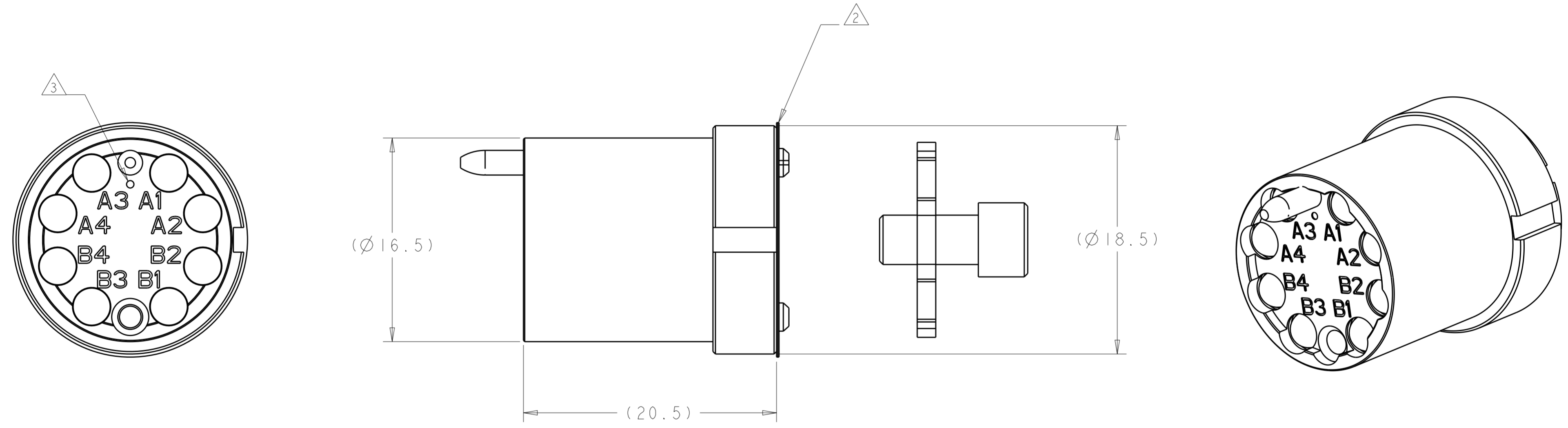

SUPERSEDED BY: 1516258-2
 1516258-1
 PART NUMBER

THIS DRAWING IS A CONTROLLED DOCUMENT.		DWN K. GLATFELTER 13AUG2009	STE TE Connectivity	
DIMENSIONS: mm		CHK D. WERTMAN 13AUG2009		
TOLERANCES UNLESS OTHERWISE SPECIFIED:		APVD D. WERTMAN 13AUG2009	NAME INSERT ASSEMBLY, PRO BEAM SR. 8x1310/1550nm, SM	
0 PLC ±	1 PLC ±	PRODUCT SPEC	SIZE A2	CAGE CODE -
2 PLC ±	3 PLC ±	APPLICATION SPEC	DRAWING NO G-1516258	RESTRICTED TO -
4 PLC ±	ANGLES ±	WEIGHT -	SCALE 4:1	SHEET OF
FINISH	N/A	CUSTOMER DRAWING	REV C1	