

REVISIONS				
REV	DATE	BY	CHK	APPV
J	02DEC2021	SCB	KJK	

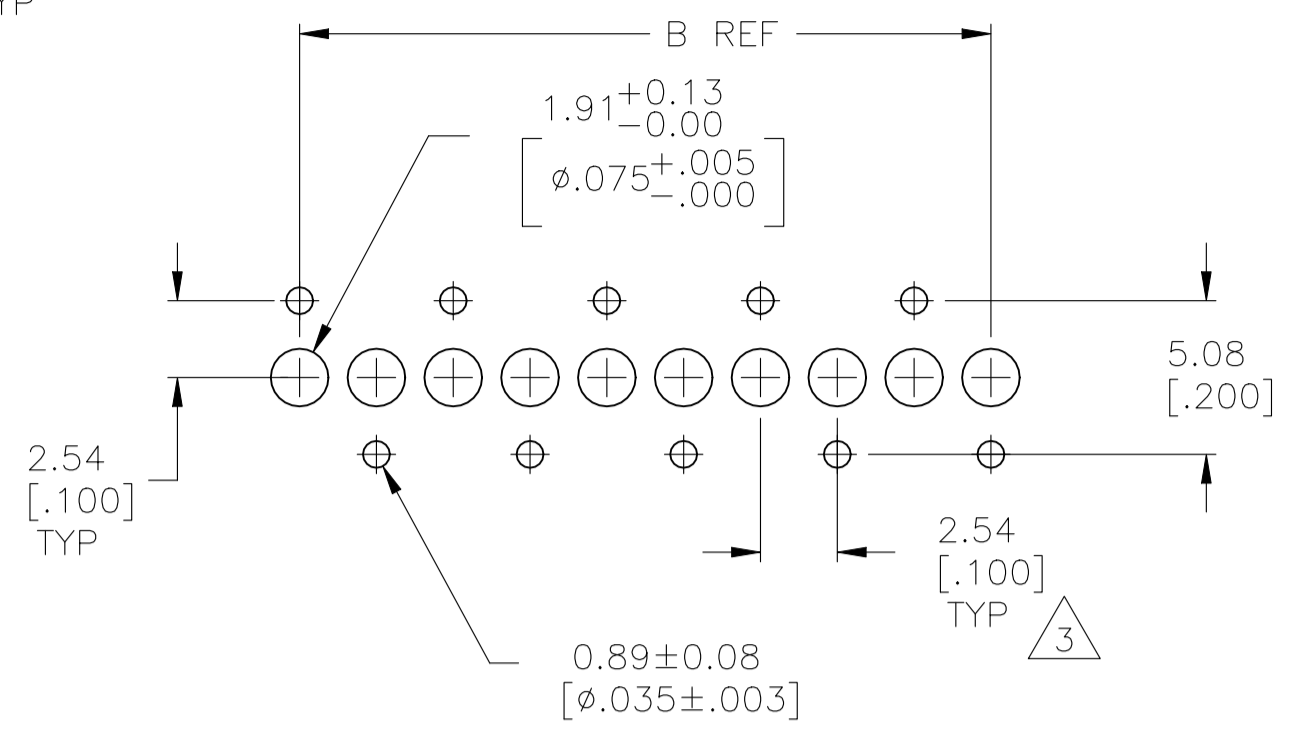

RECOMMENDED HOLE LAYOUT

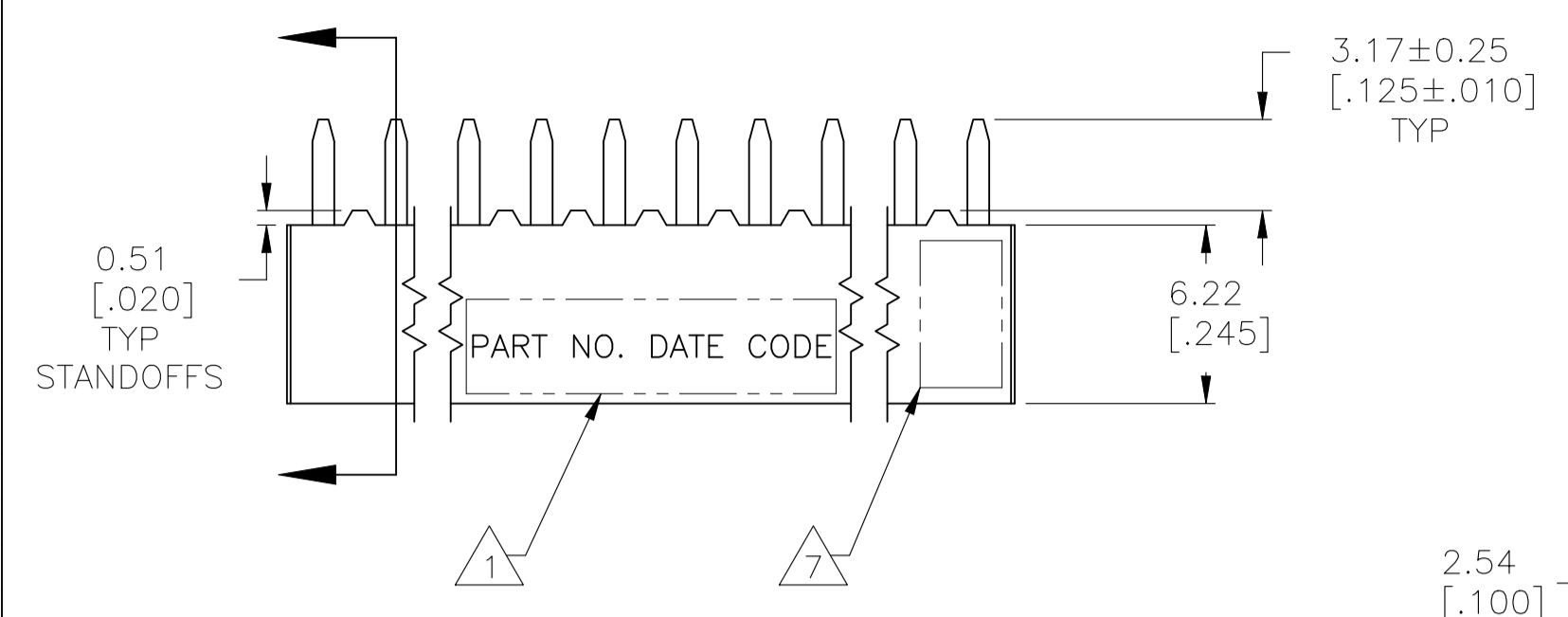
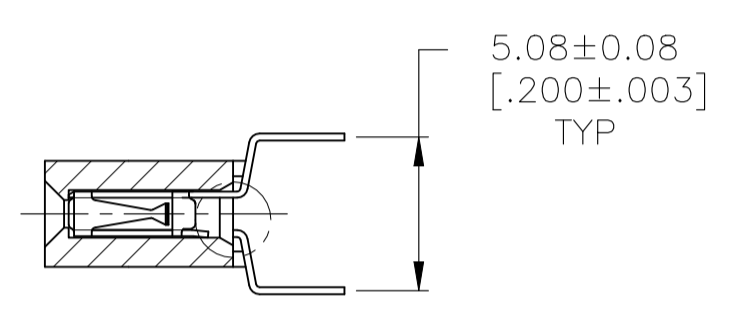
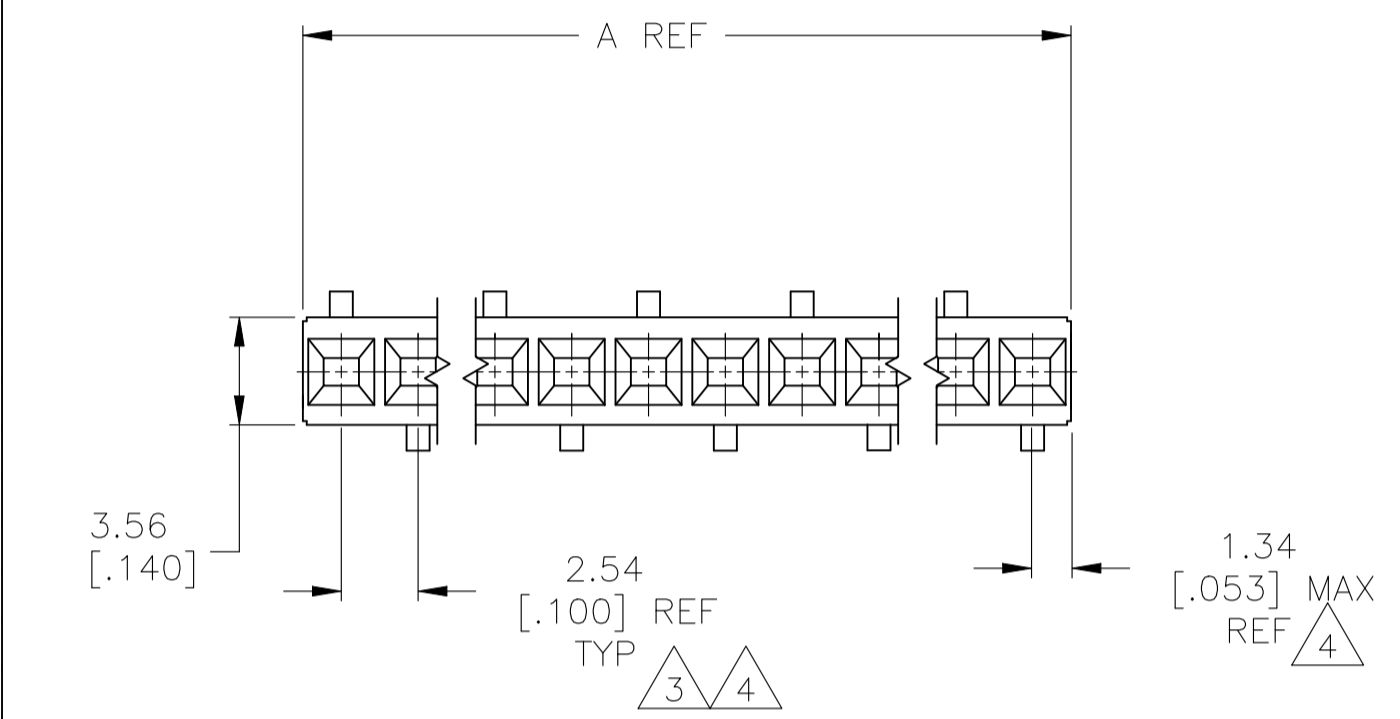

- 1 MARK PART NUMBER AND DATE CODE IN APPROXIMATE LOCATION SHOWN, EITHER SIDE.
- 2 CONTACT FINISH: 2.54–5.08µm [.000100–.000200] BRIGHT TIN-LEAD, OVER 1.27µm [.000050] MIN NICKEL.
- 3 TOLERANCE NON CUMULATIVE.
- 4 THESE DIMENSIONS PERTAIN TO CAVITY CENTERLINES ONLY, NOT TO CONTACT LOCATION
- 5 HOUSING: FLAME RETARDANT, GLASS FILLED POLYESTER, BLACK. CONTACT: PHOSPHOR BRONZE.
- 6 FOR 2 POS, DATE CODE IS STAMPED OPPOSITE SIDE OF TE LOGO.
- 7 TE LOGO AND CSA LOGO ARE MOLDED INTO HOUSING.
- 8 NO PART NUMBER MARKING REQUIRED FOR THIS PART.
- 9 CONTACT FINISH: 3.81–7.58µm [.000150–.000300] MATTE TIN, OVER 1.27µm [.000050] MIN NICKEL.
- 10 ROHS 2002/95/EC COMPLIANT
- 11 SUPERSEDED BY 5-147727-4
- 12 SUPERSEDED BY 5-147727-8

99.06	[3.900]	101.60	[4.000]	40	10	8-147727-9
96.52	[3.800]	99.06	[3.900]	39	10	8-147727-8
93.98	[3.700]	96.52	[3.800]	38	10	8-147727-7
91.44	[3.600]	93.98	[3.700]	37	10	8-147727-6
88.90	[3.500]	91.44	[3.600]	36	10	8-147727-5
86.34	[3.400]	88.90	[3.500]	35	10	8-147727-4
83.82	[3.300]	86.34	[3.400]	34	10	8-147727-3
81.28	[3.200]	83.82	[3.300]	33	10	8-147727-2
78.74	[3.100]	81.28	[3.200]	32	10	8-147727-1
76.20	[3.000]	78.74	[3.100]	31	10	8-147727-0
73.66	[2.900]	76.20	[3.000]	30	10	7-147727-9
71.12	[2.800]	73.66	[2.900]	29	10	7-147727-8
68.58	[2.700]	71.12	[2.800]	28	10	7-147727-7
66.04	[2.600]	68.58	[2.700]	27	10	7-147727-6
63.50	[2.500]	66.04	[2.600]	26	10	7-147727-5
60.96	[2.400]	63.50	[2.500]	25	10	7-147727-4
58.42	[2.300]	60.96	[2.400]	24	10	7-147727-3
55.88	[2.200]	58.42	[2.300]	23	10	7-147727-2
53.34	[2.100]	55.88	[2.200]	22	10	7-147727-1
50.80	[2.000]	53.34	[2.100]	21	10	7-147727-0
48.26	[1.900]	50.80	[2.000]	20	10	6-147727-9
45.72	[1.800]	48.26	[1.900]	19	10	6-147727-8
43.18	[1.700]	45.72	[1.800]	18	10	6-147727-7
40.64	[1.600]	43.18	[1.700]	17	10	6-147727-6
38.10	[1.500]	40.64	[1.600]	16	10	6-147727-5
35.56	[1.400]	38.10	[1.500]	15	10	6-147727-4
33.02	[1.300]	35.56	[1.400]	14	10	6-147727-3
30.48	[1.200]	33.02	[1.300]	13	10	6-147727-2
27.94	[1.100]	30.48	[1.200]	12	10	6-147727-1
25.40	[1.000]	27.94	[1.100]	11	10	6-147727-0
22.86	[.900]	25.40	[1.000]	10	10	5-147727-9
20.32	[.800]	22.86	[.900]	9	10	5-147727-8
17.78	[.700]	20.32	[.800]	8	10	5-147727-7
15.24	[.600]	17.78	[.700]	7	10	5-147727-6
12.70	[.500]	15.24	[.600]	6	10	5-147727-5
10.16	[.400]	12.70	[.500]	5	10	5-147727-4
7.62	[.300]	10.16	[.400]	4	10	5-147727-3
5.08	[.200]	7.62	[.300]	3	10	5-147727-2
2.54	[.100]	5.08	[.200]	2	10	5-147727-1

6 8 OBSOLETE

6 8 OBSOLETE

99.06	[3.900]	101.60	[4.000]	40	3-147727-9
96.52	[3.800]	99.06	[3.900]	39	3-147727-8
93.98	[3.700]	96.52	[3.800]	38	3-147727-7
91.44	[3.600]	93.98	[3.700]	37	3-147727-6
88.90	[3.500]	91.44	[3.600]	36	3-147727-5
86.34	[3.400]	88.90	[3.500]	35	3-147727-4
83.82	[3.300]	86.34	[3.400]	34	3-147727-3
81.28	[3.200]	83.82	[3.300]	33	3-147727-2
78.74	[3.100]	81.28	[3.200]	32	3-147727-1
76.20	[3.000]	78.74	[3.100]	31	3-147727-0
73.66	[2.900]	76.20	[3.000]	30	2-147727-9
71.12	[2.800]	73.66	[2.900]	29	2-147727-8
68.58	[2.700]	71.12	[2.800]	28	2-147727-7
66.04	[2.600]	68.58	[2.700]	27	2-147727-6
63.50	[2.500]	66.04	[2.600]	26	2-147727-5
60.96	[2.400]	63.50	[2.500]	25	2-147727-4
58.42	[2.300]	60.96	[2.400]	24	2-147727-3
55.88	[2.200]	58.42	[2.300]	23	2-147727-2
53.34	[2.100]	55.88	[2.200]	22	2-147727-1
50.80	[2.000]	53.34	[2.100]	21	2-147727-0
48.26	[1.900]	50.80	[2.000]	20	1-147727-9
45.72	[1.800]	48.26	[1.900]	19	1-147727-8
43.18	[1.700]	45.72	[1.800]	18	1-147727-7
40.64	[1.600]	43.18	[1.700]	17	1-147727-6
38.10	[1.500]	40.64	[1.600]	16	1-147727-5
35.56	[1.400]	38.10	[1.500]	15	1-147727-4
33.02	[1.300]	35.56	[1.400]	14	1-147727-3
30.48	[1.200]	33.02	[1.300]	13	1-147727-2
27.94	[1.100]	30.48	[1.200]	12	1-147727-1
25.40	[1.000]	27.94	[1.100]	11	1-147727-0
22.86	[.900]	25.40	[1.000]	10	147727-9
20.32	[.800]	22.86	[.900]	9	147727-8
17.78	[.700]	20.32	[.800]	8	147727-7
15.24	[.600]	17.78	[.700]	7	147727-6
12.70	[.500]	15.24	[.600]	6	147727-5
10.16	[.400]	12.70	[.500]	5	147727-4
7.62	[.300]	10.16	[.400]	4	147727-3
5.08	[.200]	7.62	[.300]	3	147727-2
2.54	[.100]	5.08	[.200]	2	147727-1

FINISH	B	A	NO OF POSN	PART NUMBER
THIS DRAWING IS A CONTROLLED DOCUMENT.				
DIMENSIONS: mm [INCHES]		TOLERANCES UNLESS OTHERWISE SPECIFIED:		DIN M. BINNER 22JAN01 CHK J. JOLSON 20MAY02 APVD J. JOLSON 20MAY02 NAME RECP. ASSY., MOD IV, SINGLE ROW, .100CL, VERTICAL BD. MOUNT, CLOSED ENTRY, DUAL ENTRY, SHORT PT OF CONTACT PRODUCT SPEC 108-25022 APPLICATION SPEC 114-25018 SIZE CAGE CODE DRAWING NO RESTRICTED TO A1 00779 147727 WEIGHT - CUSTOMER DRAWING SCALE 4:1 SHEET 1 of 1 REV J
0 PLC ± -	1 PLC ± -	2 PLC ± -	3 PLC ± 0.13 [.005]	4 PLC ± -
MATERIAL FINISH SEE TABLE				