

REVOLUTIONS		DATE	BY	APP'D
P	TR			
G1		14NOV2023	SP	PS

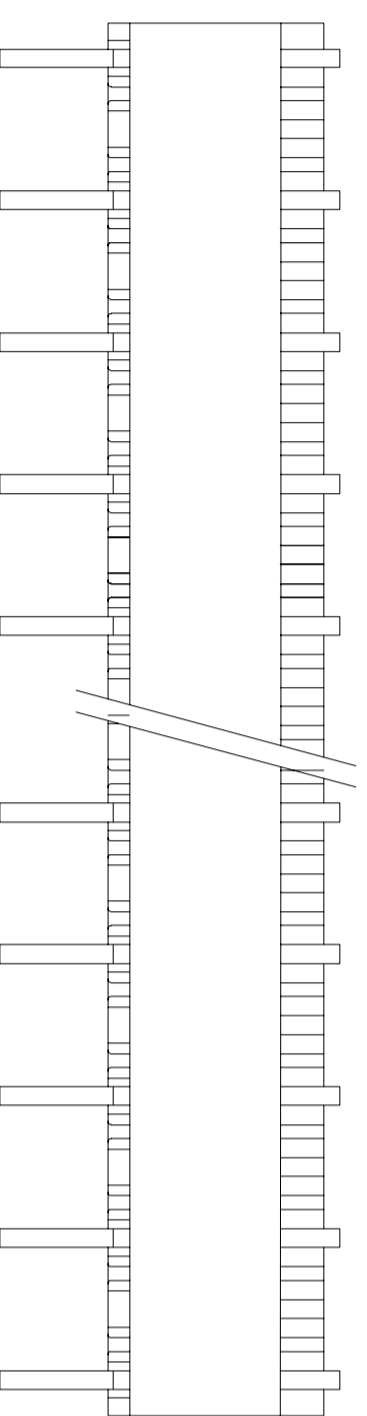
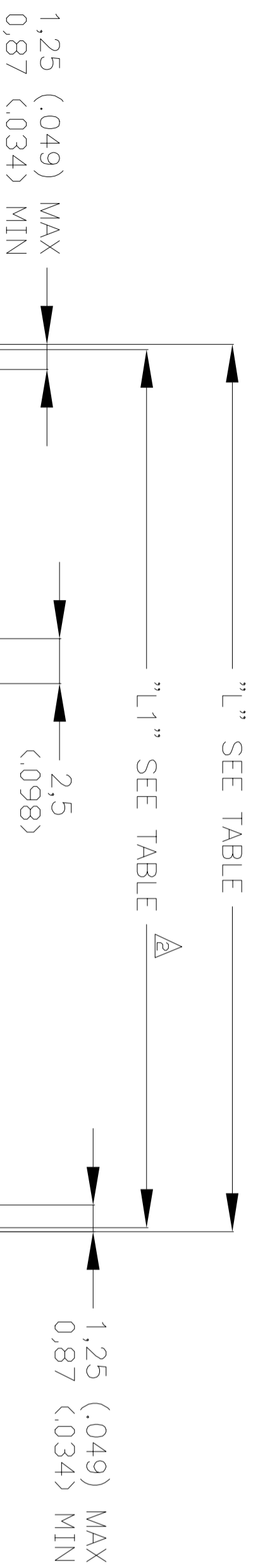

NOTES:

- 1. PREFERRED HOLE SIZE: 0.8 (0.031) 0.9 (0.035) 1.0 (0.039) DEPENDING ON NUMBER OF POSITIONS OF CONNECTOR FOR MORE INFORMATION PLEASE CONTACT PRODUCT-ENGINEERING DEPARTMENT.
- 2. ONLY FOR USE WITH G.M.T.'S HEADERS
- 3. OBSOLETE

mm	"1.1" MAX.		NUMBER OF LOADED POS.	ORDER NO.
	(inches)	mm		
7.3	0.287	7.6	3	163680-1
9.8	0.386	10.1	4	163680-2
12.3	0.484	12.6	5	163680-3
14.8	0.582	15.1	6	163680-4
17.3	0.681	17.6	7	163680-5
19.8	0.779	20.1	8	163680-6
22.3	0.878	22.6	9	163680-7
24.3	0.976	25.1	1	163680-8
27.8	1.075	27.6	11	163680-9
29.8	1.173	30.1	12	1-163680-1
32.3	1.271	32.6	13	1-163680-2
34.8	1.370	35.1	14	1-163680-3
37.3	1.468	37.6	15	1-163680-4
39.8	1.567	40.1	16	1-163680-5
42.3	1.665	42.6	17	1-163680-6
44.8	1.764	45.1	18	1-163680-7
47.3	1.862	47.6	19	1-163680-8
49.8	1.960	50.1	20	1-163680-9
		52.6	21	2-163680-0
		55.1	22	2-163680-1
		57.6	23	2-163680-2
		60.1	24	2-163680-3

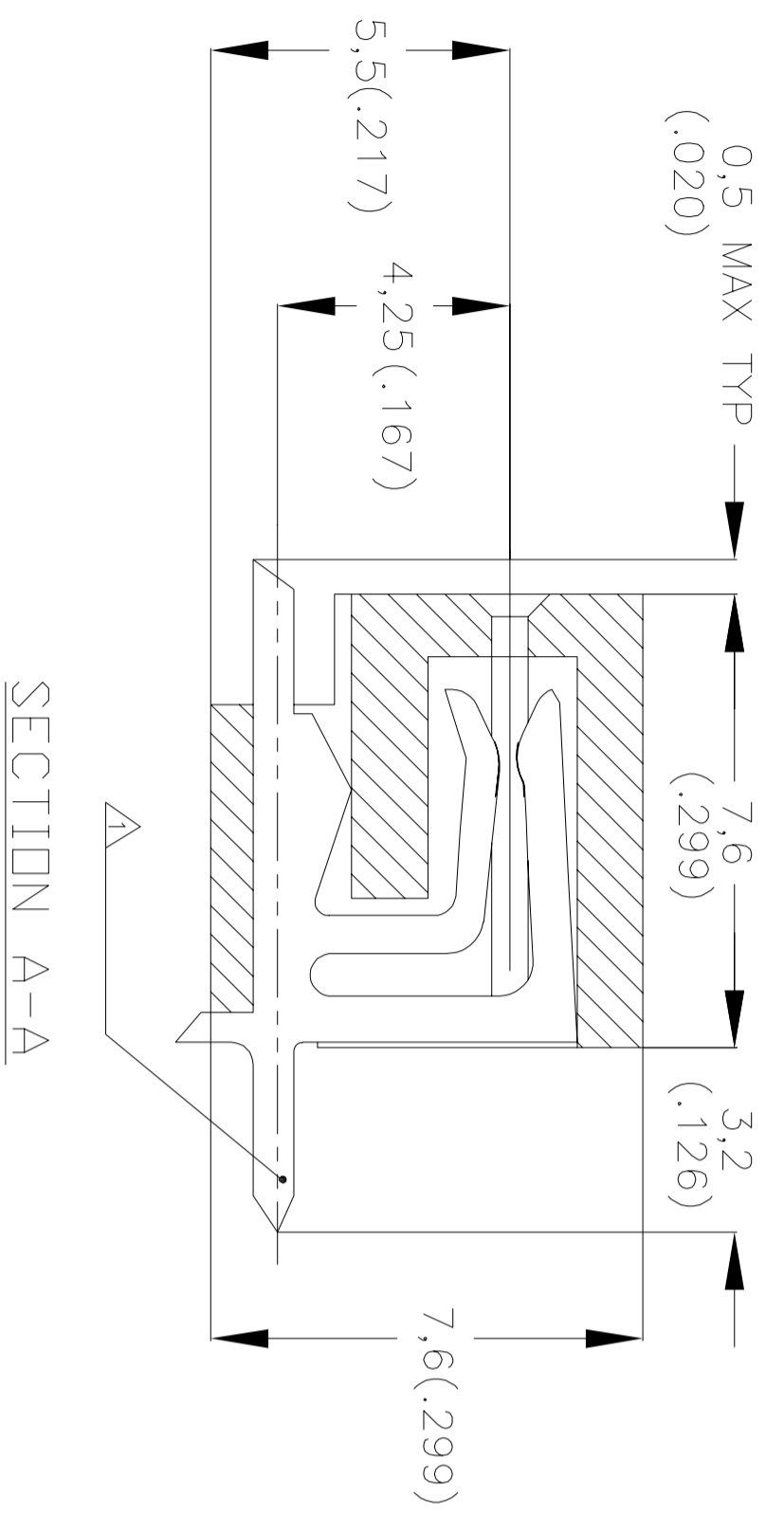

MATERIAL: HOUSING BLACK CRASTIN SK643FR
RECEPTACLES: BRASS; TIN PLATED OVER NICKEL-BARRIER

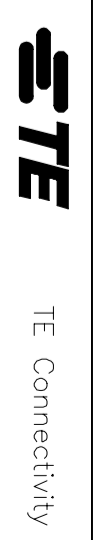

TE Connectivity

THIS DRAWING IS A CONTROLLED DOCUMENT.		DWG	16MAR1973	NAME	FEMALE CONN. FOR COMMERCIAL INTERCONNECTION SYSTEM 2.5mm PITCH, TOP ENTRY
DIMENSIONS: mm		CHK	16MAR1973	SIZE	A2
TOLERANCES UNLESS OTHERWISE SPECIFIED:		APP'D		Q&E CODE	00779
0 PLC	±			DRAWING NO	163680
1 PLC	±			SCALE	1:1
2 PLC	±			SHEET	1 of 1
3 PLC	±			REV	G1
4 PLC	±				
ANGLES	±				
FINISH	±				
MATERIAL		WEIGHT			
		CUSTOMER DRAWING			